

ENCLOSURE BACKBOX

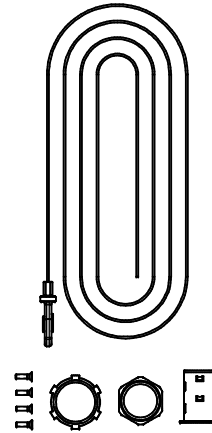

TRIM

**NOTE: Trim cutout specific to access point

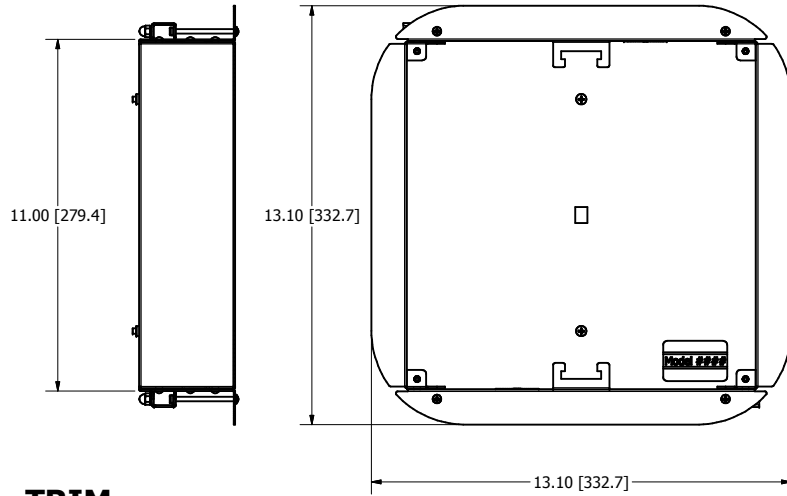
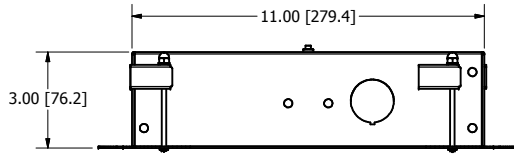
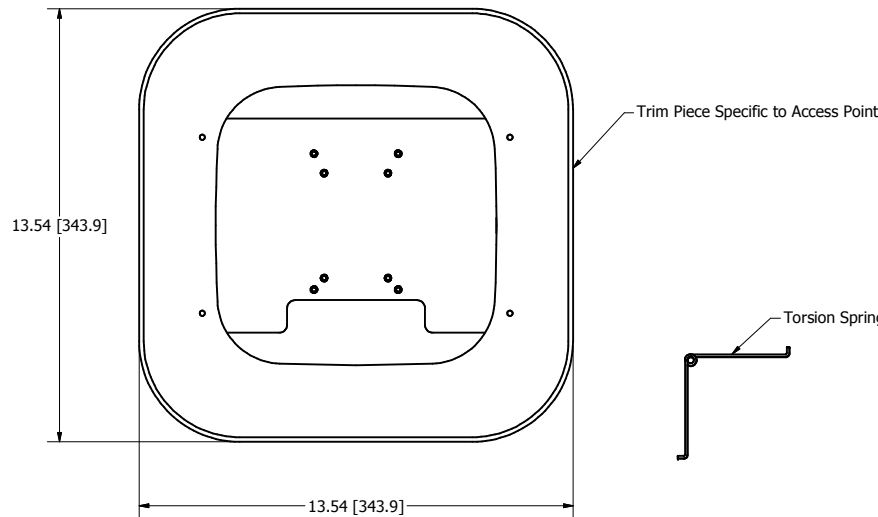

NOTE: All materials used in the construction of Oberon products must be RoHS compliant and meet RoHS2 Directive 2011/65/EU. Contact Oberon engineering if RoHS compliant materials are not available.

REVISION HISTORY				
ZONE	REV	DESCRIPTION	DATE	APPROVED
All	1	Released	11/12/2015	RLC
All	2	Added notes regarding trim and knockouts	2/18/2016	RLC
All	3	Added Speedlink	9/26/2018	RLC

CONFIGURATION TABLE		
Model Number	Trim Part Number	Access Point
1042-ANTMNT	37-104X-ANTMNT-S2	For Antennas or as Blank Cover
1042-ARAP215	37-104X-AP215-S2	Aruba AP215
1042-ARAP225	37-104X-AP225-S2	Aruba AP225
1042-ARAP305	37-104X-AP305-S2	Aruba AP305
1042-ARAP315	37-104X-ARAP315-S2	Aruba AP315
1042-ARAP325	37-104X-AP325-S2	Aruba AP325
1042-AP335	37-104X-AP335-S2	Aruba AP335 or AP345
1042-CCOAP	37-104X-CCOAP-S2	Cisco 2600, 2700, 3500, 3600, 3700 Series APs
1042-CCOAP3800	37-104X-CCOAP3800-S2	Cisco 2800, 3800 Series APs
1042-COAP4800	37-104X-COAP4800-S2	Cisco 4800 Series APs
1042-FL	37-104X-FL-S	General Purpose, Works With Most APs
1042-FLRD	37-104X-FLDR-S	General Purpose, Works With Most APs

ORDERING INFORMATION:

The backbox is common across all part numbers, access point specific trims are available for Cisco or Aruba Networks enterprise access points.

NOTES:

- Weight: 8 lbs.
- Material: 20 Gauge Galvanized Steel Backbox
20 Gauge Steel Trim, White Powder Coat

Includes:

- Fire Foam Grommet
- Conduit Fittings
- Installation Hardware Specific to Access Point
- Caddy Speedlink P/N SLD15L3 - 3 Meters Long

UL Listed - File Number E348543

DRAWN	11/12/2015	Oberon, Inc. - 1315 S. Allen St. - State College, PA 16801	
CHECKED	11/12/2015	TITLE	
RLC		Model 1042-XX	
QA		SIZE	DWG NO
MFG	11/12/2015	C	1042 Series
RLC		SCALE	REV 3
APPROVED	11/12/2015		
RLC			
TOLERANCE:	.0 = +/- .030		
	.00 = +/- .015		
	.000 = +/- .005		