

## NetWaySP8WP

### 8-port PoE+ Outdoor Hardened Switch

#### Description

Altronix NetWaySP8WP PoE+ Outdoor Hardened Switch provides two (2) 1Gb SFP (Fiber) ports and eight (8) PoE+ (30W) or two (2) Hi-PoE (60W) ports, passing data for PoE/PoE+/Hi-PoE compliant devices. Cameras/edge devices may be located up to 100m from the unit. Embedded LINQ Technology allows you to monitor, control, and report power and diagnostics from anywhere.



NetWaySP8WP

#### Key Features

- Two (2) Gigabit SFP ports.
- 115W total power:
  - Eight (8) PoE/PoE+ (up to 30W) ports or two (2) Hi-PoE (60W) ports.
- Two (2) 10/100/1000 Mbps ports.
- Six (6) 100 Mbps full duplex ports.
- IEEE 802.3at (30W), IEEE 802.3af (15W) compliant, or Hi-PoE (60W).
- PoE activity LED indicators.
- Automatic switch over to stand-by battery when AC fails.
- UL Listed in the U.S. and Canada.

- CE Approved.
- Lifetime Warranty / Made in the U.S.A.

#### Similar products:

- NetWaySP8WPX - 8-port PoE+ Outdoor Hardened Switch in NEMA 4/4X, IP66-11 enclosure which accommodates stand-by batteries.
- NetWaySP8WPN - 8-port Outdoor Hardened Switch only in NEMA 4/4X, IP66-11 enclosure.
- NetWaySP8X - 8-port PoE+ Indoor Hardened Switch.
- NetWaySP8PL - 8-port PoE+ Hardened Switch on Backplane.
- NetWaySP8B - 8-port PoE+ Switch board only.

#### Typical Application

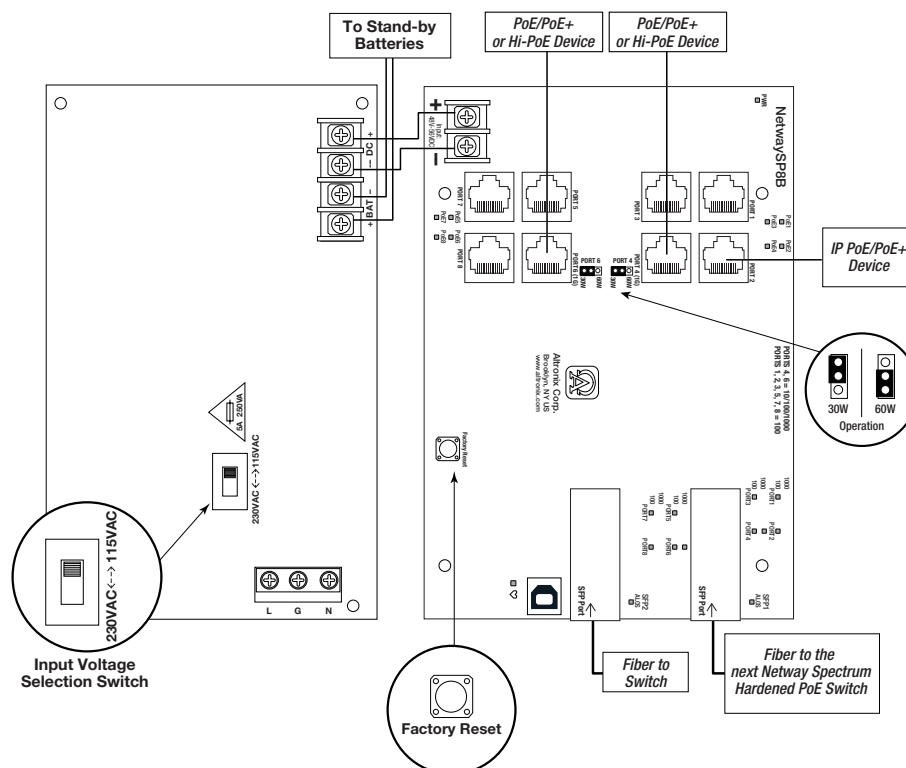

## NetWaySP8WP

### 8-port PoE+ Hardened Switch

#### Specifications

##### Input

Voltage	115VAC, 60Hz, 2.5A or 230VAC, 50/60Hz, 1.3A.
Fusing	5A/250V.

##### Power Output

Maximum Power	Eight (8) PoE+ (30W) ports or two (2) Hi-PoE (60W) ports. IEEE 802.3at (30W) and IEEE 802.3af (15W) compliant. 115W total power. Integral surge protection.
---------------	---

##### Fiber Ports:

Two (2) Gigabit SFP ports.

##### Ethernet Ports:

Six (6) 100 Mbps full duplex only (ports 1, 2, 3, 5, 7 and 8) and two (2) 10/100/1000 Mbps ports. Connectivity: RJ45, auto-crossover. Wire type: 4-pair CAT5 or better structured cable. Distance: up to 100m. Speed: 10/100/1000 Mbps, half/full duplex, auto negotiation.

##### Back-up Battery (not included)

Type	Sealed lead acid or gel type.
Failover	Upon AC loss, instantaneous.

##### Indicators (LED)

Individual PoE On LEDs for each port.  
Individual IP Link status, 10/100Base-T/active LEDs for each port.  
ALOS LED indicates fiber connection for SFP port.  
Heartbeat LED indicates proper operation of the unit.

##### LINQ Technology:

Remote network management allows for camera/device reset and monitoring.  
Provides local and/or remote access to critical information via LAN/WAN. Email and Windows Dashboard Alert notifications report real-time diagnostics.  
Event log tracks history.

##### Agency Listings

UL/cUL	UL60950-1 (Information Technology Equipment). UL60950-22 (Information Technology Equipment to be installed Outdoors).
CE	European Conformity.

##### Physical and Environmental

###### Enclosure Dimensions (H x W x D approx.):

13.31" x 11.31" x 5.59" (338.1mm x 287.3mm x 142mm).

NEMA 4/4X, IP66-11 Rated enclosure for outdoor use.

###### Product Weight / Shipping (approx.)

Product Weight:	10.5 lbs. (4.76 kg).
Shipping Weight:	11.9 lbs. (5.4 kg).

###### Temperature

Operating:	60W: -40°C to 75°C (-40°F to 167°F). 75W: -40°C to 70°C (-40°F to 158°F). 100W: -40°C to 55°C (-40°F to 131°F). 115W: -40°C to 45°C (-40°F to 113°F).
Storage:	-40°C to 85°C (-40°F to 185°F).

Relative Humidity: 85% +/-5%

BTU/Hr. (approx.): 61 BTU/Hr.

Operating Altitude: -304.8 to 2,000m.

#### Accessories



##### NetWaySP1A - Ethernet over Fiber Media Converter/Repeater

*For Applications requiring an additional SFP (Fiber) Port*

NetWaySP1A PoE powered media converter/repeater converts 10/100/1000 Mbps to Fiber (1000Base-X/SX/LX).



##### P1MM and P1SM10 - SFP Modules

Altronix P1MM and P1SM10 are hot-pluggable SFP fiber transceiver modules and are readily usable with all Altronix Spectrum fiber optic equipment for 1G transmission rates. The P1MM is to be used with Multi-Mode Fiber for distances up to 550m. The P1SM10 is to be used with Single-Mode Fiber for distances up to 10Km.

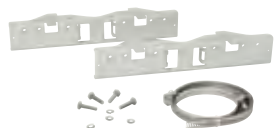

##### PMK1 Pole Mount Kit (order separately)

PMK1 pole mount kit is designed to simplify installation of outdoor units. It accommodates 2"- 8"(diameter) poles.