



SmartBalance, recessed

RC480B LED35S/840 PSD W60L60 VPC PIP

SmartBalance module 600 - LED Module, system flux 3500 lm - 840 neutral white - Power supply unit with DALI interface - Width 0.60 m, length 0.60 m - Visible profile ceiling version - Push-in connector and pull relief

Many people are keen to apply recessed luminaires with a surface of light as an alternative to louver-type solutions. At the same time they expect the luminaires to be office norm-compliant as well as highly energy-efficient. Meeting all relevant office norms, SmartBalance recessed is the next step in surface-of-light recessed luminaires for the specification market. Thanks to state-of-the-art LED technology it not only offers increased energy efficiency compared with fluorescent, but is also visually appealing without being intrusive. For those looking for an exciting design element there are versions with inner masking. SmartBalance is also available in surface-mounted, suspended and free floor-standing versions.

Product data

General Information		Emergency lighting	
Number of light sources	1 [1 pc]	Emergency lighting	No [-]
Lamp family code	LED35S [LED Module, system flux 3500 lm]	Embedded control	No [-]
Light source colour	840 neutral white	Control interface	DALI
Light source replaceable	No	Connection	Push-in connector and pull relief
Number of gear units	1 unit	Cable	-
Driver/power unit/transformer	PSD [Power supply unit with DALI interface]	Protection class IEC	Safety class I
Driver included	Yes	Glow-wire test	Temperature 650 °C, duration 5 s
Optic type	No [-]	Flammability mark	F [For mounting on normally flammable surfaces]
Optical element	No [-]	CE mark	CE mark
Optical cover/lens type	AC-MLO [Acrylate micro-lens optic]	ENEC mark	ENEC plus mark
Luminaire light beam spread	130°	UL mark	No
		Warranty period	5 years

SmartBalance, recessed

Constant light output	No
Number of products on MCB	20
RoHS mark	RoHS mark
Product Family Code	RC480B [SmartBalance module 600]

Operating and Electrical

Input voltage	220-240 V
Input frequency	50 to 60 Hz
Control signal voltage	0-16 V DC DALI
Inrush current	48 A
Inrush time	1 ms
Power factor (min.)	0.9

Controls and Dimming

Dimmable	Yes
----------	-----

Mechanical and Housing

Geometry	Width 0.60 m, length 0.60 m
Housing configuration	VPC [Visible profile ceiling version]
Housing material	Steel
Reflector material	Polycarbonate
Optic material	-
Optical cover/lens material	Acrylate
Fixation material	-
Optical cover/lens finish	Textured
Overall length	597 mm
Overall width	597 mm
Overall height	136 mm

Approval and Application

Ingress protection code	IP20 [Finger-protected]
Mech. impact protection code	IK02 [0.2 J standard]

Initial Performance (IEC Compliant)

Initial luminous flux	3500 lm
-----------------------	---------

Luminous flux tolerance	+/-10%
Initial LED luminaire efficacy	123 lm/W
Init. Corr. colour temperature	4000 K
Init. colour rendering index	≥80
Initial chromaticity	(0.38, 0.38) SDCM <3
Initial input power	28.5 W
Power consumption tolerance	+/-10%

Over Time Performance (IEC Compliant)

Driver failure rate at 5,000 hours	1 %
Median useful life L70B50	70000 h
Median useful life L80B50	50000 h
Median useful life L90B50	25000 h

Application Conditions

Ambient temperature range	+10 to +40 °C
Average ambient temperature	25 °C
Maximum dimming level	1%
Suitable for random switching	Yes (relates to presence/ movement detection and daylight harvesting)

Product Data

Full product code	871794310299000
Order product name	RC480B LED35S/840 PSD W60L60 VPC PIP
EAN/UPC – product	8717943102990
Order code	10299000
Numerator – quantity per pack	1
Numerator – packs per outer box	1
Material no. (12NC)	910502022903
Net weight (piece)	6.800 kg

Dimensional drawing

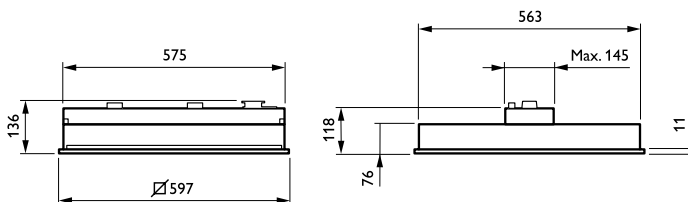

SmartBalance RC480B/RC482B

Photometric data

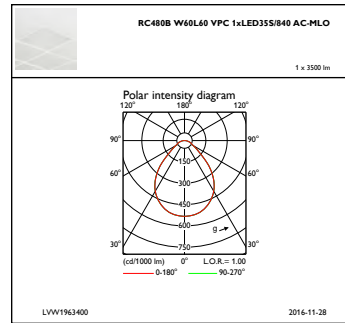
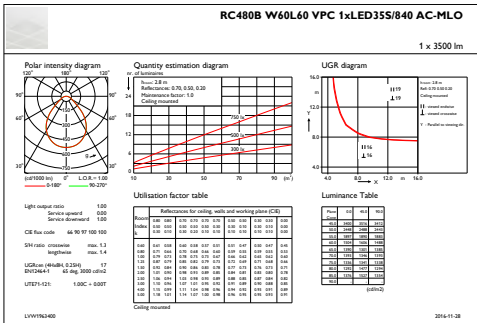

IFGU1_RC480BW60L60VPC1xLED35S840AC-MLO

IFPC1_RC480BW60L60VPC1xLED35S840AC-MLO

