



CoreLine Wall-mounted

WL120V LED12S/840 PSU WH

LED Module, system flux 1200 lm - 840 neutral white - Power supply unit - - White

Whether for a new building or renovation of an existing space, customers want lighting solutions that provide quality of light and substantial energy and maintenance savings. The new CoreLine Wall-mounted range of LED products can be used to replace traditional wall-mounted luminaires incorporating compact fluorescent lamps. The process of selecting, installing and maintaining is so easy – it's a simple switch.

Product data

General Information		Operating and Electrical	
Number of light sources	1 [1 pc]	Input voltage	220 to 240 V
Lamp family code	LED12S [LED Module, system flux 1200 lm]	Input frequency	50 to 60 Hz
Beam angle of light source	120 °	Inrush current	22 A
Light source colour	840 neutral white	Inrush time	0.32 ms
Light source replaceable	No	Power factor (min.)	0.9
Number of gear units	1 unit	Controls and Dimming	
Driver/power unit/transformer	PSU [Power supply unit]	Dimmable	No
Driver included	Yes	Mechanical and Housing	
Optic type	Symmetrical	Housing material	Composite materials
Luminaire light beam spread	180°	Reflector material	-
Emergency lighting	No [-]		
Connection	Push-in connector and pull relief		
Cable	-		
Protection class IEC	Safety class I		
Glow-wire test	Temperature 850 °C, duration 30 s		
Flammability mark	F [For mounting on normally flammable surfaces]		
CE mark	CE mark		
ENEC mark	-		
Constant light output	No		
Number of products on MCB	15		
RoHS mark	RoHS mark		

CoreLine Wall-mounted

Optic material	Polycarbonate
Optical cover/lens material	Polycarbonate
Fixation material	Polyamide
Optical cover/lens finish	Opal
Overall height	120 mm
Overall diameter	344 mm
Height	120 mm

Approval and Application

Ingress protection code	IP65 [Dust penetration-protected, jet-proof]
Mech. impact protection code	IK10 [20 J vandal-resistant]

Initial Performance (IEC Compliant)

Initial luminous flux	1200 lm
Luminous flux tolerance	+/-10%
Initial LED luminaire efficacy	67 lm/W
Init. Corr. colour temperature	4000 K
Init. colour rendering index	>80
Initial chromaticity	(0.37, 0.37) SDCM<3
Initial input power	18 W
Power consumption tolerance	+/-10%

Over Time Performance (IEC Compliant)

Driver failure rate at 5,000 hours	1 %
------------------------------------	-----

Median useful life L70B50	50000 h
Median useful life L80B50	30000 h
Median useful life L90B50	15000 h

Application Conditions

Ambient temperature range	-20 to +35 °C
Suitable for random switching	No

Product Data

Full product code	871869606635599
Order product name	WL120V LED12S/840 PSU WH
EAN/UPC – product	8718696066355
Order code	06635599
Local Code	WL120V12SRWH84
Numerator – quantity per pack	1
Numerator – packs per outer box	6
Material no. (12NC)	910503910012
Net weight (piece)	1.650 kg

Dimensional drawing

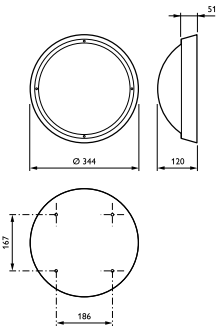

CoreLine Wall-mounted WL120V/WL121V

Photometric data

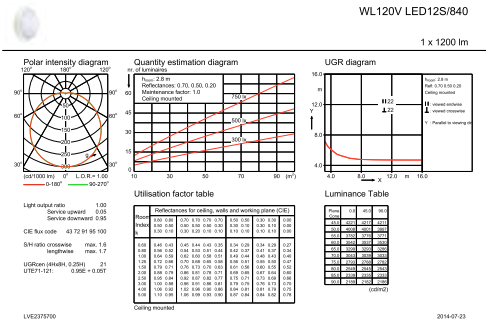

IFGU1_WL120V LED12S840.EPS

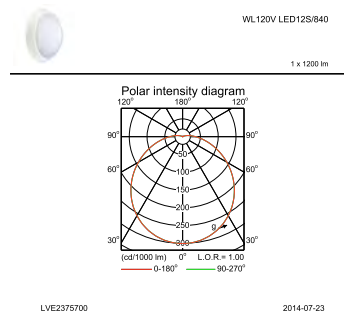

IFPC1_WL120V LED12S840.EPS

