

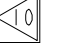

REV	DATE	DESCRIPTION	ECO	BY	C'H'K.
C	02/01/2016 09:30:00 AM	NOTE 10 UPDATED	41185	BSB	RG

CATALOG NO.	CONDUCTOR		BOLT SIZE	FIG. NO.	DIMENSIONS										INSTALLATION TOOLING (# CRIMPS)											
	CODE (AWG)	NAVY 			B	C	E	H	K DIA.	L	N	O.D.	T	Y	DIE INDEX	COLOR CODE	MECHANICAL			HYDRAULIC			DIELESS (# CRIMPS)	WIRE STRIP LENGTH		
					±.06	±.04	±.02	REF.	±.02	±.09	±.04	±.01	REF.	MIN.			MD7-34R MD6	OUR840 BCT500	Y2MR	Y34A	Y750 Y35, BAT35 Y39, BAT750	Y46			Y45	
YAZ4C2TC10E2	#4 AWG [----]	40	#10 [M5]	1	1.12 [28]	.50 [13]	----	----	.21 [5]	2.67 [68]	.25 [6]	.34 [9]	.09 [2]	1.02 [26]	8 OR 346	GRAY	W4CVT W4CRT (2)	W4CVT W4CRT (2)	GRAY (4)	A4CR A6CAB (2)	U4CRT U6CABT (2)	U4CRT U6CABT (2)	U4CRT U6CABT (2)	MECHANICAL: MY29-11 (1) HYDRAULIC: Y644, Y644M Y644MBH, Y1000 Y1000BH (1)	1-3/16	
YAZ4C2TC10E245				2	1.23 [31]	1.53 [39]	1.23 [31]	1.53 [39]	1.23 [31]	1.53 [39]	1.23 [31]	1.53 [39]	1.23 [31]	1.53 [39]	1.23 [31]	1.53 [39]	1.23 [31]	1.53 [39]	1.23 [31]	1.53 [39]	1.23 [31]	1.53 [39]	1.23 [31]			1.53 [39]
YAZ4C2TC10E290 				3	1.53 [39]	1.53 [39]	1.53 [39]	1.53 [39]	1.53 [39]	1.53 [39]	1.53 [39]	1.53 [39]	1.53 [39]	1.53 [39]	1.53 [39]	1.53 [39]	1.53 [39]	1.53 [39]	1.53 [39]	1.53 [39]	1.53 [39]	1.53 [39]	1.53 [39]			1.53 [39]
YAZ4C2TC14	#4 AWG [----]	40	1/4 [M6]	1	1.12 [28]	.50 [13]	----	.27 [7]	2.67 [68]	.31 [8]	.34 [9]	.09 [2]	1.09 [28]	8 OR 346	GRAY	W4CVT W4CRT (2)	W4CVT W4CRT (2)	GRAY (4)	A4CR A6CAB (2)	U4CRT U6CABT (2)	U4CRT U6CABT (2)	U4CRT U6CABT (2)	MECHANICAL: MY29-11 (1) HYDRAULIC: Y644, Y644M Y644MBH, Y1000 Y1000BH (1)	1-3/16		
YAZ4C2TC1445				2	1.23 [31]	1.53 [39]	1.23 [31]	1.53 [39]	1.23 [31]	1.53 [39]	1.23 [31]	1.53 [39]	1.23 [31]	1.53 [39]	1.23 [31]	1.53 [39]	1.23 [31]	1.53 [39]	1.23 [31]	1.53 [39]	1.23 [31]	1.53 [39]			1.23 [31]	1.53 [39]
YAZ4C2TC1490 				3	1.53 [39]	1.53 [39]	1.53 [39]	1.53 [39]	1.53 [39]	1.53 [39]	1.53 [39]	1.53 [39]	1.53 [39]	1.53 [39]	1.53 [39]	1.53 [39]	1.53 [39]	1.53 [39]	1.53 [39]	1.53 [39]	1.53 [39]	1.53 [39]			1.53 [39]	1.53 [39]
YAZ4C2TC14E2	#4 AWG [----]	40	1/4 [M6]	1	1.12 [28]	.50 [13]	----	.27 [7]	2.80 [71]	.31 [8]	.34 [9]	.09 [2]	1.09 [28]	8 OR 346	GRAY	W4CVT W4CRT (2)	W4CVT W4CRT (2)	GRAY (4)	A4CR A6CAB (2)	U4CRT U6CABT (2)	U4CRT U6CABT (2)	U4CRT U6CABT (2)	MECHANICAL: MY29-11 (1) HYDRAULIC: Y644, Y644M Y644MBH, Y1000 Y1000BH (1)	1-3/16		
YAZ4C2TC14E245				2	1.23 [31]	1.53 [39]	1.23 [31]	1.53 [39]	1.23 [31]	1.53 [39]	1.23 [31]	1.53 [39]	1.23 [31]	1.53 [39]	1.23 [31]	1.53 [39]	1.23 [31]	1.53 [39]	1.23 [31]	1.53 [39]	1.23 [31]	1.53 [39]			1.23 [31]	1.53 [39]
YAZ4C2TC14E290 				3	1.53 [39]	1.53 [39]	1.53 [39]	1.53 [39]	1.53 [39]	1.53 [39]	1.53 [39]	1.53 [39]	1.53 [39]	1.53 [39]	1.53 [39]	1.53 [39]	1.53 [39]	1.53 [39]	1.53 [39]	1.53 [39]	1.53 [39]	1.53 [39]			1.53 [39]	1.53 [39]

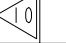
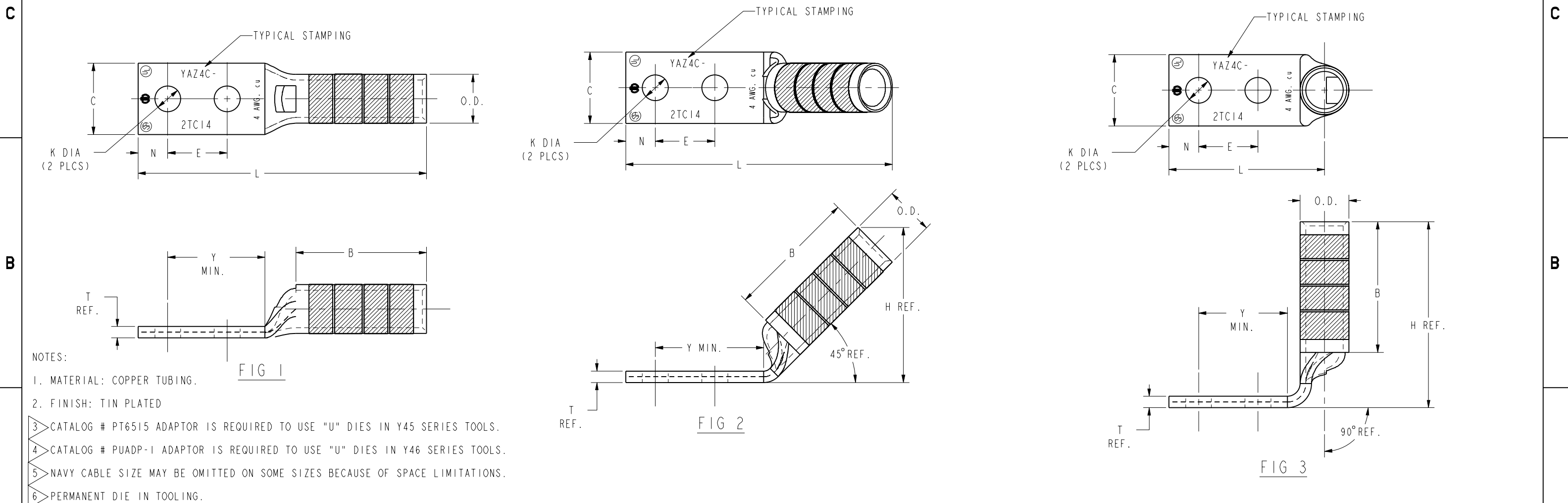

- NOTES:
1. MATERIAL: COPPER TUBING.
 2. FINISH: TIN PLATED
 3. CATALOG # PT6515 ADAPTOR IS REQUIRED TO USE "U" DIES IN Y45 SERIES TOOLS.
 4. CATALOG # PUADP-1 ADAPTOR IS REQUIRED TO USE "U" DIES IN Y46 SERIES TOOLS.
 5. NAVY CABLE SIZE MAY BE OMITTED ON SOME SIZES BECAUSE OF SPACE LIMITATIONS.
 6. PERMANENT DIE IN TOOLING.
 7. DIMENSIONS, METRIC WIRE, & METRIC BOLT SIZES IN BRACKETS [] ARE IN MILLIMETERS. DIMENSIONS ARE ROUNDED OFF TO THE NEAREST MILLIMETER, UNLESS OTHERWISE NOTED, AND ARE FOR REFERENCE ONLY.
 8. FOR USE BY CUSTOMERS THAT HAVE THIS HYPRESS™ NO NEW Y34A HYPRESS™ ARE BEING PROCESSED.
 9. BATTERY OPERATED TOOLS.
 10. THESE CATALOG NUMBERS CANNOT BE INSTALLED WITH Y45 TOOLING.

TO ORDER BURNDY® PRODUCTS CALL		HYLUG™	
UNITED STATES 1-800-346-4175 (LONDONDERRY, NH)		ITEM NO: N/A	CAT. NO: YAZ4C-2TC- (SEE TABLE)
CANADA: 1-800-361-6975 (QUEBEC) 1-800-387-6487 (ALL OTHER PROVINCES)		DRAWN BY: D. BOISVERT 11/11/98	CHECKER: K. HENRY 12/03/98
FOR PRODUCT INFO: http://www.burndy.com		DSN APPVL: B. MACDONALD 12/02/98	MFG APPVL: N/A
		GA APPVL: S. GARY 11/30/98	MKT APPVL: B. HARDGROVE 11/25/98
		PROD FAM: --	SCALE: 4:1
		PROJECT #: --	DRAWING NO: SE211915
		DOCUMENT TYPE: Sales	REV: C
		REL LEVEL: Released	SHEET 9 OF 36