

THIS COPY IS PROVIDED ON A RESTRICTED BASIS AND IS NOT TO BE USED IN ANY WAY DETRIMENTAL TO THE INTERESTS OF PANDUIT CORP.

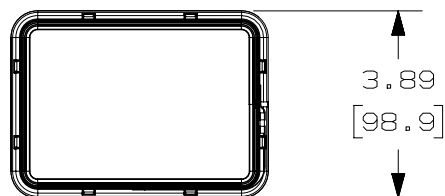

# NOTES:

1. FOR USE WITH NET-ACCESS CABINETS
2. USED TO SEAL OFF 3.5" X 5" CABINET TOP OPENINGS WHEN CABLES ARE ROUTED THROUGH THE TOP OF THE CABINET.
3. REQUIRES THAT PANDUIT PART NUMBER CTCN3X5B TO BE INSTALLED INTO 3.5" X 5" CABINET TOP OPENING PRIOR TO CTGN3X5 INSTALLATION.
4. FINISH COLOR: BLACK
5. DIMENSION IN PARENTHESES ARE IN METRIC

PANDUIT PART NUMBER	WEIGHT
CTGN3X5	.20 LBS/EACH 89.5 GRAMS/EACH

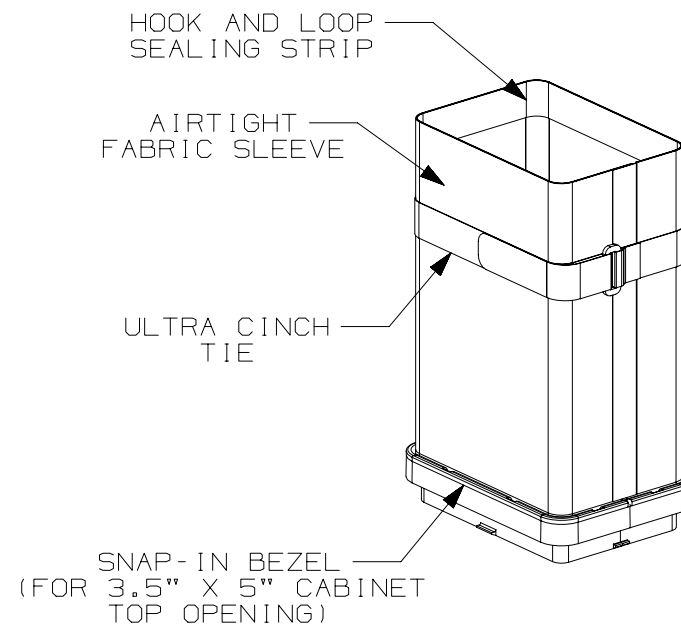
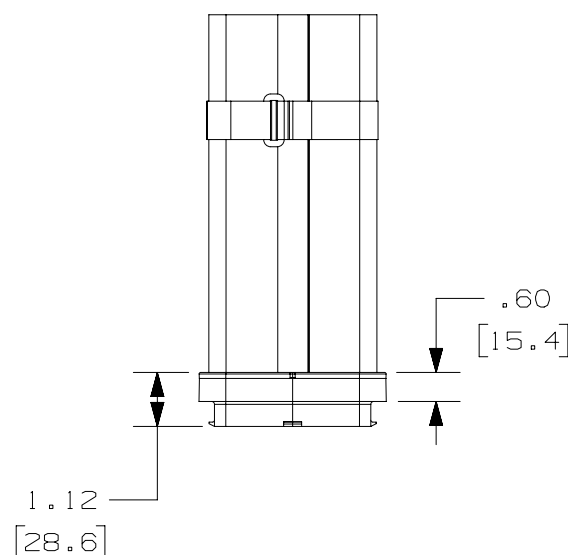
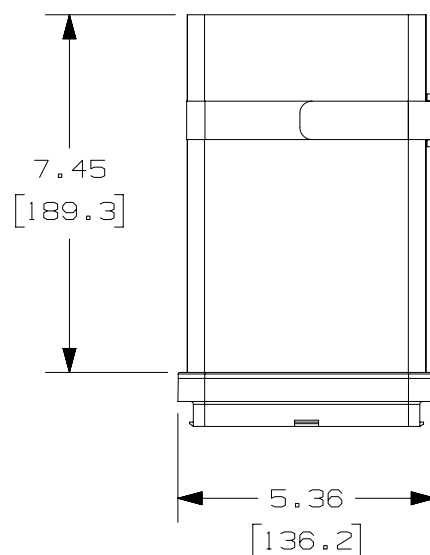

						TITLE	
						3.5" X 5" COOL BOOT CABINET TOP AIR SEALING FITTING (CTGN3X5)	
						CUSTOMER DRAWING	
						ITEM REVISION NAME	12D288AA/00
						DATASET FILE NAME	12D288AA_DC/00B CTGN3X5
						UNLESS OTHERWISE SPECIFIED, DIMENSIONAL TOLERANCES ARE: IN ( mm )	
						MATERIAL:	
						SEE NOTES ABOVE	
						DRAWING NUMBER:	
						12D288AA-DC	
1	02-27-13	SSP	DWR	RN	RELEASED TO PRODUCTION	12D288AA-DC	
R	08-20-12	SSP	DWR		DRAWING RELEASED		
REV	DATE	BY	CHK	APR	DESCRIPTION	ECN	