

THIS COPY IS PROVIDED ON A RESTRICTED BASIS AND IS NOT TO BE USED IN ANY WAY DETRIMENTAL TO THE INTERESTS OF PANDUIT CORP.

PART NUMBER	PACKAGE QTY.
PSL - CB	1
PSL - CB - V	5

NOTES:

1. MILLIMETERS ARE SHOWN IN BRACKETS.

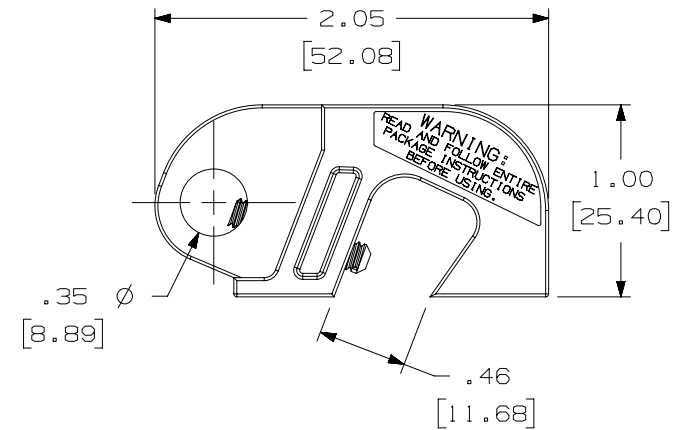
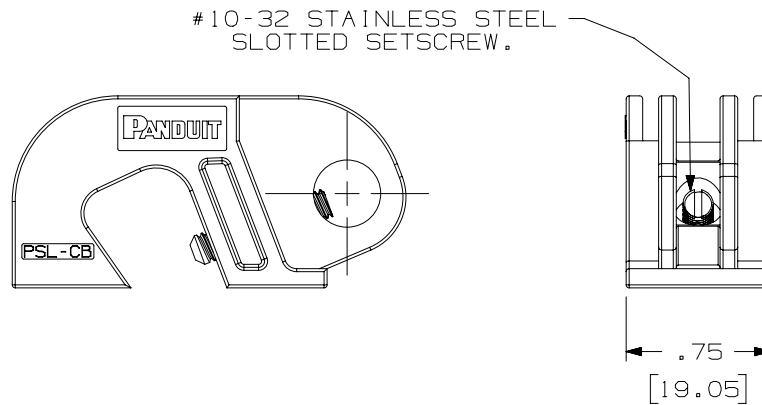

							TITLE PSL-CB, PSL-CB-V UNIVERSAL CIRCUIT BREAKER LOCKOUT CUSTOMER DRAWING					<div>PANDUIT</div>	
							ITEM REVISION NAME I00550BA/04						
							DATASET FILE NAME I00550BA_DC_C10158/04D					<div>MATERIAL: RED NYLON</div> <div>DRAWING NUMBER: C10158</div>	
3	11/5/14	RVU	MJPF	MSAD	REMOVE PSL-CBG FROM TITLE.	GAECN02362	UNLESS OTHERWISE SPECIFIED, DIMENSIONAL TOLERANCES ARE: IN [mm] .x ± .1 [2.54] .xxx ± .025 [.635] .xx ± .05 [1.27] ANGLES ± 5 ° <div><div></div><div></div></div> THIRD ANGLE PROJECTION						
2	8/15/14	RVU	MJPF	MSAD	REMOVE PN, PSL-CBG.	GAECN02253							
1	5/8/14	RVU	MJPF	MSAD	CREATED NEW FINISHED GOOD PART NUMBER TABLE AND TITLE. MOVED PART NUMBER FROM TOP RIGHT TO LOWER LEFT.	GAECN01128							
R	11/25/03	RVU		DWY	DRAWING RELEASE.	3472							
REV	DATE	BY	CHK	APR	DESCRIPTION	ECN	DRAWN BY RVU	DATE 11/25/03	CHK DWY	SCALE NTS	SHT 1 OF 1		