

THIS COPY IS PROVIDED ON A RESTRICTED BASIS AND IS NOT TO BE USED IN ANY WAY DETRIMENTAL TO THE INTERESTS OF PANDUIT CORP.

HSTT 12 - 48 0 2

COLOR  
 BLANK = BLACK 5 = GREEN  
 1 = BROWN 6 = BLUE  
 2 = RED 10 = WHITE  
 3 = ORANGE 45 = YELLOW/GREEN  
 4 = YELLOW C = CLEAR

QUANTITY PER CARTON (48 IN ONLY)  
 0 = 25pcs.  
 5 = 5pcs.  
 2 = 2pcs.

LENGTH IN"  
 INCHES FEET:  
 .5 M=1000  
 1 D=500  
 48 T=200  
 C=100  
 L=50  
 Q=25

TUBING SIZE - EXPANDED I.D.

TT = THIN WALL  
 TTV = THIN WALL VW-1 RATED

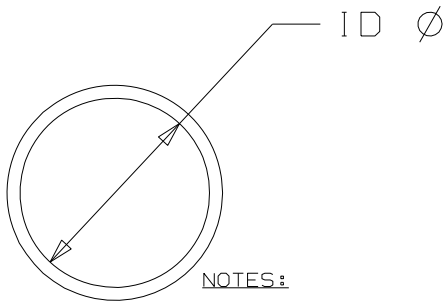

NOTES:

- SHRINK RATIO: 2:1
- MATERIAL: CROSSLINKED POLYOLEFIN
- "ALL WARRANTIES, INCLUDING MERCHANTABILITY AND FITNESS FOR A PARTICULAR PURPOSE, ARE EXCLUDED. (USER IS RESPONSIBLE TO DETERMINE SUITABILITY OF PRODUCT FOR INTENDED USE.)"
- REELS OF PRODUCT ARE ALLOWED TO HAVE SPLICES.

PACK CODE	M	D	T	C	L	Q
ALLOWED SPLICES	4	3	2	1	1	0

PANDUIT PART NUMBER	Min. Exp. I.D In. (mm)	Max. Rec. I.D In. (mm)	RECOVERED WALL In. (mm)
HSTT05	.046 (1.2)	.023 (.6)	.016±.003 (.406±.076)
HSTT06	.063 (1.6)	.031 (.8)	.017±.003 (.432±.076)
HSTT09	.093 (2.4)	.046 (1.2)	.020±.003 (.508±.076)
HSTT12	.125 (3.2)	.062 (1.6)	.020±.003 (.508±.076)
HSTT19	.187 (4.8)	.093 (2.4)	.020±.003 (.508±.076)
HSTT25	.250 (6.4)	.125 (3.2)	.025±.003 (.635±.076)
HSTT38	.375 (9.5)	.187 (4.8)	.025±.003 (.635±.076)
HSTT50	.500 (12.7)	.250 (6.4)	.025±.003 (.635±.076)
HSTT75	.750 (19.1)	.375 (9.5)	.030±.003 (.762±.076)
HSTT100	1.000 (25.4)	.500 (12.7)	.035±.005 (.889±.127)
HSTT150	1.500 (38.1)	.750 (19.1)	.040±.006 (1.016±.152)
HSTT200	2.000 (50.8)	1.000 (25.4)	.045±.007 (1.143±.178)
HSTT300	3.000 (76.2)	1.500 (38.1)	.050±.008 (1.270±.203)
HSTT400	4.000 (101.6)	2.000 (50.8)	.055±.009 (1.397±.229)

REV	DATE	BY	CHK	DESCRIPTION	ECN	R	CUST	SUP
3	5/15/13	LEF	VJS	ADDED NOTE #4 ALLOWED SPLICES PER REEL LENGTH	GB0239KH	3	RAMI	
2	2/21/12	LEF		ADDED "CUSTOMER DRAWING" TO TITLE BLK REMOVED ALL TOLERANCES IN TITLE BLK	GB0239KH	2	RAMI	
1	10/5/11	LEF		ADD COLORS 1 & 3 CHANGE METRIC (19.0 TO 19.1)	GB0239KH	1	RAMI	

DIMENSIONS IN BRACKETS ARE METRIC [mm]

CAD FILENAME/LAYERS G03597HN\_DC\_G00239KH\_PB\_HSTT\_03

# PANDUIT

CORP. TINLEY PARK, ILLINOIS

## HSTT THIN WALL HEAT SHRINKABLE TUBING CUSTOMER DRAWING

UNLESS OTHERWISE SPECIFIED, DIMENSIONAL TOLERANCES ARE:  
 (.X) \_\_\_\_\_ (.XXX) \_\_\_\_\_  
 (.XX) \_\_\_\_\_ ANGLES \_\_\_\_\_

UNLESS OTHERWISE SPECIFIED, ALL DIMENSIONS ARE GIVEN IN INCHES, THIRD ANGLE PROJECTION.

DRAWN BY LGRAVITT MAT'L: SEE NOTES

DATE 5/12/03

CHK'D

SCALE NONE

DRAWING NO. GB0239KH DWG SIZE A