

2

1

THIS COPY IS PROVIDED ON A RESTRICTED BASIS AND IS NOT TO BE USED IN ANY WAY DETRIMENTAL TO THE INTERESTS OF PANDUIT CORP.

PANDUIT P/N	WEIGHT
CMSVC**Y	.40 LB/10 PCS (181.3 g/10 PCS)

NOTES:

1. SEE CURRENT CATALOG FOR ADDITIONAL PART NUMBER SUFFIXES TO INDICATE COLOR AND OR PACKAGE QUANTITY.
2. SEE CATALOG FOR COMPLETE LIST OF PARTS APPLICABLE FOR USE WITH THIS PART.
3. DIMENSIONS IN [] ARE IN METRIC.
4. PART INCLUDES:
 - 1- MODULE BASE
 - 1- S-VIDEO COUPLER (ASSEMBLED TO MODULE BASE)

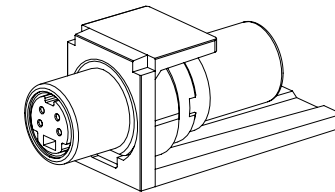
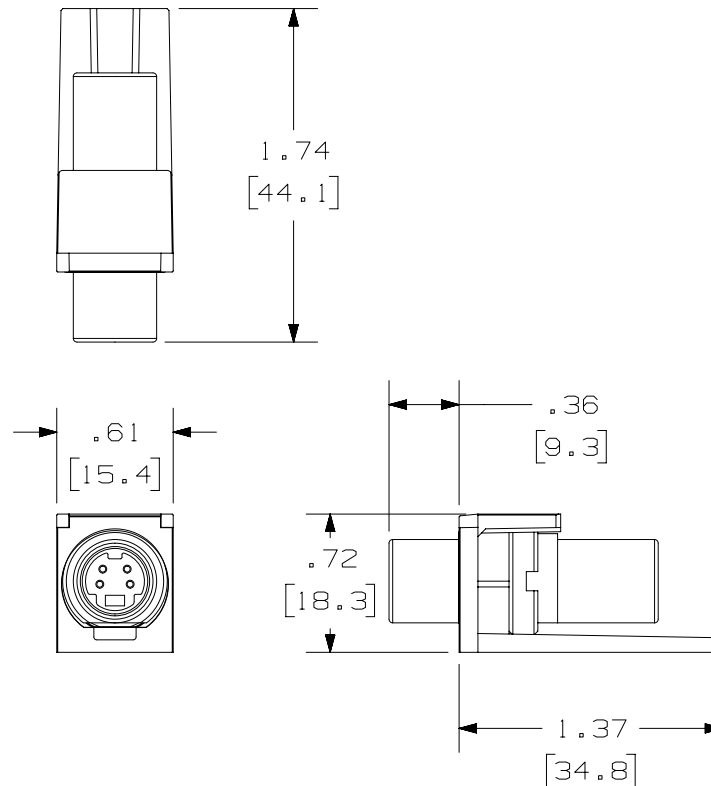

PART NUMBER		CMSVC**Y	
TITLE			
MINI-COM S-VIDEO COUPLER MODULE			
CUSTOMER DRAWING			
ITEM REVISION NAME		M02479HC/01	
DATASET FILE NAME		M02479HC_DC187/00A	
UNLESS OTHERWISE SPECIFIED, DIMENSIONAL TOLERANCES ARE: IN [mm]		PANDUIT MATERIAL: MODULE: ABS COUPLER: NICKEL PLATED	
.X ± .XX ± .03 [.8] .XXX ± .010 [.3] ANGLES ±			
THIRD ANGLE PROJECTION		DRAWING NUMBER:	
		02479-187	
DRAWN BY	DATE	CHK	SCALE
JSP	3-18-06	MJD	NONE
SHT 1 OF 1			SIZE
			A

REV	DATE	BY	CHK	APR	DESCRIPTION	ECN
1	5/6/14	JSP	REFR	MMR	A. REVISED DRAWING TITLE BLOCK.	02479-187
R	3-18-06	JSP	MJD	MJD	RELEASED TO PRODUCTION	02479-187

2

1

D10100DA/14