



Traffic Signs

Post traffic signs to safely control and regulate the flow of vehicles and pedestrians.

- Constructed of heavy-duty, 0.080" aluminum, rustproof to withstand weather conditions
- Reflective face for added bounce-back light visibility from headlights and other light sources
- Abrasion-resistant face is also UV-resistant to prevent fading for years of outdoor exposure
- Top and bottom center holes for post- or fence-mount installation

Materials

Engineer-Grade Prismatic – Good choice for added visibility in low-light conditions. Type I

High-Intensity Prismatic – Better choice for greater visibility with 3X brighter than Engineer-Grade. Type III, IV, X

Stop Signs & Yield Signs



| Engineer-Grade Prismatic | High-Intensity Prismatic | Size |
|--------------------------|--------------------------|-----------|
| Part No. | Part No. | |
| PTS075 | PTS080 | 18" x 18" |
| PTS186 | PTS083 | 24" x 24" |
| PTS187 | PTS084 | 30" x 30" |
| PTS188 | PTS085 | 36" x 36" |



| Engineer-Grade Prismatic | High-Intensity Prismatic | Size |
|--------------------------|--------------------------|-----------|
| Part No. | Part No. | |
| PTS141 | PTS140 | 24" x 24" |
| PTS143 | PTS142 | 30" x 30" |
| PTS145 | PTS144 | 36" x 36" |

Speed Limit Signs



| Engineer-Grade Prismatic | | | | High-Intensity Prismatic | | | | Size |
|--------------------------|-------------------------|-------------------------|-------------------------|--------------------------|-------------------------|-------------------------|-------------------------|-----------|
| SPEED LIMIT 5 Part No. | SPEED LIMIT 10 Part No. | SPEED LIMIT 15 Part No. | SPEED LIMIT 20 Part No. | SPEED LIMIT 5 Part No. | SPEED LIMIT 10 Part No. | SPEED LIMIT 15 Part No. | SPEED LIMIT 20 Part No. | |
| PTS103 | PTS091 | PTS093 | PTS095 | PTS102 | PTS090 | PTS092 | PTS094 | 18" x 12" |
| PTS123 | PTS111 | PTS113 | PTS115 | PTS122 | PTS110 | PTS112 | PTS114 | 24" x 18" |

Parking Signs

Material – Engineer-Grade Prismatic

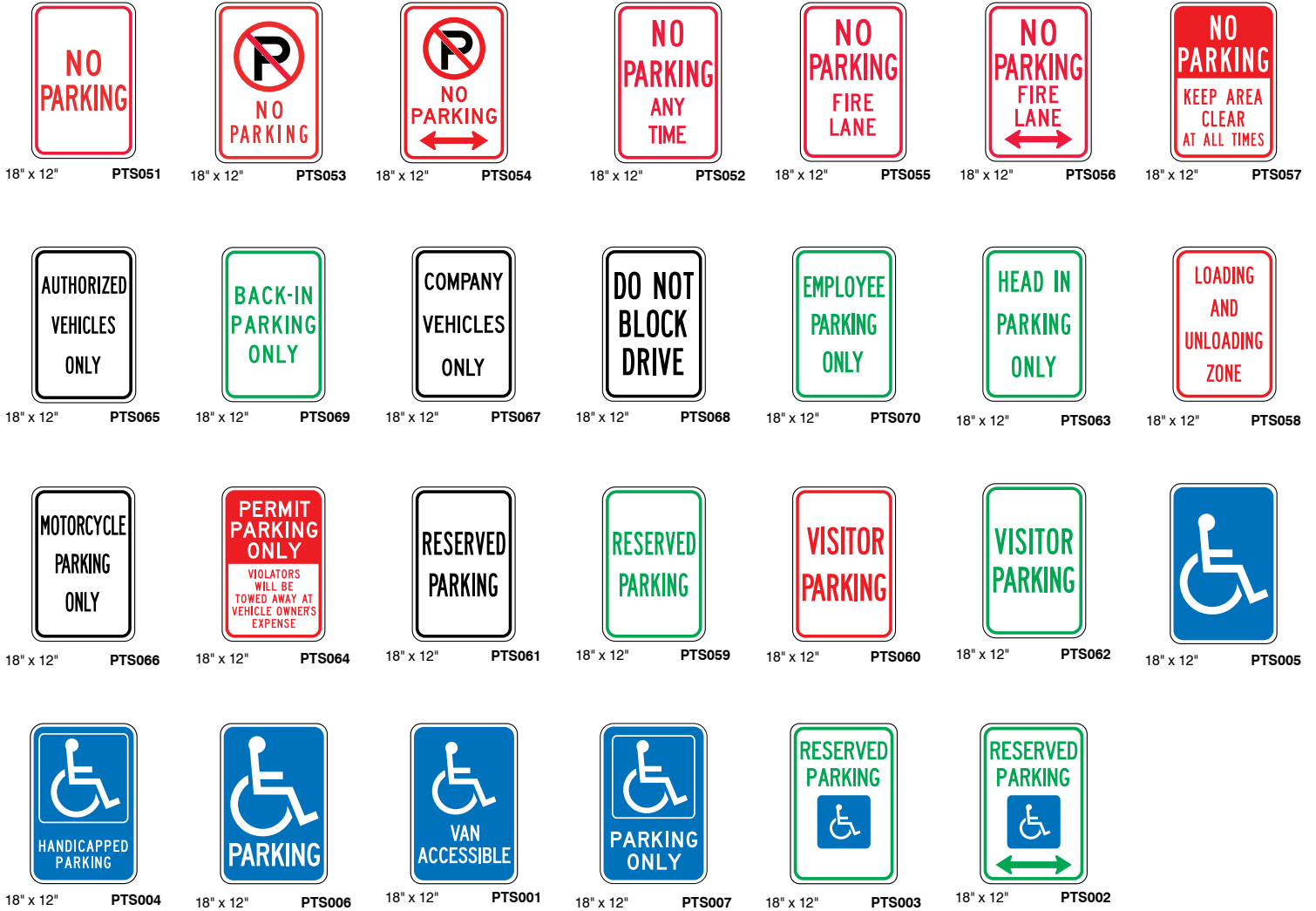

Traffic Direction Signs

Material – Engineer-Grade Prismatic

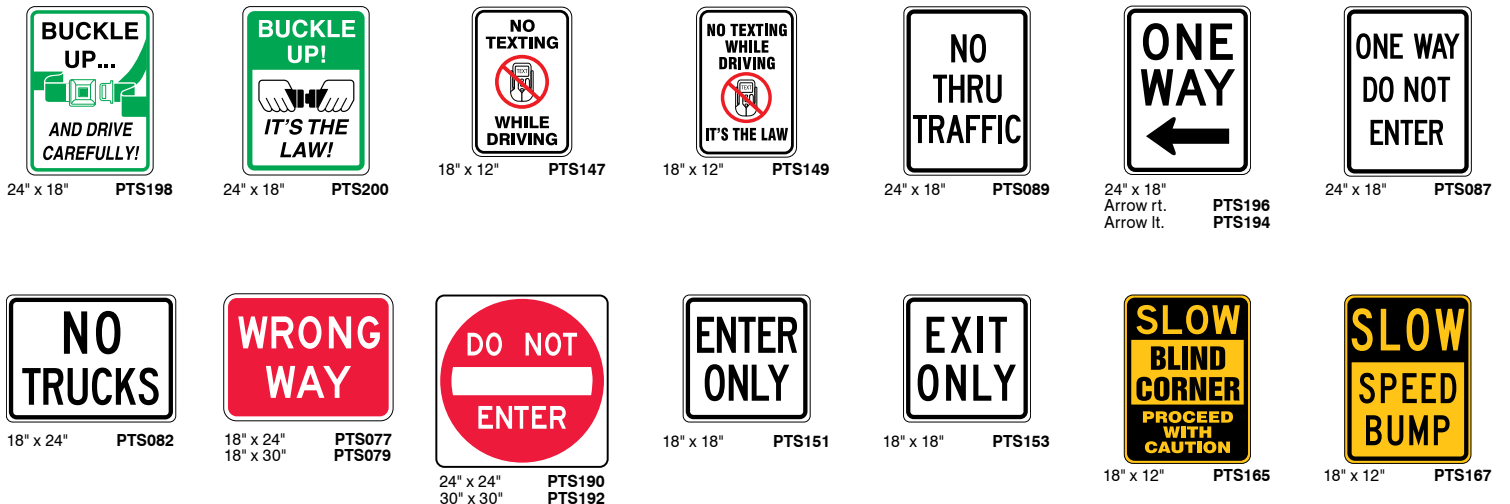

Single Spring Sign Stand



Economy-grade, roll-up stand for use in moderate winds and light traffic conditions.

- Opens quickly and easily to a wide, 66 1/2" x 43 1/2", stable footprint
- Folds to compact size, 6 1/2" x 8 1/2" x 25"
- Powder-coated, galvanized steel frames with non-slip rubber tips
- Weight: 22 lbs.
- For use with 36" or 48" diamond shaped roll-up construction signs with fiberglass cross-ribs (sold separately on next page)
- Meets Manual on Uniform Traffic Control Devices (MUTCD) specifications



NCHRP-350 compliant.

| Part No. | UOM |
|----------|------|
| PTS201 | Each |

Spring-Less Sign Stand



Single coil spring-loaded design adds stability and flexibility to stand up to wind loads and gusts.

- Leg levers for easy deployment – opens to a wide footprint of 67 1/2" x 42"
- Ergonomic design also allows users to lift up on legs to drop them into place
- Folds to compact size, 8" x 6" x 25 1/4"
- Powder-coated, galvanized steel frames with non-slip rubber tips
- Weight: 24 lbs.
- For use with 36" or 48" diamond shaped roll-up construction signs with fiberglass cross-ribs (sold separately on next page)
- Meets Manual on Uniform Traffic Control Devices (MUTCD) specifications



NCHRP-350 compliant.

| Part No. | UOM |
|----------|------|
| PTS202 | Each |

Roll-Up Construction Signs

Quickly set up highly visible signs for temporary warning of hazard and construction areas.

- Flexible fabric, quick and easy to setup and takedown – roll up for compact storage and portability
- Safety orange with contrasting black messages and symbols
- Cross-Ribs (sold separately) insert into four corner pockets, providing rigid support
- Overlay signs snap on to change directional or distance message

Materials:

Mesh Vinyl (V) - Non-reflective, ideal for daytime only applications

Fluorescent Vinyl (F) - Non-reflective, UV stable bright colored vinyl for daytime use only

Reflective Vinyl (R) - High-Intensity retro-reflective fiber reinforced nylon fabric, ideal for attention getting and low-light conditions

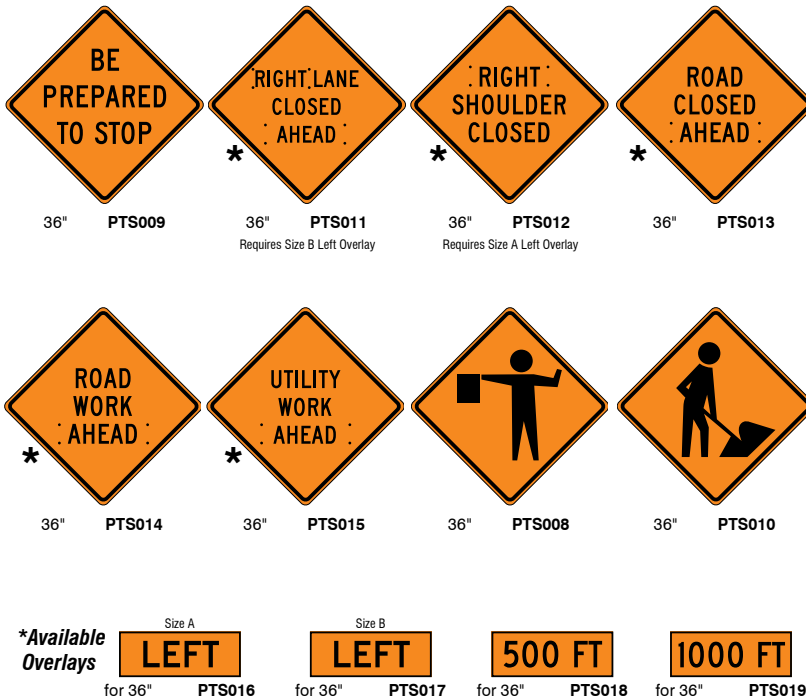

To Order : Add material & size code after part number.
 Example: Part No. PTS009 + Material/Size Code V36 = PTS009V36

| Material & Size Code | | Signs | Overlays* |
|----------------------|-----|-------|-----------|
| | | 36" | 36" |
| Mesh Vinyl | V36 | Each | Each |
| Fluorescent Vinyl | F36 | Each | Each |
| Reflective Vinyl | R36 | Each | Each |

Cautionary Signs

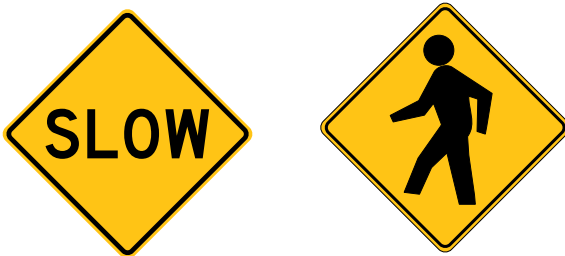

| Engineer-Grade Prismatic | | High-Intensity Prismatic | | Size |
|--------------------------|------------------|--------------------------|------------------|-----------|
| SLOW Part No. | PEDXING Part No. | SLOW Part No. | PEDXING Part No. | |
| PTS163 | PTS161 | PTS162 | PTS160 | 24" x 24" |
| — | PTS170 | — | PTS169 | 30" x 30" |

Cross-Ribs

Rigid support keeps roll-up signs deployed and visible.

- Constructed of durable fiberglass material
- Inserts into roll-up sign four-corner pockets
- For use with 36" Roll-Up Construction Signs

| Part No. | UOM |
|----------|------|
| PTS203 | Each |

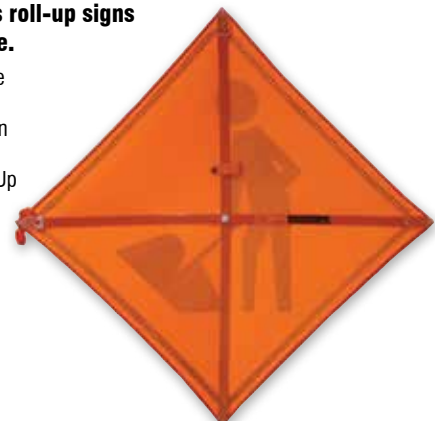

Steel U-Channel Posts

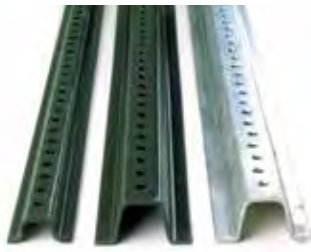

Everything you need to post-mount your sign.

- Available in 2 colors, green or galvanized
- Two lengths – 6-ft., 8-ft.
- Hardware set (sold separately) includes – 2 bolts, 2 nuts, 4 washers

Price per Each

| Length | Green Finish | | Galvanized Finish | |
|---------------------------------------|--------------|------|-------------------|------|
| | Part No. | UOM | Part No. | UOM |
| <i>Standard Weight – 1.12 lb/foot</i> | | | | |
| 6-ft. | PTS174 | Each | PTS175 | Each |
| <i>Heavy Weight – 2.00 lb/foot</i> | | | | |
| 6-ft. | PTS173 | Each | PTS172 | Each |
| 8-ft. | PTS176 | Each | PTS177 | Each |
| Description | | | Part No. | UOM |
| Hardware Set | | | PTS171 | Set |

Sign Mounting Brackets and Plate



Fence Mount Brackets

- Easily secure your sign to a chain link fence
- Rust-proof aluminum with mounting holes to attach sign through fence spaces

| Part No. | Fits Sign | UOM |
|----------|-----------|------|
| PTS183 | 12"H | Each |
| PTS184 | 18"H | Each |
| PTS185 | 24"H | Each |

Sign Mounting Plate

- Keep signs flat when mounting to U-Channel post
- Includes adaptor ringbolt, washer, plate and hex nut
- Two sets required per sign

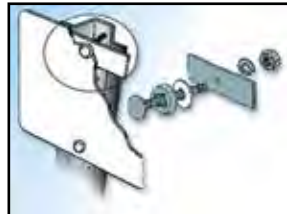

| Part No. | UOM |
|----------|-----|
| PTS182 | Set |

Fence Sign Holder Bracket



Post signs and warnings on chain link fences.

- Galvanized steel bracket
- Universal to work with nearly any size chain link fence
- Protects signs from damage by distributing pressure along the surface area of the bracket
- Two brackets required for post mounting
- Includes 5/16"-18 thread, 3/4" long stainless steel bolt and nylon washer – works well for use with 3/8" sign mounting holes
- Sized to fit most signs

| Part No. | UOM |
|----------|------|
| PBB0080 | Each |

Cast Iron Base and Steel Post

Mount signs with stable post and weighted base that can be moved as needed.

- Solid, heavyweight cast iron base available in 14" and 18" diameters
- 1 7/8" outside diameter x 48"H steel post can accommodate sign sizes up to 24" x 24"
- Sign mounting hardware included

| Part No. | Base Size | Weight | UOM |
|----------|-----------|---------|------|
| PTS179 | 14" dia. | 27 lbs. | Each |
| PTS180 | 18" dia. | 37 lbs. | Each |



Optional wheel attachment for easy tilting and moving – fits 14" base only.

| Part No. | UOM |
|----------|------|
| PTS178 | Each |



Sign sold separately

Portable Sign Stand

Ideal for temporary applications or crosswalks.

- 6-ft., white powder-coated steel post with pre-drilled mounting holes
- Base plate with locking pin, and a road-gripping, 40 lb., recycled rubber base
- When disassembled, bases nest for easy storage
- NCHRP-350 compliant

| Part No. | Description | UOM |
|----------|---------------------|------|
| PTS181* | Portable Sign Stand | Each |

*Sign sold separately

| Part No. | Description | UOM |
|----------|---------------|-----|
| PTS154 | Stop Sign Kit | Kit |

Includes – (1) Portable Sign Stand, (1) 24" x 24" Engineer-Grade Prismatic Aluminum Stop Sign, (1) Hardware Set



Blinker Signs

Maximum Visibility in any Environment.

- Flashing LED lights, combined with DG High-Prism sheeting, provide superior luminance and visibility
- Eco-friendly, 13 watt solar panel, 6VDC battery charger require no AC
- Low power allows for smaller panel and cleaner look
- LED automatically measures available light and adjusts the LED flash brightness accordingly
- Up to 30 day autonomy (flashing 24/7)
- Heavy-duty aluminum construction with fully enclosed wiring withstands harsh elements
- Attaches to 2 3/8" post with mounting brackets (sold separately)
- MUTCD-compliant for public roadway use

| Size | UOM |
|-----------|------|
| 30" x 30" | Each |



Security Stop Safety Signs



12" x 12"
B4221



12" x 12"
B4203



12" x 12"
B4209



12" x 12"
B4219



12" x 12"
B4201

Available Materials

Adhesive Vinyl (Each)
Polyester Laminated Vinyl (Each)

Codes

PVS
PLVS

Available Sizes

12" x 12"

Codes

1212

How to Order Signs:

1

Select Material Code:
PVS

2

Select Size Code:
1212

3

Select Sign Base Part Number:
B4201



4

Combine Codes in Specific Order
for Complete Part Number: PVS1212B4201

Speed Bump Signs

Engineer-Grade Prismatic – Good choice for added visibility in low-light conditions



24" x 24"
30" x 30"
PTS159
PTS158



18" x 12"
PTS157



18" x 12"
PTS167

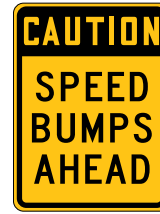

18" x 12"
PTS168

Non-Regulatory Traffic Signs

These signs are on non-reflective material. Intended for indoor or non-public roadway use.



12" x 12" 18" x 18" 24" x 24"
B4472



12" x 12" 18" x 18" 24" x 24"
B4481



12" x 12" 18" x 18"
B4477



12" x 12" 18" x 18"
B4939



12" x 12" 18" x 18"
B4933

Available Materials

Adhesive Vinyl (Each)
Polyester Laminated Vinyl (Each)
Polyethylene Plastic (Each)
Aluminum (Each)

Codes

PVS
PLVS
PRS
PAS

Available Sizes

12" x 12"
18" x 18"
24" x 24"

Codes

1212
1818
2424

How to Order Signs:

1

Select Material Code:
PVS

2

Select Size Code:
1212

3

Select Sign Base Part Number:
B4481



4

Combine Codes in Specific Order
for Complete Part Number: PVS1212B4481