

PowerSwitch™ DS30-AX 30Amp, 600V AC, Non-Fused, Enclosed, Safety Disconnect Switch

Watertight & Dust-tight for Industrial Applications
Providing AC Control for Horsepower Rated Motor Loads

New Compact, Easy-to-Install DS30-AX

A new front operated 30Amp non-fused switch, DS30-AX, has been added to the Leviton Safety Disconnect Switch product line.

Designed for easy installation, the compact DS30-AX features:

- Bottom-hinged enclosure, a Leviton exclusive for faster servicing
- One watertight hub
- 4 mounting feet
- 7 conduit entry points
- Integral ground plate
- One factory-installed auxiliary contact

PowerSwitch Enclosed Safety Disconnect Switch Product Line -- DS and EDSR Series

Leviton offers a full line of Enclosed Safety Disconnect Switches:

- The **DS Series** of 30Amp to 100Amp, fused and non-fused enclosed switches.
- The **EDSR Series** which brings a 30Amp, non-fused safety disconnect switch and NEMA locking receptacle in to the same enclosure for easier installation and maintenance.

Heavy Duty Enclosed Safety Disconnect Switches cut power to the circuit for equipment servicing and are designed to withstand higher short circuit currents than manual motor controllers. Watertight and dust-tight, PowerSwitch Safety Disconnect Switches are the ideal choice for process environments with particulate laden air, outdoor exposure, or requiring water washdowns.



POWERSWITCH DS30-AX FEATURES

UL 508 Listed

cUL per CSA Specification C22.2 No. 14

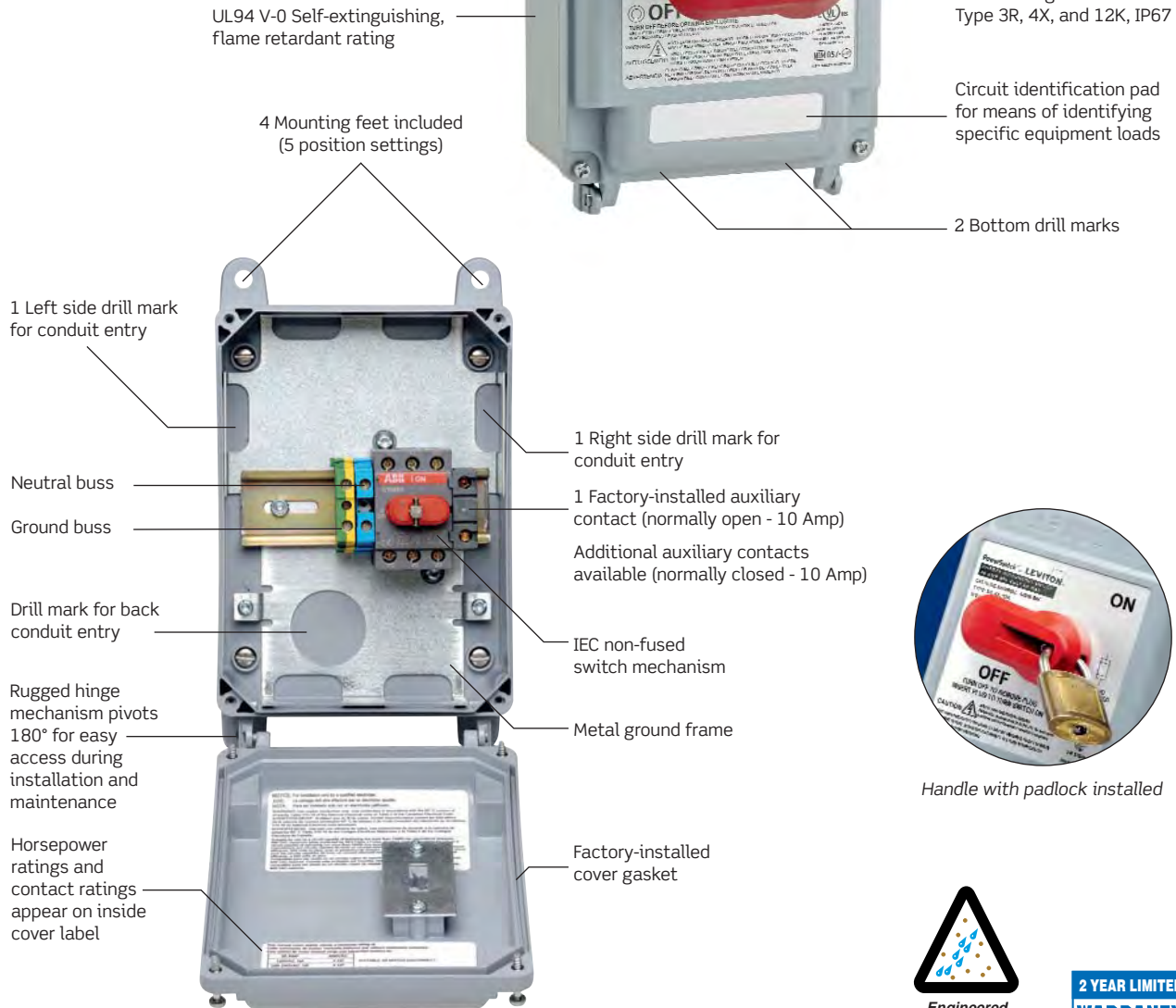
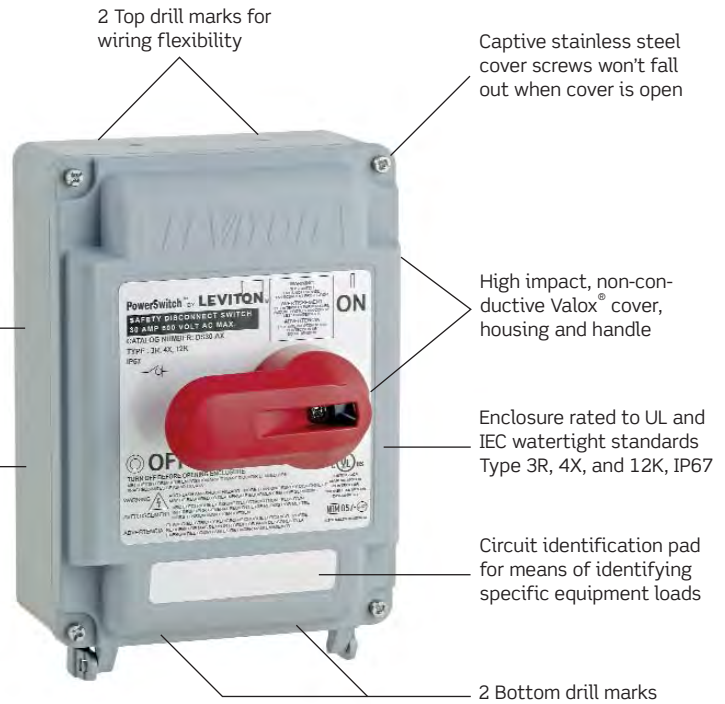

Handle with padlock installed



Engineered to IP67 Standards

2 YEAR LIMITED WARRANTY

Standards & Certifications

UL 508 Non-Fused	cULus	NOM	CE	IEC 947-3
#E63969	✓	✓	✓	✓

POWERSWITCH DISCONNECT SWITCH SPECIFICATIONS

UL 98 (Fused) & UL 508 (non-Fused) Listed
cUL per CSA Specification C22.2 No. 14



Meets 2002 NEC® Requirements
430.102 (A) and 430.102 (B)

Interrupting Ratings — RMS Symmetrical Amperes

AMPS	MAX VOLTAGE	CAT. NO. NON-FUSED	RMS SYMMETRICAL AMPS	CAT. NO. FUSED	RMS SYMMETRICAL AMPS
30	600V AC	DS30-AX / EDSR-23	10,000 Amp	DS30-FAX	200,000 Amp
60	600V AC	DS60-AX	50,000 Amp	DS60-FAX	200,000 Amp
100	600V AC	DS100-AX	50,000 Amp	-	-

Non-Fused are suitable for use on circuits capable of delivering not more than (see chart below for cat. no. and value) RMS symmetrical amperes

Fused, when protected by Class J fuses, 600V AC maximum, are suitable for use on circuits capable of delivering not more than (see chart below for catalog no. and value) RMS symmetrical amperes.

Electrical				Mechanical		Environmental	
Ground Path Integrity	Device	Current Applied	Duration	Mold Stress Relief	70°C for 7 hours	Flammability	V-2 or better per UL 94 or CSA 22.2 No 0.6; V-0 for watertight enclosure
	30 A	60 A	2 min	Knockout Test	Remains in place with 20 lb push	Rain (3R) per UL 50	Water spray @ 5 psi from all sides for 1 hr
	60 A	120 A	4 min	Crush	100 lb	Hosedown (4X) per UL 50	Water spray @ 65 gal/min for 5 minutes
Current Interrupting	Certified for current interrupting at full-rated current and voltage			Impact	1.2 lb steel ball dropped from 5 ft	Dust (12K) per UL 50	Cement Dust Circulated @1000 ft/minute for 5 minutes
	6000 operations at rated current and voltage (Power factor 0.75 - 0.80)			Cold Impact	Same as above, after conditioning to -35°C	Gasket Aging	70°C for 168 hours
Endurance	1000 V plus twice rated voltage for 1 minute			Strength of Insulating Base and Support	110% of specified tightening torque on terminal screws	UV Resistance	Exposed plastic materials are UV stabilized
Dielectric				Pullout	18 lb pull on internal wires	Operating Temperature	-40°C to +60°C (-40°F to +140°F)

Max. HP Ratings Per UL 508 Non-Fused Safety Disconnect Switches				Max. HP Ratings Per UL 508 Fused Safety Disconnect Switches		
VOLTS	DS30-AX / EDSR-23	DS60-AX	DS100-AX	VOLTS	DS30-FAX	DS60-FAX
120V AC	2	2	5	120V AC	2	NR
208V AC	5	20	25	208V AC	7.5	15
240V AC	5	10	15	240V AC	3	NR
480V AC	10	20	25	480V AC	7.5	NR
600V AC	NA	20	20	600V AC	20	NR
3Ø Y 120/208V AC	10	20	25	3Ø Y 120/208V AC	7.5	15
3Ø 240V AC	10	20	30	3Ø 240V AC	7.5	15
3Ø 480V AC	20	40	50	3Ø 480V AC	15	30
3Ø 600V AC	25	40	50	3Ø 600V AC	20	50

NR = Not Rated NA = Not Available

DS30-AX, 30AMP NON-FUSED DIMENSIONS

Watertight Safety Disconnect Switch

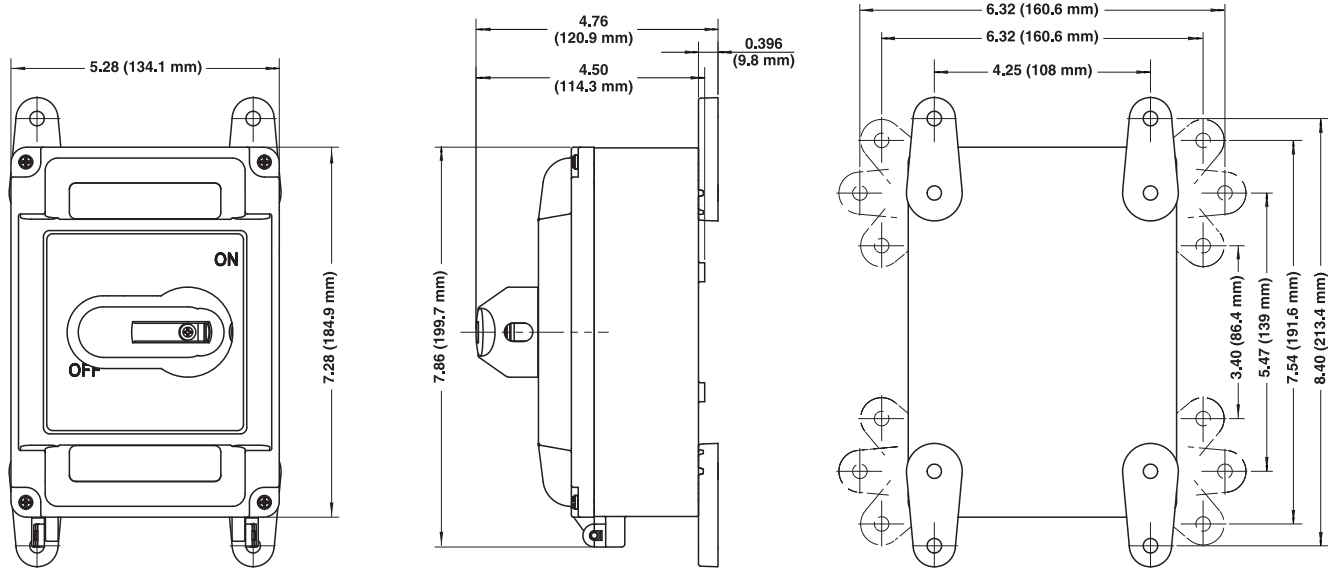

FOR THE COMPLETE POWERSWITCH SAFETY DISCONNECT SWITCH PRODUCT LINE AND MORE...



Industrial Switches for Processing Plants & Commercial Buildings

Specifications, Dimensional Diagrams, & Ordering Information for:

- Industrial grade AC toggle switches 15, 20, or 30Amp
 - Includes Locking and Key Locking
- Manual motor starter switches for single or 3-phase motor loads 30, 40, or 60Amp
- Motor starter switches available with or without enclosures
- Enclosed Safety Disconnect Switches 30, 60, or 100Amp, 600V AC; Fused or Non-Fused

Leviton Manufacturing Co., Inc.

59-25 Little Neck Parkway, Little Neck, NY 11362-2591

Telephone: 1-800-323-8920 • FAX: 1-800-832-9538 • Tech Line (8:30AM-7:30PM E.S.T. Monday-Friday): 1-800-824-3005

Leviton Manufacturing of Canada, Ltd.

165 Hymus Boulevard, Pointe Claire, Quebec H9R 1E9

Telephone: 1-800-469-7890 • FAX: 1-800-563-1853

Leviton S. de R.L. de C.V.

Lago Tana 43, Mexico DF, Mexico CP 11290

Tel. (+52) 55-5082-1040 • Fax: (+52) 55-5386-1797

www.leviton.com.mx

Visit our Website at: www.leviton.com/industrial email: industrial@leviton.com

© 2008 Leviton Manufacturing Co., Inc. All rights reserved. PowerSwitch is a trademark of Leviton Mfg. Co., Inc. Valox is a registered trademark of General Electric. Note: Features and specifications are subject to change.



LI-CI-0608-002