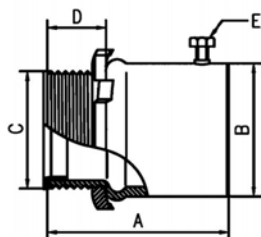

**EMT SET SCREW CONNECTORS****Uninsulated Set Screw Connector, Steel****B03**

Catalog #: 2004

APPLICATIONS

For use in dry locations to bond EMT conduit to a box or enclosure. RACO steel set screw connectors provide concrete-tight connections when taped.

PRODUCT FEATURES

All steel construction insures mechanical protection for the raceway
Tri-head screws may be installed using a slotted, Phillips, or Robertson head screwdriver
2-1/2 in. to 4 in. trade sizes are also UL listed for use on Rigid/IMC conduit, allowing for design and installation flexibility
All components are zinc electroplated for corrosion protection
1/2 in. to 1 in. trade sizes have one set screw, 1-1/4 in. to 4 in. trade sizes have two set screws
UPC bar coded fittings are individually polybagged with a preprinted UPC-A bar code, and packaged in pre-scored tear top cartons for an attractive presentation

UL LISTED

2-1/2" - 4" Standard 514B, File E195969, E195970

CULUS

1/2" - 2" Standard 514B, C22.2 # 18

COMPLIANCES

MSDS
www.hubbell-rtb.com/certifications/Hubbell-RACO_MSDS_for_WP_Boxes_and_Fittings_January_2015.pdf

GENERAL PRODUCT INFORMATION

Sub Class: Uninsulated
Trade Size: 1"

DRAWING DIMENSIONS

Dimension A: 1.75"
Dimension B: 1.194"
Dimension D: .391"
Dimension E: #12-28UNF

PACKAGING

Package Type: Carton
Std. Pkg.: 25
Ship Carton Qty.: 100
Product UPC-A Labeled: No
Weight (Lbs. Per/C): 19.8
Ship Carton Length (in.): 11.38
Ship Carton Width (in.): 9.00
Ship Carton Height (in.): 11.25
Pallet Qty: 4800
UPC Number: 050169020043