

CWR Series

CABLESAFE™ CABLING WALL MOUNT RACK

specifically designed for structured cabling, the CWR is a versatile system for mounting multiple patch panels and other voice/data equipment, where floor and wall space are at a premium

FEATURES:

- 26" width cabinet to allow for much needed space for patching. Comes standard with wide-face rackrail on left and right of cabinet.
- Four useable depths available: 15", 20", 24" and 30"
- Ships with front rackrail at 4" setback position to accommodate cable managers. Also accommodates rear rackrail for rear support and cable management.
- Swing open center section allows for easy front and rear access to equipment and cabling
- Includes an easily reversible left or right handswing locking / latching Plexi front door for added security and aesthetics. Solid and vented front doors also available.
- Engineered to facilitate passive thermal management- optional fan kit available when additional heat dissipation is required
- Ships fully assembled as left or right hand hinged to save installation time
- UL Listed in the US and Canada



shown with optional offset rackrail

SPECIFICATIONS:

EIA compliant 19" cabling wall mount rack shall be Middle Atlantic Products model # CWR-__-__-CAN (refer to chart). Overall dimensions shall be 26" W x __" H x __" D, with a useable depth of __ (refer to chart). Weight capacity shall be 200 lbs. Center section and back pan shall be 16-gauge steel, phosphate pre-treated and finished in a black textured powder coat. Rackrail shall be constructed of 11-gauge steel with tapped 12-24 mounting holes in universal EIA spacing with black powder coat finish. Rack shall include __ D-Rings for enhanced cable management (refer to chart). Rack shall have 1/2", 2" and 3" electrical knockouts on the top and bottom of the back pan. Rack shall be constructed to swing open for component cabling access, center section shall pivot for either left or right opening. Large opening on back pan shall have a 12-1/2" x 12-1/2" cutout for electrical pull-box. Top and bottom side vents will accommodate CWR-FKIT cooling kit. Rack shall be UL Listed in the US and Canada to the UL-2416 (NWIN) Category when used with optional bonding kit, model # PET-K-CWR. CWR shall be GREENGUARD Gold Certified. CWR shall be RoHS EU Directive 2011/65/EU compliant. CWR shall be manufactured by an ISO 9001 and ISO 14001 registered company. Rack shall be warrantied to be free from defects in materials or workmanship under normal use and conditions for the lifetime of the rack.

Customizable specification clips available at middleatlantic.com

OPTIONS:

- Fan kit shall be CWR-FKIT and shall feature 2 fans and displace 95 CFM of free air.
- Rear rail kit, 11-gauge, 10-32 threaded, sold in pairs, hardware included, shall be model # CWR-RRXX-CAN(XX= # of rackspaces).
- Off-set rail kit with D-Rings, 10-32 threaded, sold in pairs, hardware included, shall be model # CWR-OFRRXX-CAN (XX= # of rackspaces).
- Optional bonding kit for UL-2416 (NWIN) compliance shall be Middle Atlantic Products PET-K-CWR

EIA/TIA COMPLIANT



PRODUCT CERTIFIED FOR
LOW CHEMICAL EMISSIONS
UL.COM/GG
UL 2818

WHAT GREAT SYSTEMS ARE BUILT ON.™

A brand of legrand



Middle Atlantic Products
middleatlantic.com | middleatlantic.ca

96-01104/ rev e / 9-22-17

CWR Series

BASIC DIMENSIONS

TOP VIEW

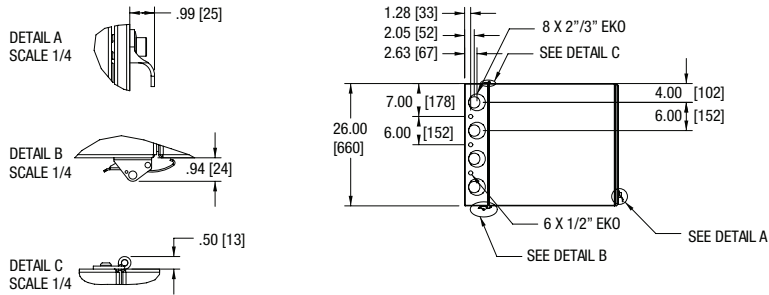

SIDE VIEW

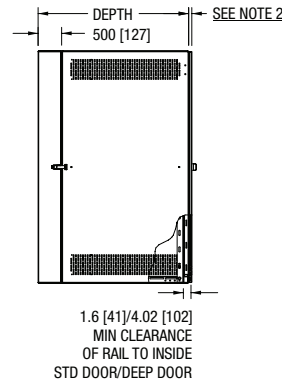

CENTER SECTION CLEARANCE

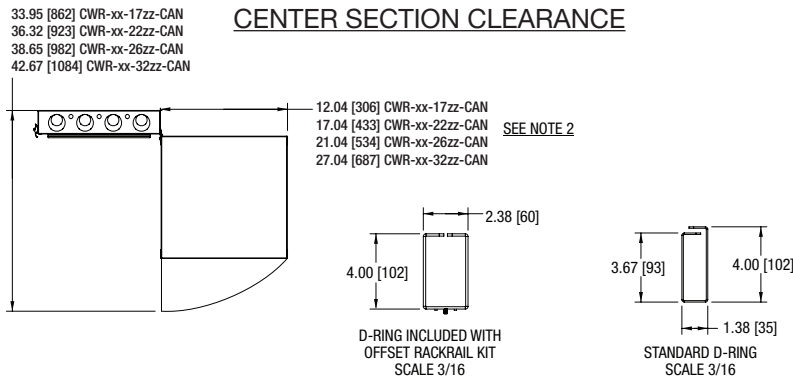

FRONT VIEW

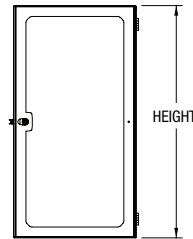

MOUNTING LOCATIONS

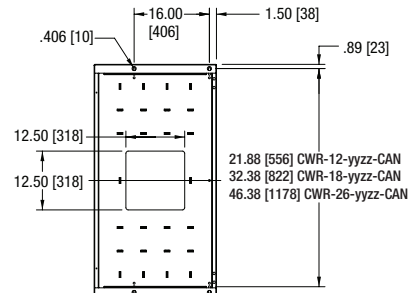

Part #	Overall Height	Racking Height	Depth (w/o door)	Useable Depth	Useable Height	D-Ring Qty.
CWR-12-17XX-CAN	24.88 (632)	21.00 (533)	17.00 (432)	15.00 (381)	12 RU	4
CWR-12-21XX4-CAN	24.88 (632)	21.00 (533)	17.00 (432)	15.00 (381)	12 RU	4
CWR-12-22XX-CAN	24.88 (632)	21.00 (533)	22.00 (559)	20.00 (508)	12 RU	4
CWR-12-26XX4-CAN	24.88 (632)	21.00 (533)	22.00 (559)	20.00 (508)	12 RU	4
CWR-12-26XX-CAN	24.88 (632)	21.00 (533)	26.00 (660)	24.00 (610)	12 RU	4
CWR-12-30XX4-CAN	24.88 (632)	21.00 (533)	26.00 (660)	24.00 (610)	12 RU	4
CWR-12-32XX-CAN	24.88 (632)	21.00 (533)	32.00 (813)	30.00 (762)	12 RU	4
CWR-12-36XX4-CAN	24.88 (632)	21.00 (533)	32.00 (813)	30.00 (762)	12 RU	4
CWR-18-17XX-CAN	35.38 (899)	31.50 (800)	17.00 (432)	15.00 (381)	18 RU	6
CWR-18-21XX4-CAN	35.38 (899)	31.50 (800)	17.00 (432)	15.00 (381)	18 RU	6
CWR-18-22XX-CAN	35.38 (899)	31.50 (800)	22.00 (559)	20.00 (508)	18 RU	6
CWR-18-26XX4-CAN	35.38 (899)	31.50 (800)	22.00 (559)	20.00 (508)	18 RU	6
CWR-18-26XX-CAN	35.38 (899)	31.50 (800)	26.00 (660)	24.00 (610)	18 RU	6
CWR-18-30XX4-CAN	35.38 (899)	31.50 (800)	26.00 (660)	24.00 (610)	18 RU	6
CWR-18-32XX-CAN	35.38 (899)	31.50 (800)	32.00 (813)	30.00 (762)	18 RU	6
CWR-18-36XX4-CAN	35.38 (899)	31.50 (800)	32.00 (813)	30.00 (762)	18 RU	6
CWR-26-17XX-CAN	49.38 (1254)	42.00 (1067)	17.00 (432)	15.00 (381)	26 RU	8
CWR-26-21XX4-CAN	49.38 (1254)	42.00 (1067)	17.00 (432)	15.00 (381)	26 RU	8
CWR-26-22XX-CAN	49.38 (1254)	42.00 (1067)	22.00 (559)	20.00 (508)	26 RU	8
CWR-26-26XX4-CAN	49.38 (1254)	42.00 (1067)	22.00 (559)	20.00 (508)	26 RU	8
CWR-26-26XX-CAN	49.38 (1254)	42.00 (1067)	26.00 (660)	24.00 (610)	26 RU	8
CWR-26-30XX4-CAN	49.38 (1254)	42.00 (1067)	26.00 (660)	24.00 (610)	26 RU	8
CWR-26-32XX-CAN	49.38 (1254)	42.00 (1067)	32.00 (813)	30.00 (762)	26 RU	8
CWR-26-36XX4-CAN	49.38 (1254)	42.00 (1067)	32.00 (813)	30.00 (762)	26 RU	8

Notes:

1. Replace 'XX' suffix with desired front door: PD- Plexi front door, SD- Solid front door, VD- Vented front door
2. Racks configured with standard front doors add .67" (17 mm) to overall depth. Racks configured with deep front doors ('XX4' suffix) add 4.06" (103mm) to overall depth.

WHAT GREAT SYSTEMS ARE BUILT ON.™

A brand of **legrand**

Middle Atlantic Products
 middleatlantic.com | middleatlantic.ca