

Interchangeable core conversion kits

It is easy to convert standard S Series locksets to accept Schlage full size interchangeable cores by changing the lever and adding the parts shown.

Interchangeable core components - options

- Lever, driver, plug, retainer*
- Lever only*
- Retainer
- Driver
- IC installation tool

* Specify design and finish.

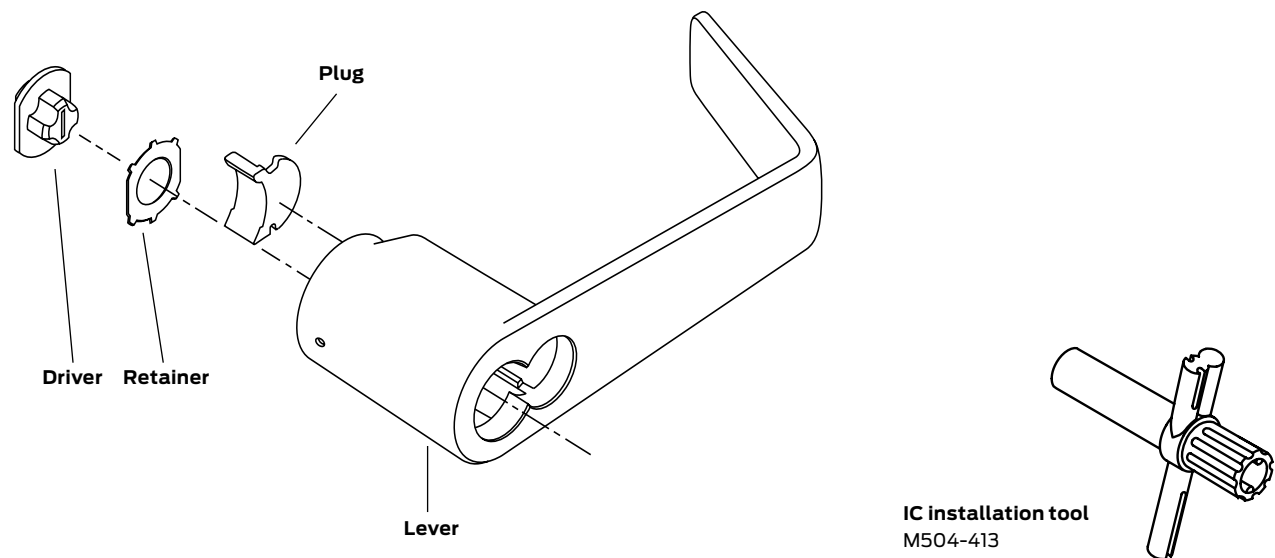

Interchangeable core 8

Schlage interchangeable core (IC) locksets allow immediate rekeying at the door simply by using the special control key to replace the core in seconds.

IC locksets are available in all designs except Flair.

Full size interchangeable cores can be integrated into any 5 or 6-pin Schlage key with no adverse effects on keying capacity.

To order complete locks with full size cores, change suffix from **PD** to **RD**. Example: S251**RD**. To order locks less core, change suffix to **JD**. To order with full size construction core, change suffix to **TD**.



All designs shown in 626 satin chrome

Cores, and IC cylinders and parts



Full size interchangeable cores - options

- 6-pin conventional (standard)
- Primus high security cylinder

Available in 606 and 626 finish only. Everest 29 S123 keyway standard for commercial; C keyway standard for residential.

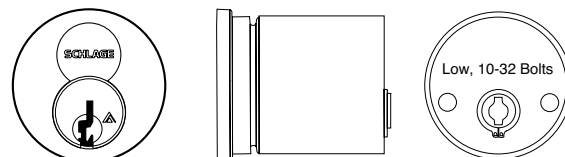

IC cylinders for deadbolt (top) - options

Tailpiece not included.

- Conventional core
- Primus core
- Primus XP core
- Housing less core

Available in 605, 606, 609, 612, 613, 625 and 626 for housing; 606 and 626 for cores and cylinders only.

Everest 29 S123 keyway standard for commercial; C keyway standard for residential.

IC installation tool

This tool is used to install the driver and retainer for full size IC in Schlage knobs and levers. Its other ends are designed to install and remove mortise cylinder housings and test mortise cylinder cam action for both small format and full size interchangeable core cylinders.

M504-413
 (Order separately)

