

## introduction

New Traditions® from Yale® outstanding strength, durability and simple, elegant designs highlighted by natural curves for comfort and ease of turning. All *New Traditions* products are built on a steel ANSI/BHMA Grade 3 chassis and feature concealed holding screws and solid brass cylinder assemblies. In addition, all *New Traditions* products feature Quick-Install™, a unique chassis design, which drastically reduces installation time.

Note: *New Traditions* are not for use with commercial hollow metal doors.

## warranty

When used in commercial, institutional or industrial applications, *New Traditions* locksets carry a three-year mechanical and one-year finish warranty.

## ansi/bhma

Certified ANSI/BHMA Grade 3 

## pre-installed screws

Pre-Started screws makes installation quick and easy.

## concealed screws

Provide a clean consistent look.

## interior snap on-off knobs and levers

Saves installation time and reduces chance of scratches.

## brass cylinder standard

Reduces wear and provides smooth operation.

## non-handed levers

Easily field reversible for installation in applications of either hand.

## standard case quantities

	Box Pack (SP)	Clear View (CV)
Dummy	12	6
Knobs	24	6
Levers	12	6
Deadbolts	12	6
Combo Sets	12	6
Handlesets	6	6
Handlesets - Interior Pack	6	N/A

When ordering, specify the exact number of individual units required. For example, if there are 24 units in a case and 1 case is required, specify 24. See page 21 for How to Order.

## contents

Knobs	3-4
Levers	5-6
Deadbolts	7-8
Handlesets	9-10
Interconnected	11-12
Cylinders/Keying	13-14
Latchbolts	15-16
Strikes	17
Accessories	18-19
How to Order	20
Handing of Doors	20

## finishes

ANSI/BHMA Code	Finish Description	US Code
605	Bright Brass	US3
609	Satin Brass, Blackened, Satin Relieved, Clear Coated	US5
613	Dark Oxidized Satin Bronze, Oil Rubbed	US10B
613e	Dark Oxidized Satin Bronze, Permanent	US10BP
619	Satin Nickel Plated, Clear Coated	US15
620	Satin Nickel Plated, Blackened, Satin Relieved, Clear Coated	US15A
625	Bright Chrome Plated	US26
626	Satin Chrome Plated	US26D

Finish Code	Description
GM	Gun Metal
TB	Textured Black



## handleset designs

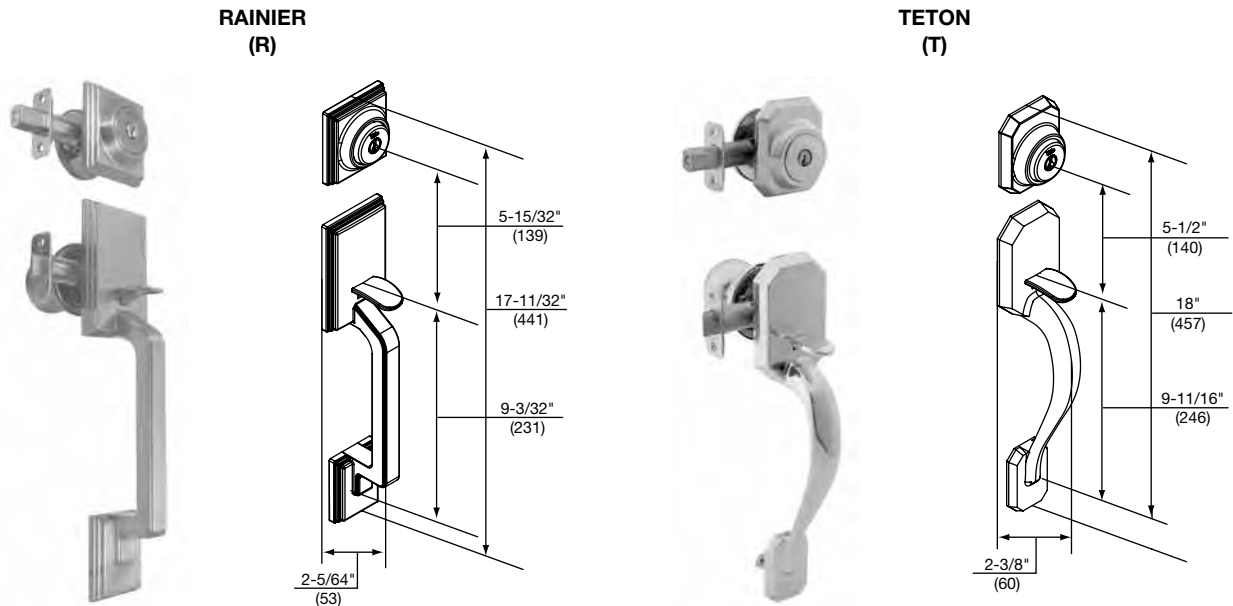

## functions

581/681/682/683	521/621/622/623	541/641/642/643
<b>Dummy:</b> For on-working side of double doors. Non-functioning deadbolt, knob or lever.	<b>Single Cylinder:</b> Thumbpiece retracts latch from exterior side. Knob or lever retracts latch from interior side. Deadbolt latch retracts with key from exterior side, thumbturn retracts deadbolt latch from interior side.	<b>Double Cylinder:</b> Thumbpiece retracts latch from exterior side. Knob or lever retracts latch from interior side. Deadbolt latch retracts with key from exterior side and interior side.

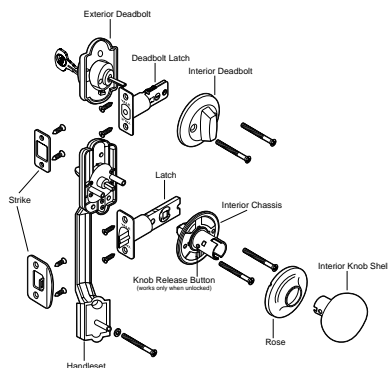

DIMENSIONS	A	B	C	D
El Dorado	2-3/8"	5-1/2"	9-11/16"	18"
McKinley	2-3/8"	5-1/2"	9-11/16"	18"
Rainier	2-3/8"	5-1/2"	9-11/16"	18"
Teton	2-3/8"	5-1/2"	9-11/16"	18"

