

## 1069 Series

# ADA Pocket Door Pull



**1069L SHOWN IN LOCKED POSITION**

The Trimco **1069 Series** pocket door pulls are uniquely designed to meet American with Disabilities Act (ADA) requirements for pocket door applications. With a Contemporary design and stylish black nylon handles the 1069 Series is built for the most demanding applications while remaining aesthetically pleasing. The 1069 Series is available in multiple functions and is fully customizable for most pocket door applications.

## APPLICATIONS

- Hospitals
- Senior Living
- Hotels & Hospitality
- Schools
- Offices

## FUNCTIONS

- **1069** – Passage
- **1069L** – Latching (non-locking)
- **1069FP** – Full Privacy

## POCKET DOOR LOCKS & PULLS

### PRODUCT FEATURES

- Complete pocket door ADA solution
- Multiple functions for different applications
- Exterior emergency access on Full Privacy
- Customizable product

### SPECIFICATIONS

#### DOORS

1-3/8" and 1-3/4" doors standard.  
Custom options available.

#### STANDARDS



ANSI A117.1  
Accessibility Code  
(ADA Compliant)

#### FRAMES

Up to 7" standard.  
Custom options available.

#### WARRANTY

Lifetime Mechanical &  
Limited Finish Warranty

#### MATERIAL OPTIONS

**BR** – Brass  
**BZ** – Bronze  
**SS** – Stainless Steel

#### NOTES

Custom sizes also available  
for various frame sizes.  
Must specify handing.

### FINISHES

<b>499</b>	Polished Brass, No Lacquer
<b>605</b>	Polished Brass
<b>606</b>	Satin Brass, Dull
<b>609</b>	Satin Brass and Black
<b>610</b>	Satin Brass, Black Relieved
<b>611</b>	Polished Bronze
<b>612</b>	Satin Bronze
<b>613</b>	Oil Rubbed Bronze
<b>616</b>	Satin Bronze, Black Relieved
<b>619</b>	Satin Nickel Plated, Clear
<b>629</b>	Polished Stainless Steel
<b>630</b>	Satin Stainless Steel

## 1069 Series

# ADA Pocket Door Pull

## HOW TO SPECIFY & ORDER

### CHOOSE THE FOLLOWING

SERIES	OPTIONS	HANDING – FULL PRIVACY ONLY	FINISHES
<ul style="list-style-type: none"> <li>• <b>1069</b> Passage</li> <li>• <b>1096HA</b> Latching (non-locking)</li> <li>• <b>1069FP</b> Full Privacy</li> </ul>	<ul style="list-style-type: none"> <li>• <b>CUST</b> – Custom Size / Application</li> </ul>	<ul style="list-style-type: none"> <li>• <b>RH</b> – Right Hand</li> <li>• <b>LH</b> – Left Hand</li> </ul>	<ul style="list-style-type: none"> <li>• <b>605</b> Polished Brass</li> <li>• <b>613</b> Oil Rubbed Bronze</li> <li>• <b>630</b> Satin Stainless Steel</li> <li>• <b>SPEC</b> – Special Finish (See finish list for all options)</li> </ul>

### EXAMPLE

For a right hand ADA full privacy locking pocket door pull in stainless steel, specify or order: **1069FP RH 630**

FRONT VIEW

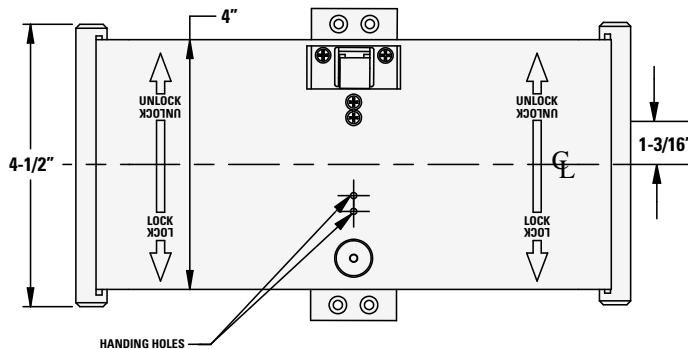

STRIKE

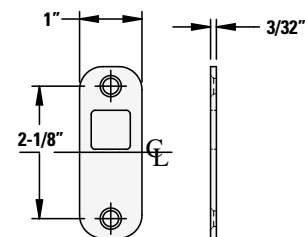

TOP VIEW

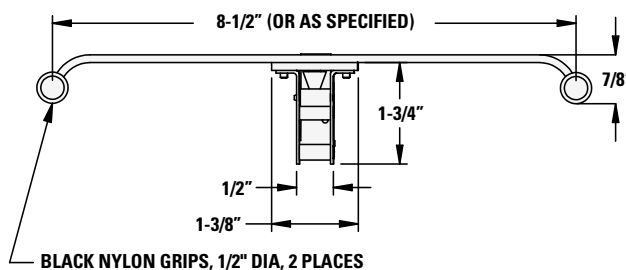

SIDE VIEW

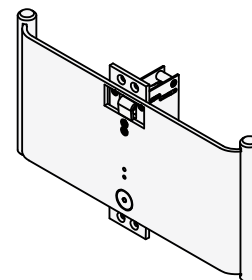

\* Dimensions are informational only. Templates are available at [www.trimcobbw.com](http://www.trimcobbw.com)