

**STANLEY**<sup>®</sup>  
Security Solutions



# SPRING HINGES

UL LISTED

**STANLEY**<sup>®</sup>

## SPRING HINGES

Full Mortise **LifeSpan**



**2060R** – (ANSI K81071F) Square corners – steel-polished and plated or phosphated and prime coated for painting

**2060R (32)** – (ANSI K51071F) Square corners – stainless steel – highly polished

**2060R (32D)** – (ANSI K51071F) Square corners – stainless steel – satin finish

**RD2060R** – (ANSI K81071F) 1/4" (6mm) Radius corners – steel-polished and plated or phosphated and prime coated for painting

**RD2060R (32)** – (ANSI K51071F) 1/4" (6mm) Radius corners – stainless steel – highly polished

**RD2060R (32D)** – (ANSI K51071F) 1/4" (6mm) Radius corners – stainless steel – satin finish

**RD2068R** – (ANSI K81071F) 5/8" (16mm) Radius corners – Steel-polished and plated or phosphated and prime coated for painting

**RD2068R (32)** – (ANSI K51071F) 5/8" (16mm) Radius corners – stainless steel – highly polished

**RD2068R (32D)** – (ANSI K51071F) 5/8" (16mm) Radius corners – stainless steel – satin finish

- For labeled fire doors, stairwell doors, motel and hotel guest room doors, apartment unit entrance doors.
- Meets NFPA80 standard for 3 hour fire doors (NFPA-80 stipulates minimum of 2 spring hinges shall be used on labeled doors)
- 4 1/2" (114mm) size – UL listed for door up to 4' x 8' (1219 x 2438mm)
- 4" (102mm) size – approved for door up to 3' x 7' (914 x 2134mm)
- 3 1/2" (89mm) size – approved for door up to 2' 8" x 7' (813 x 2134mm)
- LifeSpan Limited lifetime warranty for the life of the building
- Internal ratchet mechanism eliminates loose adjustment pins
- Closing power is adjustable up or down
- Excellent alternative to more expensive overhead mounted closers
- Hinges can be furnished as follows:
  - with decorative tips
  - with electric switches (CS) – 4 1/2" (114 mm) only
  - Special screw hole pattern

**Safety locking screw** –  
prevents tampering with power  
adjustment

**Patented ratchet mechanism** –  
fast, precise, one-hand adjustment  
- no locking pins to install

**Unique spring pintle** –  
eliminates spring tab breakage

**Advanced spring design** –  
square wire delivers 25% more  
power

**LifeSpan® bearings** –  
maintenance free, no grease or oil  
required ever!

**RD2068R** – 5/8" (16 mm)

**RD2060R** – 1/4" (6 mm)

**2060R** – R-square

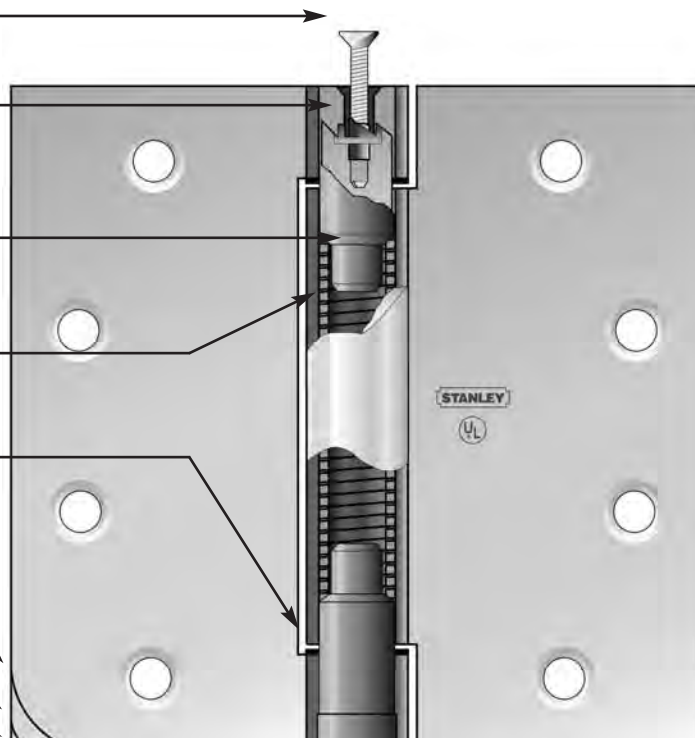

### Adjusting Instructions

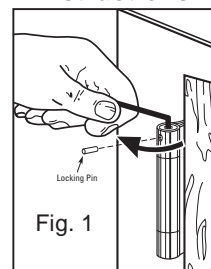

Fig. 1

#### To Increase Torque (Fig 1)

- Close door
- Engage 5/32" hex wrench
- Rotate clockwise to increase torque
- Do not exceed 6 ratchet "clicks"

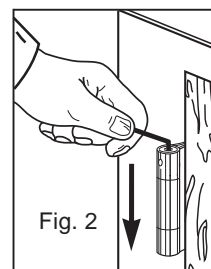

Fig. 2

#### To Decrease Torque (Fig 2)

- Close door
- Engage 5/32" hex wrench
- Depress wrench to disengage ratchet
- Let wrench rotate counter-clockwise to new setting
- Allow wrench to rise

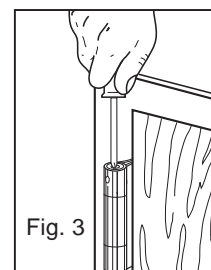

Fig. 3

#### Install Locking Safety Screw (Fig 3)

- Install 6-32 5/8" recessed head machine screw packed with hinge

2060R, RD2060R, RD2068R – 4 1/2"



Application guide lines for  
2060R, RD2060R, RD2068R  
4 1/2" x 4" and 4 1/2" x 4 1/2"

Size Open (Inches) (MM)	Gauge of Metal (Inches) (MM)	Flat Head Screws Per Piece		Quantity Per Box	Quantity Per Case	Case Weight (Lbs.) (Kg)	
		Machine	Wood				
4 1/2 x 4 (114x102)	.134 (3.4)	8-12-24 x 1/2	8-12 x 1 1/4	3 EA.	48 EA.	50	(23)
4 1/2 x 4 1/2 (114x114)	.134 (3.4)	8-12-24 x 1/2	8-12 x 1 1/4	3 EA.	48 EA.	53	(24)

Door Size and Weight	Number of Spring Hinges Required
For doors up to 80 lbs. (36Kg) not exceeding 3' 0" x 7' 6" x 1 3/4" (914 x 2286 x 44mm)	1 each No. 2060R, RD2060R or RD2068R with 2 each anti-friction bearing hinges of same size
For doors up to 130 lbs. (59Kg) not exceeding 3' 0" x 7' 6" x 1 3/4" (914 x 2286 x 44mm)	2 each No. 2060R, RD2060R or RD2068R with 1 each anti-friction bearing hinges of same size
For doors up to 180 lbs. (81.6Kg) not exceeding 3' 0" x 7' 6" x 1 3/4" (914 x 2286 x 44mm)	3 each No. 2060R, RD2060R or RD2068R
For doors up to 180 lbs. (81.6Kg) not exceeding 4' 0" x 8' 0" x 1 3/4" (1219 x 2438 x 44mm)	4 each No. 2060R, RD2060R or RD2068R

When drafts or wind conditions exist, or carpets, door bottoms, bowed or twisted doors or frames, pivot point misalignment or improper latch adjustment affect either the free swinging or latching of the door, additional spring hinges may be required.

\* NFPA-80 stipulates minimum of 2 spring hinges shall be used on labeled doors.

\*\* For fire doors refer to NFPA-80, section 6.4.3.1.

2060R, RD2060R, RD2068R – 4"



Application guide lines for  
2060R, RD2060R, RD2068R  
4" x 4"

Size Open (Inches) (MM)	Gauge of Metal (Inches) (MM)	Flat Head Screws Per Piece		Quantity Per Box	Quantity Per Case	Case Weight (Lbs.) (Kg)	
		Machine	Wood				
4 x 4 (102x102)	.099 (2.5)	8-12-24 x 1/2 with #9 head	8-9 x 1	2 EA.	50 EA.	38	(17)

Door Size and Weight	Number of Spring Hinges Required
For doors up to 3' 0" x 7' 0" x 1 3/4" (914 x 2134 x 44mm) not exceeding 50 lbs. (23Kg)	1 each No. 2060R, RD2060R or RD2068R with 2 each similar sized hinges
For doors up to 3' 0" x 7' 0" x 1 3/4" (914 x 2134 x 44mm) not exceeding 85 lbs. (39Kg)	2 each No. 2060R, RD2060R or RD2068R with 1 each similar sized hinge
For doors up to 3' 0" x 7' 0" x 1 3/4" (914 x 2134 x 44mm) not exceeding 110 lbs. (50Kg)	3 each No. 2060R, RD2060R or RD2068R

Similar sized hinges used with spring hinges must present the same pivot point. When used as part of a complete listed assembly similar hinges must be the same as those tested.

Otherwise, anti-friction hinges must be used.

\* NFPA-80 stipulates minimum of 2 spring hinges shall be used on labeled doors.

\*\* For fire doors refer to NFPA-80, section 6.4.3.1.

2060R, RD2060R, RD2068R – 3 1/2"



Application guide lines for  
2060R, RD2060R, RD2068R  
3 1/2" x 3 1/2"

Size Open (Inches) (MM)	Gauge of Metal (Inches) (MM)	Flat Head Screws Per Piece		Quantity Per Box	Quantity Per Case	Case Weight (Lbs.) (Kg)	
		Machine	Wood				
3 1/2 x 3 1/2 (89x89)	.099 (2.5)	6-10-24 x 1/2 with #9 head	6-9 x 1	2 EA.	50 EA.	32	(15)

Door Size and Weight	Number of Spring Hinges Required
For doors up to 3' 0" x 7' 0" x 1 3/8" (914 x 2134 x 35mm) not exceeding 50 lbs. (23Kg)	1 each No. 2060R, RD2060R or RD2068R with 2 each similar sized hinges
For doors up to 3' 0" x 7' 0" x 1 3/8" (914 x 2134 x 35mm) not exceeding 85 lbs. (39Kg)	2 each No. 2060R, RD2060R or RD2068R with 1 each similar sized hinge
For doors up to 3' 0" x 7' 0" x 1 3/8" (914 x 2134 x 35mm) not exceeding 110 lbs. (50Kg)	3 each No. 2060R, RD2060R or RD2068R

Similar sized hinges used with spring hinges must present the same pivot point. When used as part of a complete listed assembly similar hinges must be the same as those tested.

Otherwise, anti-friction hinges must be used.

\* NFPA-80 stipulates minimum of 2 spring hinges shall be used on labeled doors.

\*\* For fire doors refer to NFPA-80, section 6.4.3.1.

**SPRING HINGES****2079 SPRING HINGES AND FREE SWINGING HINGE SETS**

**1 set 2079 4 1/2" x 4 1/2" US3 (632) EDP# 82-7162** to consist of:

- 2 each 2060R 4 1/2" x 4 1/2" US3, Steel
- 1 each FBB179 4 1/2" x 4 1/2" US3, Steel

**1 set 2079 4 1/2" x 4 1/2" USP (600) EDP# 82-7170** to consist of:

- 2 each 2060R 4 1/2" x 4 1/2" USP, Steel
- 1 each FBB179 4 1/2" x 4 1/2" USP, Steel

**1 set 2079 4 1/2" x 4 1/2" US26D (652) EDP# 82-7188** to consist of:

- 2 each 2060R 4 1/2" x 4 1/2" US26D, Steel
- 1 each FBB179 4 1/2" x 4 1/2" US26D, Steel

- For medium weight doors of average frequency
- Installer uses one box of hinges on a door up to 7' 6" (2286mm) in height
- All hinges have template screw hole location to use on either wood or hollow metal doors and frames
- Identical pivot point for all 3 hinges
- Can be used on labeled doors (Refer to NFPA-80)
- 2060R conforms to ANSI K81071F
- FBB179 conforms to ANSI A8112

**FBB179****2060R**

### Application guide lines for 2060R – 4 1/2"

Door Size and Weight	Number of Spring Hinges Required
For doors up to 130lbs. (59 Kg) not exceeding 3'0" x 7'6" x 1 3/4" (914 x 2286 x 44mm)	2 each No. 2060R, RD2060R or RD2068R with 1 each anti-friction bearing hinges of same size

When drafts or wind conditions exist, or carpets, door bottoms, bowed or twisted doors or frames, pivot point misalignment or improper latch adjustment affect either the free swinging or latching of the door, additional spring hinges may be required.

\* NFPA-80 stipulates minimum of 2 spring hinges shall be used on labeled doors.

\*\* For fire doors refer to NFPA-80, section 6.4.3.1.

Spring Hinge Location, When Using 2 Spring Hinges On a Door

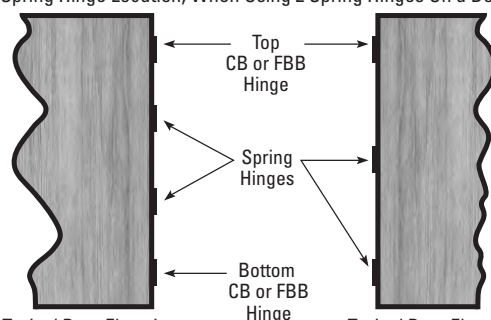

Typical Door Elevation when using 4 Hinges

Typical Door Elevation when using 3 Hinges

Class Number	Size Open (Inches) (MM)	Gauge of Metal (Inches) (MM)	Flat Head Screws Per Set		Quantity Per Box	Quantity Per Case	Case Weight (Lbs.) (Kg)
			Machine	Wood			
2079	4 1/2 x 4 1/2 (114x114)	.134 (3.4)	24-12-24 x 1/2	24-12 x 1 1/4	1 SET	16 SETS	55 (25)

Product information contained in this catalog has been compiled and presented with as much care and completeness as is reasonably possible. Errors or mistakes may be present, and in many cases, reliance has been placed on information supplied by other manufacturers which may be in error or which may be subject to changes or modifications by the manufacturer without notice and without obligation. Therefore, no guarantee can be made or should be assumed or implied with regards to product information contained in this catalog.

**STANLEY**
**Security Solutions**
**Stanley Security Solutions, Inc.**

6161 E. 75th Street Indianapolis, Indiana 46250

©2010 Stanley Security Solutions, Inc. • www.stanleysecuritysolutions.com

10M 910  
SAH010