

GENERAL HINGE INFORMATION

Stanley Finish Symbols and ANSI/BHMA Finish Numbers

Specify finish by suffixing Stanley symbol or ANSI/BHMA number to class number

Stanley Hardware Finish Symbol	General Description	Base Material					
		Steel	Brass	Bronze	Stainless Steel	Aluminum	Zinc
1D	Black coated	693	693	693	693	693	693
2C	Zinc plated	663	—	—	—	—	—
3	Bright brass	632	605	—	—	666	677
3A	Bright brass, no lacquer, on brass metal only	—	—	—	—	—	—
4	Satin brass	633	606	—	—	—	678
5	Satin brass, blackened, satin relieved, clear coated	638	609	—	—	—	—
9	Bright bronze	637	—	611	—	705	679
10	Satin bronze	639	—	612	—	668	680
10A*	Satin bronze, oxidized, relieved, clear coated	641	—	614	—	—	—
10B*	Satin bronze, oxidized and oil rubbed on bronze metal only	—	—	613	—	—	—
10BL*	Satin bronze, oxidized, lacquered	641	—	—	—	—	—
14	Nickel plated, bright	645	618	618	—	669	—
15	Nickel plated, satin	646	619	619	—	670	—
17A	Nickel plated, imitation half-polished iron oxidized and relieved	648	621	621	—	—	—
20*	Statuary bronze	649	—	623	—	—	—
20A*	Statuary bronze, dark	650	—	624	—	—	—
26	Bright chromium plated,	651	625	625	—	672	681
26D	Satin chromium plated	652	626	626	—	702	682
27	Satin aluminum metal, lacquered	—	—	—	—	627	—
28	Satin aluminum, anodized	—	—	—	—	628	—
32	Stainless steel metal, bright	—	—	—	629	—	—
32D	Stainless steel metal, satin	—	—	—	630	—	—
P	Primed for painting or staining (over a phosphated base)	600	—	—	—	—	674
A6	Antique bronze	—	—	—	—	—	—
AL	Aluminum, clear coated	—	—	—	—	673	—
BC	Black chrome, bright	686	684	684	—	—	—
BCD	Black chrome, satin	687	685	685	—	—	—
D4	Satin or antique copper on smooth surface	—	—	—	—	—	—
D7	Bright copper finish	—	—	—	—	—	—
DD	Dark bronze, painted	690	690	690	690	690	690
DDI	Dark Duranodic, painted	695	695	695	695	695	695
DL	Light bronze, painted	691	691	691	691	691	691
DM	Medium bronze, painted	694	694	694	694	694	694
F4	Satin brass, blackened, satin relieved, clear coated	—	609	—	—	—	—
F6	Dark statuary brass	650	—	—	—	—	—
F8	Antique brass	—	—	—	—	—	—
LA	Aluminum lacquer	—	—	—	—	—	—
PS	Plain steel – unfinished	—	—	—	—	—	—
ST4C	Satin brass tone	604	—	—	—	—	—

*Finishes 10A, 10B, 10BL, 20, and 20A will be furnished to our standards

GENERAL HINGE INFORMATION

Special Situation Products

- “CE” Concealed electric hinges conduct current regardless of door position to electric locks, exit devices, or hold open devices where tamper-proof hinge is required. Also to transmit signals from code readers on doors to remote computers for access control
- No electrical parts are exposed when hinge is installed
- Permanent fast pin
- Hinges should be installed in the center hinge location
- Not available as swing clear or raised barrel
- Hinges may be equipped with both concealed wires and concealed switches. When both are desired on the same hinge use prefix “CECS”
- Packed one per box with all machine screws and installation instructions
- When ordering specify class number, size, finish and number of wires
Suffix -54 for 4 wires, 56 for 6 wires -66 for 6 wires (2@24AWG, 4@28AWG), 58 for 8 wires or 10 for 10 wires
- Should be used along with a junction box
- Can be furnished with hospital tips

CECB179
CECB168
CECB191
CECB199
5-Knuckle
Concealed
Bearings



CEFBB179
CEFBB168
CEFBB191
CEFBB199
5-Knuckle
Exposed
Bearings



CECB1900R
CECB1901R
CECB1960R
CECB1961R
3-Knuckle
Concealed
Bearings



Not
Handed



Not
Handed



Handed
Specify
RH or LH



Electrical Ratings

Suffix	# Wires	Wire Gage	Volts (AC or DC)	
			6, 12, 24	48
			Current	
-54	4	28AWG	1 amp/wire	5 milli-amp/wire
-56	6	28AWG	.7 amp/wire	5 milli-amp/wire
-58	8	28AWG	.5 amp/wire	5 milli-amp/wire
-10	10	28AWG	.4 amp/wire	5 milli-amp/wire
-66*	6	2@24AWG	2 amp/wire	5 milli-amp/wire
		4@28AWG	1 amp/wire	5 milli-amp/wire

Inrush 15A for .05 second/wire

“CE” hinges are listed by UL at these ratings

* Not available in FBB168 and FBB199

Class Number

Class Number	Sizes Available	
CB179, FBB179, CB1900R	4 1/2" x 4"	(114mm x 102mm)
CB168, FBB168, CB1901R	4 1/2" x 4 1/2"	(114mm x 114mm)
CB191, FBB191, CB1960R	5" x 4"	(127mm x 102mm)
CB199, FBB199, CB1961R	5" x 4 1/2"	(127mm x 114mm)
	5" x 5"	(127mm x 127mm)
	6" x 4 1/2"	(152mm x 114mm)
	6" x 5"*	(152mm x 127mm)
	6" x 6"*	(152mm x 152mm)

* Not available in CB191, FBB191, CB1900R and CB1960R

JB2R – Junction Box

- Note: Install in middle hinge location
- Can be shop welded or field installed — before frames are set
- Fits either 4 1/2" (114mm) or 5" (127mm) size hinges

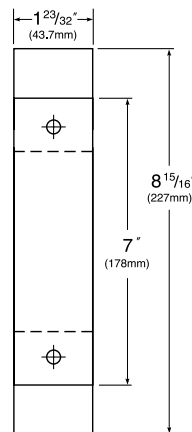
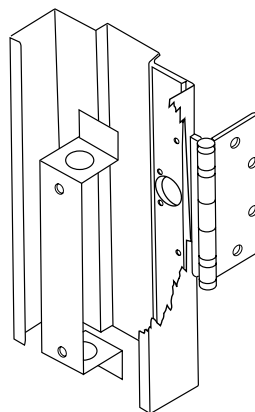

Junction Box
Top View

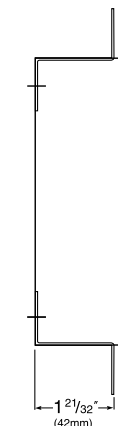

Right Side
View