

# SCM-200-Pelco

## Pelco RS-422 Camera Control Two Input Code Merger Ver 2.2

Merges data from two Pelco RS-422 camera control lines into a single data line.

Each input and output baud rate is individually selectable. The code type on each input, "D" or "P", is detected automatically. The output code type is switch selectable. Output "D" code is 2400 baud with no parity. Output "P" code can have either no parity or even parity. Input #2 camera addresses can be offset in groups of 8 up to a maximum of 248.

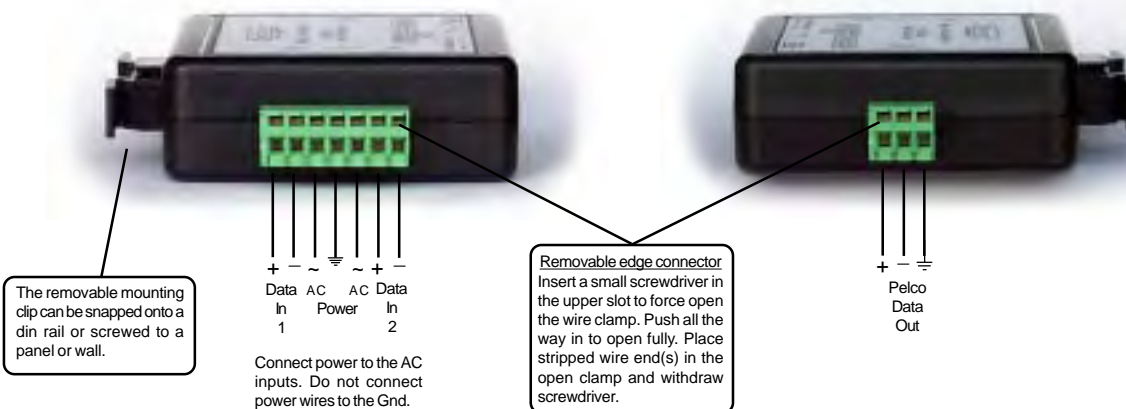
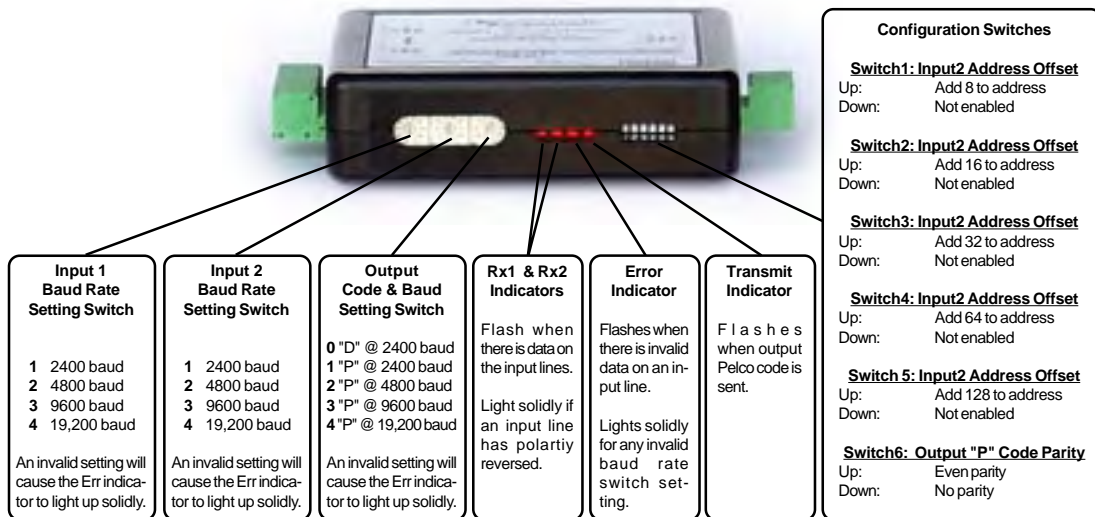

### SPECIFICATIONS

Size: 4.5" x 3.5" x 1.25"  
 Weight: 0.5 lb  
 Power: 9Volt to 15Volt AC or DC at 75ma  
 Environmental: Indoor use only

### OPTIONS

Each input can optionally be ordered as RS-232

[www.sennetech.net](http://www.sennetech.net)

Sennetech, Inc. 6455 W. Bath Rd. Perry, MI 48872 U.S.A. Ph (517) 675-1150 Fax (517) 65-1151

## NOTES

### **Input #2 Address Offset**

Switches 1, 2, 3, 4 and 5, when turned on, add 8, 16, 32, 64, and 128 respectively to the camera address on input number 2. If they are all on, the total offset is 248.

The maximum camera address is 256. If the resulting address exceeds 256, there will be no output.

This can be used for applications with multiple DVRs which have camera control outputs for camera addresses 1~8 or 1~16. Here are some possible combinations.

