

600-lb Single-Door Maglocks



Model Numbers

E-941SA-600

600-lb, single door, UL listed

E-941SA-600PQ

600-lb, single door, with bond sensor and status LED, UL listed

Accessories

E-941S-600/LQ

L-Bracket



E-941S-600/ZQ

Z-Bracket



E-941S-600/UQ

U-Bracket for glass doors



E-941S-600/PQ

Plate spacer



E-941S-600/HQ

Armature plate holder



Applications

Typical Installation

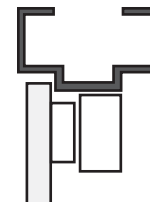

With "L" Bracket

Plate Spacers

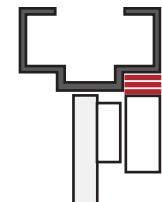

With "Z" and "L" Bracket



With "U" Bracket

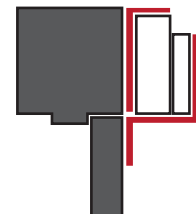

With Armature Plate Holder

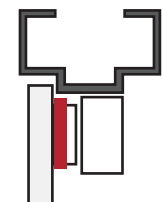
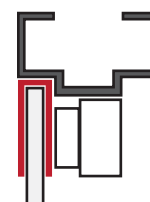

Features

- Anodized aluminum housing (US 28)
- Dual voltage: 12/24 VDC Operation
- No residual magnetism
- Detachable faceplate
- Adjustable mounting bracket
- MOV Surge protection
- Complete mounting hardware included

E-941SA-600PQ Only:

- Status LED – Built-in 2-color LED shows lock/unlock status
- Built-in bond sensor with 3A dry relay output for monitoring door status
- 3A@12VDC SPDT Relay

LED	Status
Green	Door is closed and locked
Red	Door not closed and/or locked
Off	Door in use / No power

Specifications

Model	E-941SA-600	E-941SA-600PQ
Holding force	600-lb (272kg)	
Operating voltage	12/24 VDC	
Current draw	12VDC	500mA
	24VDC	250mA
Coil resistance	48Ω±10% per coil	
Bond sensor relay	N/A	3A@12VDC
Status LED	N/A	Yes
Operating temperature	14°~131° F (-10°~55° C)	
Dimensions	Magnet	9 7/8" x 1" x 1 5/8" (250x25x40 mm)
	Armature plate	7 1/4" x 1/2" x 1 1/2" (185x12x38 mm)
Weight	4-lb 6-oz (2kg)	

Dimensions

Electromagnet

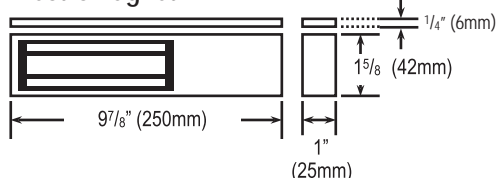

Armature Plate

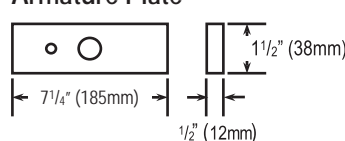

Mounting Brackets

Z-Brackets

Model Numbers:	Compatible with:
E-941S300R/ZQ	E-941SA-300RQ
E-941S-600/ZQ	E-941SA-600, E-941SA-600PQ, E-941DA-600Q, E-941DA-600PQ
E-941S-1K2/ZQ	E-941SA-1200, E-941SA-1K2PQ, E-941SA-1K2PD, E-941DA-1K2Q, E-941DA-1K2P, E-941SA-1K5Q



L-Brackets

Model Numbers:	Compatible with:
E-941S300R/LQ	E-941SA-300RQ
E-941S-600/LQ	E-941SA-600, E-941SA-600PQ E-941DA-600Q, E-941DA-600PQ
E-941S-1K2/LQ	E-941SA-1200, E-941SA-1K2PQ E-941SA-1K2PD, E-941DA-1K2Q E-941DA-1K2P
E-941S-1K5/L	E-941SA-1K5Q



U-Brackets

Model Numbers:	Compatible with:
E-941S300R/UQ	E-941SA-300RQ
E-941S-600/UQ	E-941SA-600, E-941SA-600PQ E-941DA-600Q, E-941DA-600PQ
E-941S-1K2/UQ	E-941SA-1200, E-941SA-1K2PQ, E-941SA-1K2PD, E-941DA-1K2Q E-941DA-1K2P, E-941SA-1K5Q



Plate Spacers

Model Numbers:	Compatible with:
E-941S300R/PQ	E-941SA-300RQ
E-941S-600/PQ	E-941SA-600, E-941SA-600PQ
E-941S-1K2/PQ	E-941SA-1200, E-941SA-1K2PQ
E-941S-1K5/P	E-941SA-1K5Q
E-941D-600/PQ	E-941DA-600Q, E-941DA-600PQ
E-941D-1K2/P	E-941DA-1K2Q, E-941DA-1K2P



Armature Plate Holders

Model Numbers:	Compatible with:
E-941S-600/HQ	E-941SA-600, E-941SA-600PQ, E-941DA-600Q, E-941DA-600PQ
E-941S-1K2/HQ	E-941SA-1200, E-941SA-1K2PQ, E-941SA-1K2PD, E-941DA-1K2Q, E-941DA-1K2P, E-941SA-1K5Q



Note: Brackets and spacers not available for E-941SA-300