



## ROFU® PUSH BAR MODEL 9500

For Use with Fail Safe Locking Devices

### Standard Features



- Equipped with two micro switches; will engage with minimal bar movement.
- Heavy Duty Aluminum extrusion and a specially designed slide mechanism insure problem free operation, even on high usage doors.
- Supplied with ROFU 12" Stainless Flexible Door Cord # 10318.
- Special key (supplied in hardware kit) can either permanently put the bar in a closed or open position.
- Limited Warranty - 12 Months
- Dimensions for 9500x36: 34 1/2" L x 2 11/16"D x 2 1/4" H  
Available in standard US28 or black



## 9500 SERIES - Specifications

### COLOR CODED SWITCH WIRES:

<b>SWITCH # 1</b>	<b>COMMON=BLACK</b>	<b>N.O.=WHITE</b>	<b>N.C.=RED</b>
<b>SWITCH # 2</b>	<b>COMMON=GREEN</b>	<b>N.O.=BLUE</b>	<b>N.C.=YELLOW</b>

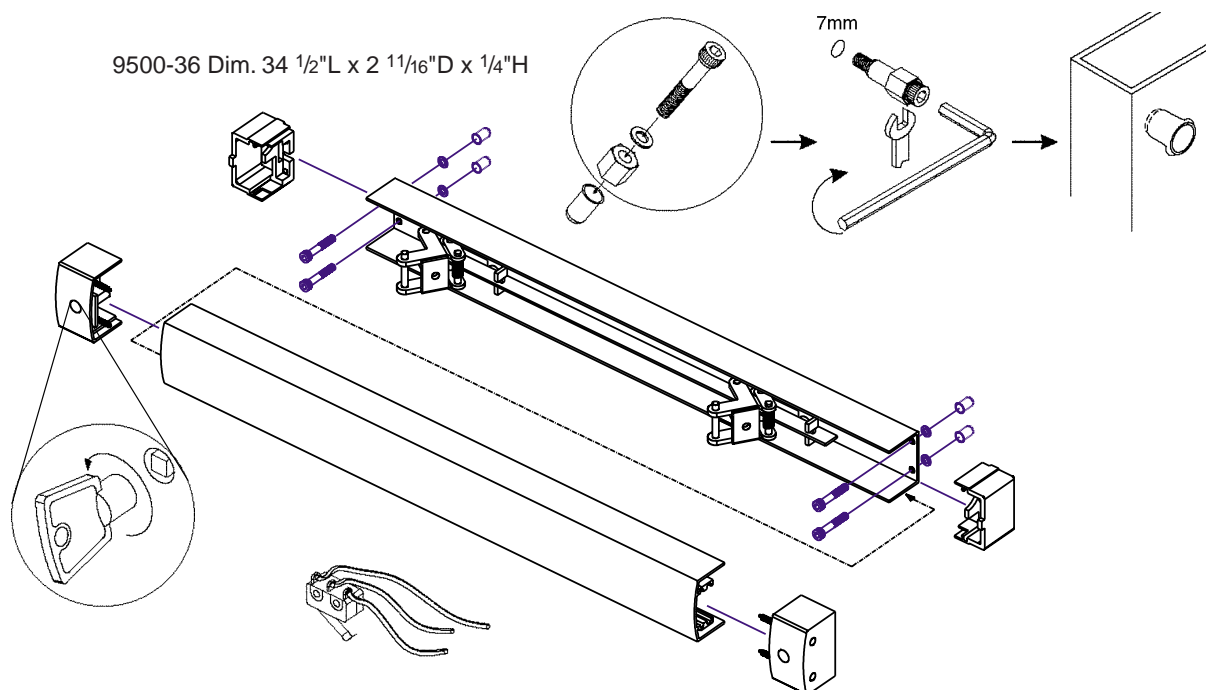

NOT TO SCALE - TECHNICAL DATA SUBJECT TO CHANGE WITHOUT NOTICE