

H-3592

Awning Operator Tee Handle

Contents: 1 handle.

Description: Diecast handle; uniquely designed for 5/16" hex drive operators.

H-3592

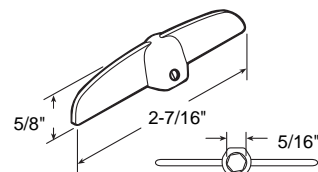

H-3596 (Aluminum - left hand)

H-3597 (Aluminum - right hand)

H-3598 (Bronze - left hand)

H-3599 (Bronze - right hand)

H-3820 (White - left hand)

H-3821 (White - right hand)

Casement Locking Handle (Offset base)

Contents: 1 locking handle; 1 keeper; 1 set of installation screws.

Description: Diecast locking handle and keeper with 1-1/2" hole centers; similar to *Truth* hardware; uses #10 flat head machine screws commonly used on metal framed windows.

You may wish to stock these related parts: **H-3604**, **H-3605**.

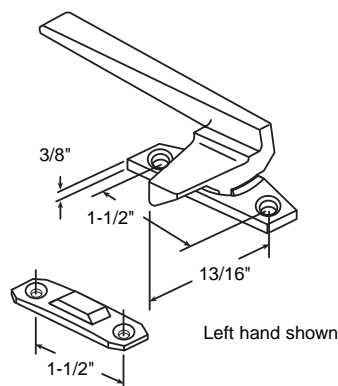

H-3853 (Aluminum - left hand)

H-3854 (Aluminum - right hand)

H-3855 (Bronze - left hand)

H-3856 (Bronze - right hand)

H-3857 (White - left hand)

H-3858 (White - right hand)

Casement Locking Handle (In-line base)

Contents: 1 locking handle; 1 keeper; 1 set of installation screws.

Description: Diecast locking handle and keeper with 1-9/16" hole centers; uses #8 sheet metal screws for application to wood framed windows.

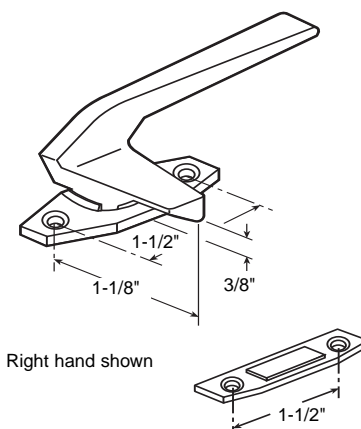

H-3681 (Left hand)

H-3682 (Right hand)

Casement Locking Handle

Contents: 1 handle; 1 strike; 1 set of installation screws.

Description: Zinc diecast locking handle; aluminum finish.

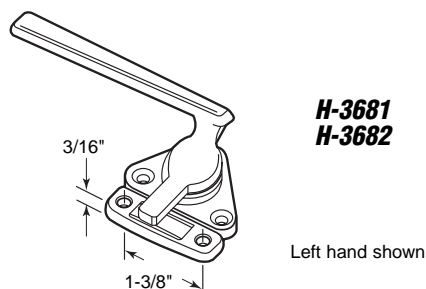

H-3681 H-3682

H-3600 (Left hand)

H-3601 (Right hand)

Casement Locking Handle

Contents: 1 handle.

Description: Heavy bronze casting; 1-3/8" hole centers for steel windows; hole in lock handle allows it to be used, in elevated location, for pole operation.

You may wish to stock these related parts: **H-3659**.

H-3600 H-3601

