

ABB-1012 INDOOR/OUTDOOR STEEL BELL BOX



- 18 gauge cold rolled steel
- UL Listed motor driven low current bell (100mA at 12V DC)
- Dual-wired, UL Listed reed tamper switches
- Salt spray and rust resistance
- 12V DC operating voltage
- Durable, weather-resistant powder coat paint
- Suitable for use with most control panels
- Evenly spaced louvers for a higher sound output
- Overall size 14" x 14" x 4"
- More space for your company logo
- Exterior color is beige

The ABB-1012 is a rugged indoor/outdoor slim-line bell box, designed to withstand harsh environment conditions. The box is constructed of a heavy interlocking welded 18 gauge steel with a durable beige powder coat finish to prevent corrosion. It operates on 12V DC and draws a low 100mA. The ABB-1012 implements an exclusive UL Listed, low current, patented motor driven bell mounted to a removable inner baffle plate and generates a sound output of 100 plus decibels. Two UL approved reed tamper switches are designed into the bell box to provide complete tamper protection.

Exclusive Motor Driven Bell

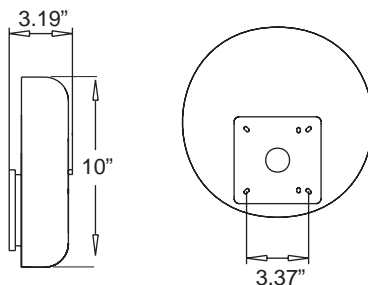

Specifications

Model Number	Stock Number	Rated Voltage	Rated Current	Sound Output	Starting Voltage	Bell Gong Size	Tamper Switching Current	Total Weight (lbs.)
ABB-1012	4010002	12	100	100	8	10	0.3A	15 1/2

Dimensions: inches (mm)

