

Secures Out-Swinging Doors with Loose Pin Hinges

JAMB PINS^{T.M.}

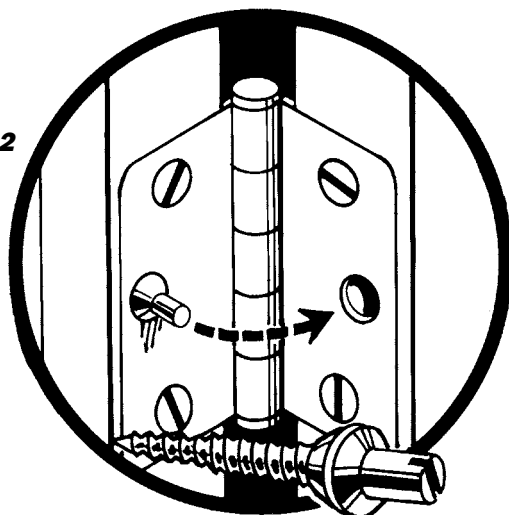

JP-10 & JP-12



■ **JP-10 & JP-12 Pins:** Simply remove one opposing screw from each hinge leaf and replace with the proper size Jamb Pin.

■ Secures door in jamb when closed if hinge pin is removed.

■ For use on wood or metal doors and jambs.

■ Jamb Pins have a combination wood and machine thread.

JP-10: For residential hinges using #10 screw. Machine screw thread is 10-24. 2 pins per pack.

JP-10-100: Bulk Pack. 100 per pack.

JP-12: For commercial hinges using #12 screw. Machine screw thread is 12-24. 2 pins per pack.

JP-12-100: Bulk Pack. 100 per pack.



JP-22 JAMB PIN

Jamb pin for added security on hinge side of door. To install, drill a 1/4" hole in center of door frame and secure with mounting screws (supplied). Drill a 1/2" hole in the door to receive pin and installation is complete.

Note: JP-22 may have to be mortised flush on tight fitting doors. Packed two per bag with fasteners, zinc plated.

