

C5 Series

A/V credenza rack

unique design with integrated thermal management simplifies system design and minimize delays

features:

- Frame to Furniture™ design complements an integrator's installation workflow
- Fully assembled frames ship separately from furniture-grade panels
- Integrated, thermostatically controlled cooling quietly protects active electronics
- Available in 1, 2 and 3 bay models and two depths
- Unique design allows panels to be replaced quickly and easily
- Available in Moderno, Sota and Klasik Styles
- Standard finishes available: Veneer, High Pressure Laminate and Thermolaminate materials



specifications:

EIA Compliant 19" A/V Credenza Rack shall be Middle Atlantic Products model # C5FF-__ (refer to chart). Credenza Rack shall be available in 1, 2 or 3 bay configurations. Overall dimensions shall be 31-1/4" H x __W" x __D (refer to chart). Usable height shall be 14 rackspaces per bay. Rack frames shall ship fully assembled and be constructed of steel. Total weight capacity with Middle Atlantic finishing kit shall be 600 lbs., with a maximum of 350 lbs. to be placed on the top surface. Total weight capacity of the frame only (must take into account the weight of the customer supplied finishing kit) shall be 800 lbs. Each rack bay shall come equipped with 2 pairs of 11-gauge steel rackrail tapped with 10-32 mounting holes in universal EIA spacing, black e-coat finish and numbered rackspaces. Credenza rack shall have one 50 CFM thermostatically controlled proportional speed blower per bay. Exhaust air shall exit the front of the credenza for unrestricted air flow. Thermostatically controlled fans shall be powered on at 87°F and turn off at 85°F. Credenza rack shall require vent panel, model # C5-VENT-__ (refer to chart) and have venting on the top and bottom of the face of the rack. Credenza rack shall include two adjustable side mounted horizontal lacing bars for enhanced cable management. Credenza rack shall have a steel rear access panel. Credenza rack shall be finished in a durable black powder coat. Top, sides, and front doors shall ship separately from rack frame and be model # C5_K-__-DX. Top shall be constructed of 1-1/8" OR 1" thick triple refined MDF or Particle Board, sides shall be constructed of 3/4" OR 1" thick triple refined MDF or particle board, front doors shall be constructed of 3/4" thick triple refined MDF. Top, sides and front doors shall be available in a Moderno, Sota or Klasik styles. Front doors shall be solid or plexi. Top, sides and front doors shall be available in Veneer, High Pressure Laminate and Thermolaminate materials, visit middleatlantic.com for list of available finishes. Credenza rack shall include 4 fine floor casters. Credenza rack shall be GREENGUARD Gold Certified with the exception of Veneer finishes, which shall be GREENGUARD Certified. Credenza rack shall comply with the requirements of RoHS EU Directive 2002/95/EC. Credenza rack shall be manufactured by an ISO 9001 and ISO 14001 registered company. Credenza Rack frame shall be warrantied to be free from defects in material or workmanship under normal use and conditions for the lifetime of the rack, fans shall be warrantied for a period of three years and wood panels shall be warrantied for a period of 7 years.

Customizable specification clips available at middleatlantic.com

EIA/TIA COMPLIANT



PRODUCT CERTIFIED FOR
LOW CHEMICAL EMISSIONS
UL.COM/GG
UL 2818

options:

- Shelf System insert shall be model # C5-SH-SYS__ (refer to chart)
- Flip up side shelf shall be model # C5-__FS-__ (refer to chart)
- Slide out rotating rack bay shall have 12 rackspaces and be model C5D-SRSR12
- Adjustable Rail Bracket shall be model # C5-ARB__
- 1 bay rear door extender kit shall be model # C5-EXT-3
- Cable grommet shall be model # C5-CG-__
- Monitor mounts shall be part # C5MM-__-__
- Millwork kit shall be C5-MK__(frame depth - 27, 31)-__ (number of bays - 1,2,3)

what **great systems** are built on.™

A brand of **legrand**

Middle Atlantic Products
middleatlantic.com | middleatlantic.ca

96-01195 / rev n / 9-29-16

C5 Series

basic dimensions

all dimensions in inches unless otherwise noted [all dimensions in brackets are in millimeters]

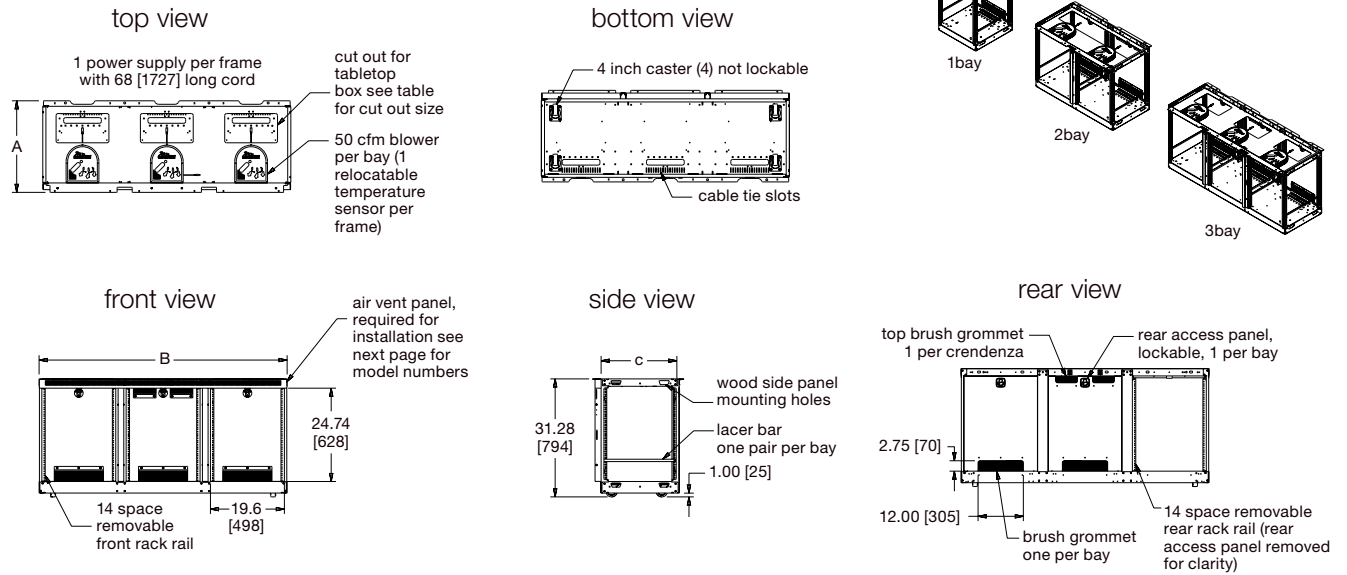

Frame Part Number	"A" Depth	"B" Width	"C" Useable Depth	Cut Out Size	Qty of Cut Outs	DbA	Fan Free Air Rated CFM	Actual Installed CFM
C5-FF27-1	24.27 [616]	21.05 [535]	20.08 [510]	7.75 [197] X 17.05 [433]	1	33	50	46
C5-FF27-2	24.27 [616]	43.39 [1102]	20.08 [510]	7.75 [197] X 39.39 [1001]	1	34	100	91
C5-FF27-3	24.27 [616]	65.75 [1670]	20.08 [510]	7.75 [197] X 14.00 [356]	3	36	150	138
C5-FF31-1	28.13 [714]	21.05 [535]	23.94 [608]	10.00 [254] X 17.05 [433]	1	33	50	46
C5-FF31-2	28.13 [714]	43.39 [1102]	23.94 [608]	10.00 [254] X 39.39 [1001]	1	43	100	91
C5-FF31-3	28.13 [714]	65.75 [1670]	23.94 [608]	10.00 [254] X 14.00 [356]	3	36	150	138

Cooling Capabilities			
Thermal Load	Temp Change (F) C5-FF27-1 / IC5-FF27-1 C5-FF31-1 / IC5-FF31-1	Temp Change (F) C5-FF27-2 C5-FF31-2 / IC5-FF31-2	Temp Change (F) C5-FF27-3 C5-FF31-3 / IC5-FF31-3
0.8A-100W	3.3	1.8	1.3
1.7A-200W	7.4	4.6	3.7
2.5A-300W	9.9	6.5	4.7
3.3A-400W	14.5	7.2	5.3
4.2A-500W	17.8	10.0	7.8
5.0A-600W	21.2	11.3	9.0
5.8A-700W	25.8	14.5	10.1
6.7A-800W	26.6	15.0	12.2
7.5A-900W	31.5	17.7	13.3
8.A-1000W	33.3	19.5	15.6

Note:

1. Amperage is based on actual amperage ratings, not on nameplate ratings, which have been proven to vary significantly
2. Ideal max. temp. change 15°F based on an ambient room temp. of 70°F
3. This data is made assuming that the credenza is placed against a wall in a room

what **great systems** are built on.™

A brand of **legrand**

MA

Middle Atlantic Products

middleatlantic.com | middleatlantic.ca

C5 Series

basic dimensions

all dimensions in inches unless otherwise noted [all dimensions in brackets are in millimeters]

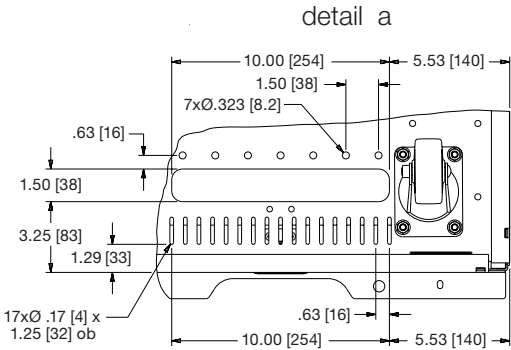
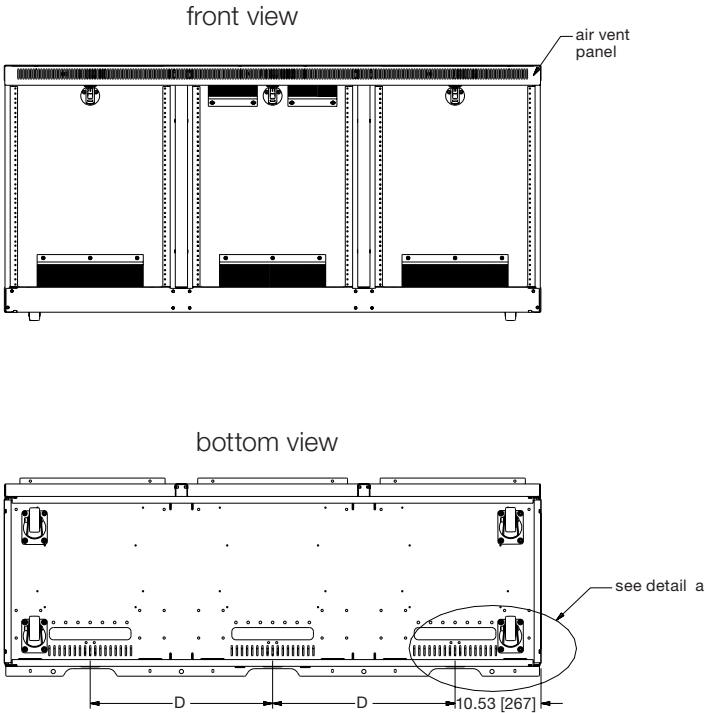

Note:
1. Air vent panel is removable and offered in different colors, required for installation.

Frame Part Number	“D” Center Distance	Air Vent Part Number	Color Code		
C5-FF27-1	N/A	C5-VENT1-WH	WH	White	
		C5-VENT1-OW	OW	Off White	
		C5-VENT1-SM	SM	Silver Metallic	
C5-FF31-1		C5-VENT1-BK	BK	Flat Black	
C5-FF27-2		22.35 [568]	C5-VENT2-WH		
			C5-VENT2-OW		
	C5-FF31-2		C5-VENT2-SM		
C5-FF27-3	22.35 [568]	C5-VENT2-BK			
		C5-VENT3-WH			
		C5-VENT3-OW			
C5-FF31-3		C5-VENT3-SM			
		C5-VENT3-BK			

what great systems are built on.™

A brand of  legrand

C5 Series Sota Style:

basic dimensions

all dimensions in inches unless otherwise noted [all dimensions in brackets are in millimeters]

Sota Style: HPL and Veneer

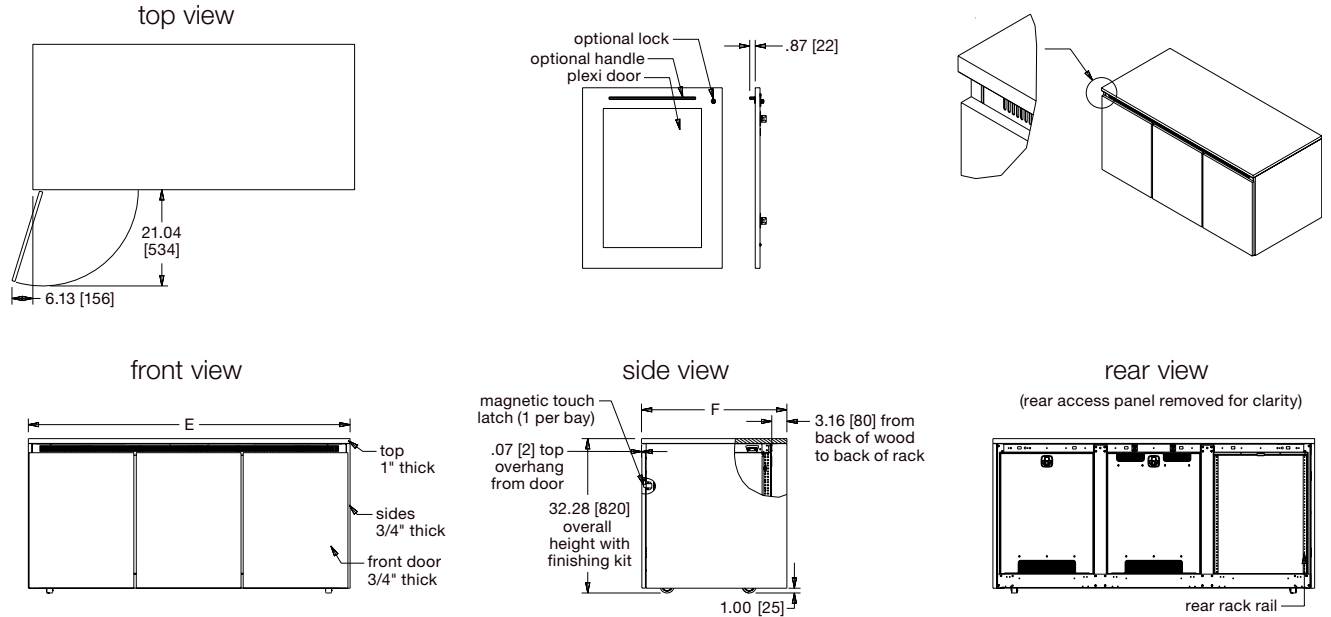

Sota Style: Thermolaminate

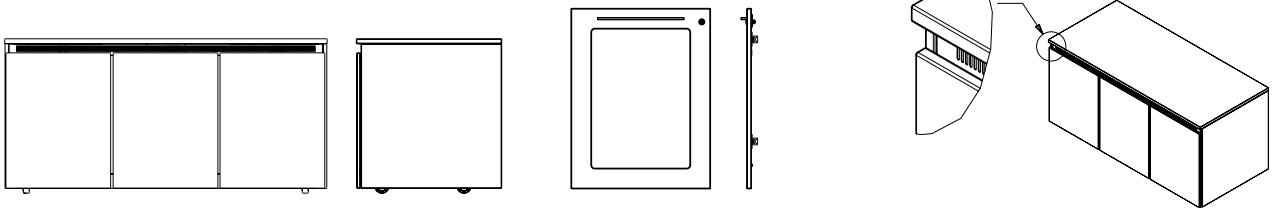

Finishing Kit Number	Door Type	"E" Width	"F" Depth	Compatible With
C5K1A1SPXYY	plexi	22.8 [580]	26.6 [676]	C5-FF27-1
C5K1A1SSXYY	solid			
C5K2A1SPXYY	plexi	45.1 [1146]	26.6 [676]	C5-FF27-2
C5K2A1SSXYY	solid			
C5K3A1SPXYY	plexi	67.5 [1715]	26.6 [676]	C5-FF27-3
C5K3A1SSXYY	solid			
C5K1B1SPXYY	plexi	22.8 [580]	30.4 [773]	C5-FF31-1
C5K1B1SSXYY	solid			
C5K2B1SPXYY	plexi	45.1 [1146]	30.4 [773]	C5-FF31-2
C5K2B1SSXYY	solid			
C5K3B1SPXYY	plexi	67.5 [1715]	30.4 [773]	C5-FF31-3
C5K3B1SSXYY	solid			

X = suffix with V for veneer finish, suffix with H for hpl finish suffix with T for thermolaminate finish
YY = color selection; refer to middleatlantic.com for options

Notes:

- To order, full part number must be generated at middleatlantic.com
- 2 Bay credenzas have a left and right door by default, 3 and 1 bay credenzas have left doors by default.

Accessory Part Number	Accessory Type	Color Code
ACC-LOCK1-BK	lock	Black
ACC-LOCK1-MA	lock	Modern Aluminum (Matte Finish)
ACC-LOCK1-WH	lock	White
ACC-HANDLE1-MA	handle	Modern Aluminum (Matte Finish)

what **great systems** are built on.™

A brand of **legrand**

Middle Atlantic Products
middleatlantic.com | middleatlantic.ca

C5 Series Moderno Style:

basic dimensions

all dimensions in inches unless otherwise noted [all dimensions in brackets are in millimeters]

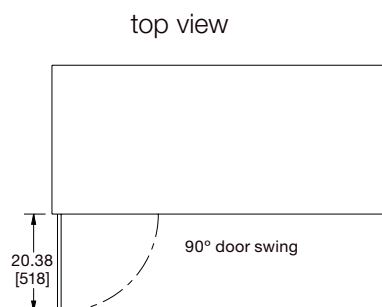

Moderno Style: HPL and Veneer

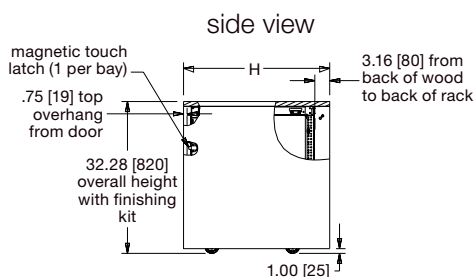
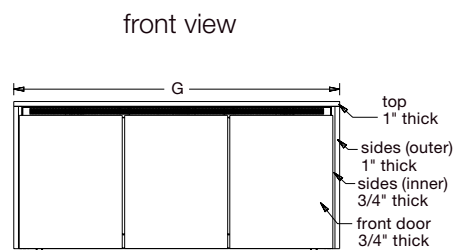
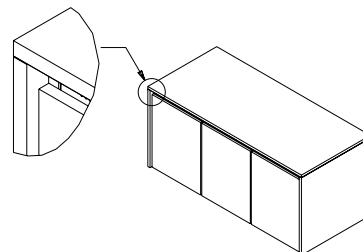
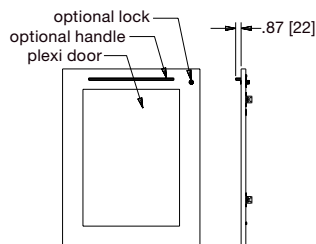

rear view

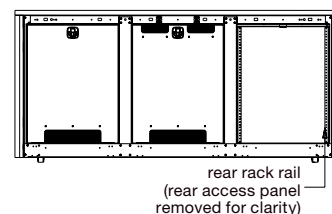

Moderno Style: Thermolaminate

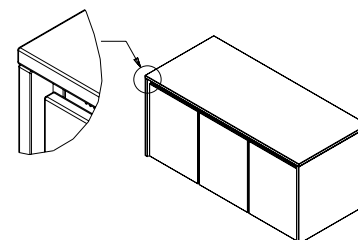
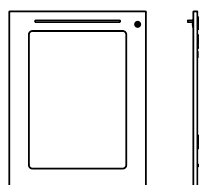
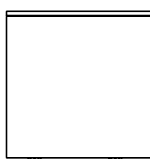
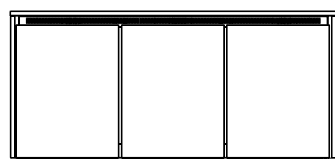

Finishing Kit Number	Door Type	"G" Width	"H" Depth	Compatible With
C5K1A1MPXYY	plexi	24.9 [632]	27.3 [694]	C5-FF27-1
C5K1A1MSXYY	solid			
C5K2A1MPXYY	plexi	47.2 [1199]	27.3 [694]	C5-FF27-2
C5K2A1MSXYY	solid			
C5K3A1MPXYY	plexi	69.6 [1768]	27.3 [694]	C5-FF27-3
C5K3A1MSXYY	solid			
C5K1B1MPXYY	plexi	24.9 [632]	31.1 [790]	C5-FF31-1
C5K1B1MSXYY	solid			
C5K2B1MPXYY	plexi	47.2 [1199]	31.1 [790]	C5-FF31-2
C5K2B1MSXYY	solid			
C5K3B1MPXYY	plexi	69.6 [1768]	31.1 [790]	C5-FF31-3
C5K3B1MSXYY	solid			

Notes:

- To order, full part number must be generated at middleatlantic.com
- 2 Bay credenzas have a left and right door by default, 3 and 1 bay credenzas have left doors by default.

Accessory Part Number	Accessory Type	Color Code
ACC-LOCK1-BK	lock	Black
ACC-LOCK1-MA	lock	Modern Aluminum (Matte Finish)
ACC-LOCK1-WH	lock	White
ACC-HANDLE1-MA	handle	Modern Aluminum (Matte Finish)

X = suffix with V for veneer finish, suffix with H for hpl finish suffix with T for thermolaminate finish
YY = color selection; refer to middleatlantic.com for options

what great systems are built on.™

A brand of **legrand**

Middle Atlantic Products
middleatlantic.com | middleatlantic.ca