

# HORN LOUDSPEAKERS



**SPT5A,  
SP58A**



**SPT15A, SP158A,  
SPT30A+, SP308A+**



**BDT30A\***

Bogen's Horn Loudspeakers offer high efficiency and excellent intelligibility. Rotary switch-selected power taps make installation quick and easy. SPT and BDT models are compatible with 70V and 25V paging systems, SP models are 8-ohm versions. The KFLDS30T is a 70V/25V wide dispersion, high-intelligibility, reentrant type loudspeaker. The IH8A is a paging horn.

## Product Features:

- Maximum speaker power capacities of 7.5, 15, and 30 watts
- Rotary switch-selected power taps on transformer models
- Constant voltage (70V/25V) and 8-ohm versions (KFLDS30T and BDT30A are 70V/25V only)
- Tilt & swivel base for easy positioning
- Sturdy, all-metal construction with mocha enamel finish (KFLDS30T horn flare is constructed of polycarbonate)
- Weatherproof design
- Twin reentrant horns for bi-directional projection (BDT30A only)
- KFLDS30T provides wide-angle projection with a rotatable horn flare

+ For style only, product is larger

\* Some assembly required



**KFLDS30T**



**IH8A**

## Special Protection

The SPT15A, SPT30A, BDT30A and KFLDS30T use a cast aluminum end bell specially designed to make them weatherproof. A rotary selector switch is used to set the specific power tap for the speaker. This switch's entry into the end bell is sealed by a special mounting nut with an integral O-ring. A removable plastic panel protects both the rotary switch and the electrical connections. This panel provides a narrow opening for the speaker wires to exit, reducing the chance of water infiltration.

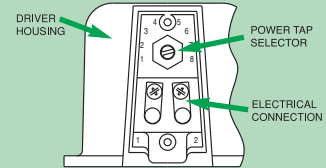

## Tilt & Swivel Base

Bogen's 15- and 30-watt horns include a unique and easy-to-use tilt and swivel mounting base that provides nearly 180 degrees of tilt and a full 360 degrees of swivel. A single wing nut locks in the angle of the speaker. Loosening the wing nut frees the speaker in each rotational axis, making it fast and easy to precisely aim the speakers where the sound is needed. The base provides three holes for screw mounting and a slot to allow strapping the speakers to beams. The actual mounting base can easily be removed so that the base can be installed separately. The speakers can then be attached to the bases at a later time.

Model	Max Power Capacity (Watts)	Frequency Response	Sensitivity (dBspl, 1W @ 4ft.)	Max Sound Level (dBspl, full power @ 4ft.)	Power Taps (Watts)		Low-Impedance 8-ohm	Dispersion Angle (degrees)	Connection	Dimensions	Product Weight
					70V	25V					
SPT5A	7.5	250 Hz-14 kHz	96	105	7.5, 5, 2.5, 1.25, 0.65	1, 0.62, 0.31	No	120°	Wire Lead	6" dia. x 4" D	1.5lb.
SP58A					N/A	N/A	Yes				
SPT15A	15	275 Hz-14 kHz	109	121	15, 7.5, 3.8, 1.8, 0.9	15, 7.5, 1.8, 0.94, 0.46	No	110°	Screw Terminal	9" dia. x 9-1/4" D	4 lb.
SP158A					N/A	N/A	Yes				3 lb.
SPT30A	30	225 Hz-14 kHz	110	125	30, 15, 7.5, 3.7, 1.8	15, 7.5, 3.7, 1.8	No	100°	Screw Terminal	11" dia. x 10-1/2" D	6 lb.
SP308A					N/A	N/A	Yes				5 lb.
BDT30A	30	225 Hz-14 kHz	106**	121**	30, 15, 7.5, 3.7, 1.8	15, 7.5, 3.7, 1.8	No	100°**	Screw Terminal	9-5/8" dia. x 12-1/8" D**	7 lb.
IH8A	15	350 Hz-14 kHz	108	120	N/A	N/A	Yes	130°	Wire Lead	6-1/4" dia. x 6" D	2.5lb.
KFLDS30T	30	300 Hz-12 kHz	104	119	30, 15, 7.5, 3.7, 1.8	15, 7.5, 3.7, 1.8, 0.9, 0.5, 0.25	No	70°(Vert.) x 95°(Horiz.)	Screw Terminal	14-3/8" W x 8-1/4" H x 12-7/8" D	6 lb.

\*\* Each Horn

## Accessories



**BC1**  
Beam Clamp



**TCSPT1**  
Terminal Cover for Conduit  
(For BDT30A, KFLDS30T, SP158A, SP308A, SPT15A, & SPT30A)



**HSES10**  
Horn Speaker Electrical Box Strap (pack of 10)  
(Not for SP58A & SPT5A)

# EASY DESIGN™ SPEAKERS



See pages 17-21 for Easy Design.

Dimensions	Product Weight
13" dia. x 3-1/4" D	3 lb.

## Ceiling Speaker CS1EZ

Bogen's **CS1EZ** is a pre-assembled ceiling speaker comprised of an 8" cone speaker and steel ceiling grille painted with enamel. The CS1EZ includes a volume control knob and rear-mounted screw terminal board for easier electrical connection.

### Product Features:

- 1-watt, single-tap design
- Screw terminal connections for fast installation
- Designed for 70V amplifier output
- 8" cone speaker for excellent audio quality
- Heavy-duty, wire-wound volume control with knob
- 50 Hz-12 kHz frequency response
- 95 dBspl @ 4 ft. /1W input sensitivity
- Off-white finish

## Horn Loudspeakers HS7EZ, HS15EZ, HS30EZ

Bogen's line of **Easy Design Horn Loudspeakers** are made of weatherproof all-metal construction, thereby making them ideal for both indoor and outdoor use in industrial plants, warehouses, schools, construction sites, and recreational areas. All models come with swivel and tilt mounting bases for greater flexibility in setting the angle of projection.



### Product Features:

- 7.5-, 15-, and 30-watt models
- Single-tap design
- HS7EZ features 12" lead wire for electrical connections
- HS15EZ and HS30EZ feature screw terminal connections for fast installation
- Designed for 70V amplifier outputs
- Weatherproof design
- Stepped attenuator volume control
- Tilt and swivel mounting base for flexibility in coverage
- Textured mocha enamel

See pages 17-21 for Easy Design.

Model	Frequency Response	Sensitivity	Dispersion	Dimensions	Product Weight
HS7EZ	250 Hz - 14 kHz	105 dBspl (4 ft./7.5W) input (@1 kHz)	120°	6" dia. x 4" D	2 lb.
HS15EZ	275 Hz - 14 kHz	121 dBspl (4 ft./15W) input (@1 kHz)	110°	9" dia. x 9-1/4" D	4 lb.
HS30EZ	225 Hz - 14 kHz	125 dBspl (4 ft./30W) input (@1 kHz)	100°	11" dia. x 10-1/2" D	6 lb.



See pages 17-21 for Easy Design.

Dimensions	Product Weight
9-1/2" W x 9-1/2" H x 5-1/4" D (3-1/4" D @ bottom)	4 lb.

## Wall Baffle Speaker WB1EZ

The **WB1EZ** comes pre-assembled with an 8" cone speaker enclosed in a simulated walnut-finished wooden enclosure with a black grille cloth on front and a recessed volume control.

### Product Features:

- 1-watt, single-tap design
- Screw terminal connections for fast installation
- Designed for 70V amplifier output
- 8" cone speaker for excellent audio quality
- Recessed volume control
- Designed for easy wall-mount installation; face has 13.5 degree downward angle
- 50 Hz -12 kHz frequency response
- 95 dBspl @ 4ft./1W input sensitivity

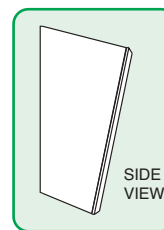

### Accessories

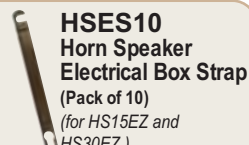
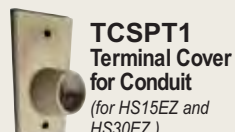
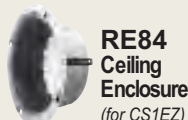
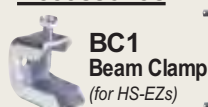

# SELF-AMPLIFIED HORN SPEAKERS

## High-Efficiency, Digital Switching, Horn Loudspeakers

**SAH5** (5W) <sup>CURRENT UNITS</sup> -4, **SAH15** (15W) <sup>CURRENT UNITS</sup> -9, **SAH30** (30W) <sup>CURRENT UNITS</sup> -17

Using digital switching amplifier technology, these **Self-Amplified Horn Loudspeakers** provide unprecedented low DC current draw and heat dissipation, allowing them to use fewer power supplies, run on longer cable runs, and work at higher ambient temperatures than conventional analog self-amplified horn speakers. The shape of the horn's flare provides a controlled dispersion of sound for better intelligibility. The horn can be rotated on its axis, offering wide dispersion patterns, vertically or horizontally, depending on its position. In addition, these weatherproof, plastic horns are extremely durable and rugged. They can be used in any environment, indoors or outdoors, without affecting sound quality.



### Product Features:

- 5-, 15-, and 30-watt models with built-in amplifiers
- All models operate from 24V DC power source
- Digital switching amplifier technology greatly reduces current consumption when compared to conventional analog self-amplified horn loudspeakers
- Low heat dissipation of the digital switching amplifier allows units to operate with continuous background music and in higher ambient temperatures than conventional analog amplifiers
- Excellent extended frequency response from 1.6" diameter voice coil and 90 mm, 12-ounce magnet structure (SAH5/15), or 100mm, 16-ounce magnet structure (SAH30)
- Rotatable horn allows for the use of a wider (120°) vertical or horizontal dispersion pattern
- Predictable dispersion pattern over the full frequency range ensures excellent intelligibility and ease of layout
- Removable access cover protects terminals and volume control
- Weatherproof, UV-protected mocha finish plastic housing
- Simple, secure, cast aluminum swivel mount
- Screw terminal strip for easy wire connections
- Electrical box mounting strap included

### 3 Ways To Position SAH Speakers

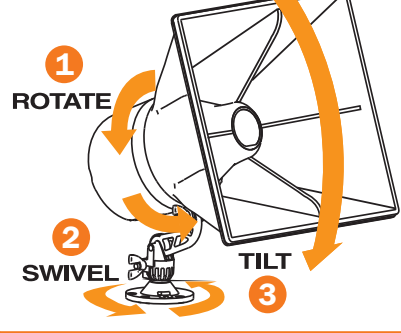

See page 30 to select a Power Supply.



Models	Maximum Power Level	Frequency Response	Maximum dBspl	Dimensions	Product Weight
SAH5	5 watts	275 Hz -14 kHz	119	10-5/8" W x 12" H x 11-1/2" D	6 lb.
SAH15	15 watts		124		
SAH30	30 watts		127		

### Controlled Dispersion

Many horns in the market disperse sound frequencies in a wild and uncontrolled manner. This reduces intelligibility and causes inconsistent sound quality over the horn's coverage angle. Bogen's SAH horns benefit from Bogen's long history as a commercial and

pro audio company. Bogen's SAH horns disperse the various frequencies that make up the sound of a page in a very carefully controlled manner. This means that the listener hears clean, crisp intelligible pages over the full coverage area of the horn.

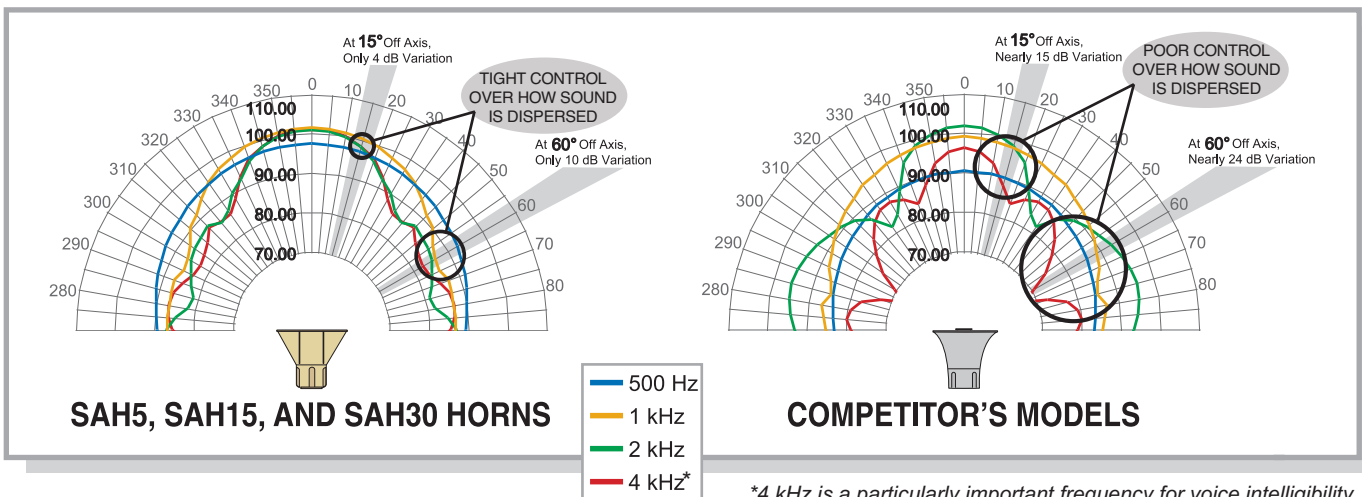

\*4 kHz is a particularly important frequency for voice intelligibility

# SELF-AMPLIFIED METAL HORN SPEAKERS

## Traditional Metal Horn Speakers

**AH5A** (5W) <sup>CURRENT UNITS</sup> -6, **AH15A** (15W) <sup>CURRENT UNITS</sup> -18

The AH5A and AH15A Metal Horn Speakers are rugged, self-contained amplified paging horn assemblies that can be used for high noise paging areas indoors as well as for outdoor use. Their sturdy, weatherproof, all-metal construction allows them to withstand any environment while continuing to provide excellent audio intelligibility for paging and background music.



AH5A



AH15A

### Product Features:

- 5- and 15-watt models with built-in amplifiers
- Screwdriver-adjustable volume controls
- Universal tilt-and-swivel mount
- Banding slots easily secure horns to beams and pillars
- 4-conductor, color-coded cable for quick connections to audio and power sources
- Plastic cover protects volume control and provides cable strain relief
- Self-aligning, field-replaceable diaphragm
- Weatherproof, all-aluminum housing
- Speaker and brackets have textured mocha enamel finish
- 110° dispersion pattern

Dimensions	Product Weight
9" dia. x 9-1/4" "D	4 lb. each

See page 30 to select a Power Supply.

### Accessories



BC1 Beam Clamp

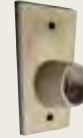

TCSPT1 Terminal Cover for Conduit



HSES10 Horn Speaker Electrical Box Strap (Pack of 10)

### Determine Speaker Quantity

Use the chart for the speaker you will use (AH5A or AH15A):

1. Choose the level of ambient noise in the area to be covered.
2. Locate the area's square footage.
3. Where these two measurements meet are two numbers. The number in **GREEN** is the number of speakers required. The number in **RED** is the number of Current Units (CU) needed for that many speakers. (You may need to increase the number of speakers in areas where large objects or shelving project into the coverage area, blocking sound.)

**Current Units (min.) = Number in RED**



AH5A

HORN QTY. & MIN. CURRENT UNITS (CU) BASED ON AMBIENT NOISE	SIZE OF AREA TO BE COVERED (THOUSANDS OF SQUARE FEET)																			
	5	10	15	20	25	30	35	40	45	50	55	60	65	70	75	80	85	90	95	100
55-65 dB Low Noise – speech is easy	<b>HORNS</b> 1	<b>HORNS</b> 1	<b>HORNS</b> 2	<b>HORNS</b> 2	<b>HORNS</b> 3	<b>HORNS</b> 3	<b>HORNS</b> 4	<b>HORNS</b> 4	<b>HORNS</b> 5	<b>HORNS</b> 5	<b>HORNS</b> 6	<b>HORNS</b> 6	<b>HORNS</b> 7	<b>HORNS</b> 7	<b>HORNS</b> 8	<b>HORNS</b> 8	<b>HORNS</b> 9	<b>HORNS</b> 9	<b>HORNS</b> 10	<b>HORNS</b> 10
	<b>CU</b> 6	<b>CU</b> 6	<b>CU</b> 12	<b>CU</b> 12	<b>CU</b> 18	<b>CU</b> 18	<b>CU</b> 24	<b>CU</b> 24	<b>CU</b> 30	<b>CU</b> 30	<b>CU</b> 36	<b>CU</b> 36	<b>CU</b> 42	<b>CU</b> 42	<b>CU</b> 48	<b>CU</b> 48	<b>CU</b> 54	<b>CU</b> 54	<b>CU</b> 60	<b>CU</b> 60
65-75 dB Medium Noise – must raise voice to be heard	<b>HORNS</b> 1	<b>HORNS</b> 2	<b>HORNS</b> 3	<b>HORNS</b> 4	<b>HORNS</b> 5	<b>HORNS</b> 5	<b>HORNS</b> 6	<b>HORNS</b> 7	<b>HORNS</b> 8	<b>HORNS</b> 9	<b>HORNS</b> 10	<b>HORNS</b> 10	<b>HORNS</b> 11	<b>HORNS</b> 12	<b>HORNS</b> 13	<b>HORNS</b> 14	<b>HORNS</b> 15	<b>HORNS</b> 15	<b>HORNS</b> 16	<b>HORNS</b> 17
	<b>CU</b> 6	<b>CU</b> 12	<b>CU</b> 18	<b>CU</b> 24	<b>CU</b> 30	<b>CU</b> 30	<b>CU</b> 36	<b>CU</b> 42	<b>CU</b> 48	<b>CU</b> 54	<b>CU</b> 60	<b>CU</b> 60	<b>CU</b> 66	<b>CU</b> 72	<b>CU</b> 78	<b>CU</b> 84	<b>CU</b> 90	<b>CU</b> 90	<b>CU</b> 96	<b>CU</b> 102



AH15A

HORN QTY. & MIN. CURRENT UNITS (CU) BASED ON AMBIENT NOISE	SIZE OF AREA TO BE COVERED (THOUSANDS OF SQUARE FEET)																			
	5	10	15	20	25	30	35	40	45	50	55	60	65	70	75	80	85	90	95	100
75-85 dB High Noise – speech is difficult	<b>HORNS</b> 1	<b>HORNS</b> 2	<b>HORNS</b> 3	<b>HORNS</b> 4	<b>HORNS</b> 5	<b>HORNS</b> 5	<b>HORNS</b> 6	<b>HORNS</b> 7	<b>HORNS</b> 8	<b>HORNS</b> 9	<b>HORNS</b> 10	<b>HORNS</b> 10	<b>HORNS</b> 11	<b>HORNS</b> 12	<b>HORNS</b> 13	<b>HORNS</b> 14	<b>HORNS</b> 15	<b>HORNS</b> 15	<b>HORNS</b> 16	<b>HORNS</b> 17
	<b>CU</b> 18	<b>CU</b> 36	<b>CU</b> 54	<b>CU</b> 72	<b>CU</b> 90	<b>CU</b> 90	<b>CU</b> 108	<b>CU</b> 126	<b>CU</b> 144	<b>CU</b> 162	<b>CU</b> 180	<b>CU</b> 180	<b>CU</b> 198	<b>CU</b> 216	<b>CU</b> 234	<b>CU</b> 252	<b>CU</b> 270	<b>CU</b> 270	<b>CU</b> 288	<b>CU</b> 306
85-95 dB Very High Noise – speech almost impossible	<b>HORNS</b> 2	<b>HORNS</b> 4	<b>HORNS</b> 6	<b>HORNS</b> 8	<b>HORNS</b> 10	<b>HORNS</b> 12	<b>HORNS</b> 14	<b>HORNS</b> 16	<b>HORNS</b> 18	<b>HORNS</b> 20	<b>HORNS</b> 22	<b>HORNS</b> 24	<b>HORNS</b> 26	<b>HORNS</b> 28	<b>HORNS</b> 30	<b>HORNS</b> 32	<b>HORNS</b> 34	<b>HORNS</b> 36	<b>HORNS</b> 38	<b>HORNS</b> 40
	<b>CU</b> 36	<b>CU</b> 72	<b>CU</b> 108	<b>CU</b> 144	<b>CU</b> 180	<b>CU</b> 216	<b>CU</b> 252	<b>CU</b> 288	<b>CU</b> 324	<b>CU</b> 360	<b>CU</b> 396	<b>CU</b> 432	<b>CU</b> 468	<b>CU</b> 504	<b>CU</b> 540	<b>CU</b> 576	<b>CU</b> 612	<b>CU</b> 648	<b>CU</b> 684	<b>CU</b> 720

# PRODUCT ACCESSORIES

Model #	Accessory Description	Associated Model(s)	Dimensions	Prod. Wt.	Page #	Images
<b>GSRVC</b>	Remote Volume Control	Gold Seal Series Amps	2-3/4" W x 4-1/2" H x 1-3/8" D	2 oz.	41	
<b>GSTRC</b>	Gold Seal Series Security Cover	Gold Seal Series Amps	14-3/4" W x 3-1/2" H x 1" D	5 oz.	41	
<b>MA3</b>	Module Adapter	D-Series, WMA, DPA Amps	Works with advanced modules	1 lb.	39	
<b>PVMC</b>	Power Vector Module Cover	V-Series Amps, M-Class, VMIX	1-1/2" W x 3-1/8" H x 3/8" D	1 oz.	38, 45, 48	
<b>PVSC</b>	Power Vector Security Cover	V-Series Amps, VMIX	15-1/2" W x 3-1/8" H x 1/2" D	2 oz.	38, 48	
<b>RVCP</b>	Remote Volume Control Panel	V- & WV-Series Amps, VMIX	1-3/4" W x 4" H	2 oz.	38, 40, 48	
<b>TL100</b>	1:1 Ratio Plug-In Transformer	BPA60/HTA125A/HTA250A	1" dia. x 1-1/4" D	1 oz.	46	
<b>TL600</b>	Plug-In: 600-ohm Transformer	BPA60/HTA125A/HTA250A	1" dia. x 1-1/4" D	1 oz.	46	

Model #	Accessory Description	Associated Model(s)	Dimensions	Prod. Wt.	Page #	Images
<b>108-2120</b>	Yoke Assembly	AMT-12	24-1/2" W x 12" H x 3" D	7 lb.	1	
<b>108-2150</b>	Yoke Assembly	AMT-15	27-1/4" W x 13" H x 3" D	8 lb.	1	
<b>109-2140</b>	Rigging Beam Assembly	AMT Series	22" W x 3" H x 2" D	15 lb.	1	
<b>109-2151</b>	Rigging Kit	AMT Series	10" W x 1-1/2" H x 1/4" D	2 lb.	1	
<b>AT570GB</b>	Tripod Speaker Stand	AMT Series, BP-Series	H: 50"-77"; Base dia.: 40"	6 lb.	1	
<b>BBF</b>	Back Box for Flush Mounting	WV-Series	14-1/2" W x 24-3/4" H x 3-7/8" D	12 lb.	40	
<b>BBS</b>	Back Box for Surface Mounting	WV-Series	16-1/4" W x 26-3/4" H x 3-7/8" D	16 lb.	40	
<b>BC1</b>	Beam Clamp	Horn Loudspeakers	2-1/8" W x 2" H x 3/4" D	6 oz.	13, 16, 26, 28	
<b>CK10</b>	Cable Kit (Silver)	HFCS1/OCS1/OPS1/HFSF1/CSUB/MPS1/MPS2	10 feet long	4 oz.	2, 6, 7	
<b>CK10B</b>	Cable Kit (Black)	OPS1B/MPS1B/MPS2B	10 feet long	4 oz.	2, 6	
<b>CK10W</b>	Cable Kit (Off-White)	OPS1W/MPS1W/MPS2W	10 feet long	4 oz.	2, 6	
<b>GSRPK</b>	Rack Kit	Gold Seal Series Amps	1-1/4" W x 3-1/2" H x 10-1/4" D	2 lb.	41	
<b>HSES10</b>	Horn Speaker Electrical Box Strap	Horn Speakers**	1/2" W x 5-1/2" long	3 oz.	13, 16, 28	
<b>MR8</b>	Mounting Ring	S86, S810, CS1EZ, ASWG1/DK	12" dia. x 3/4" D	15 lb.*	11, 16, 23	
<b>RE84</b>	Round Enclosure	S86, S810, CS1EZ, ASWG1/DK	12-1/4" dia. x 4-1/2" D	24 lb.*	11, 16, 23	
<b>RK78</b>	Rack Panel Kit	CDR1	19" W x 3-1/2" H x 7" D	3 lb.	57	
<b>RMPWMK3</b>	Remote Panel Mounting Kit	PM3180	9-1/8" W x 4-3/4" H x 3/4" D	2 lb.	47	
<b>RPK35B</b>	Rack Panel Kit	C10/C20/CAM2	19" W x 3-1/2" H x 6-1/2" D	3 lb.	42, 50	
<b>RPK50</b>	Rack Mount Kit	C35/C60/C100	2-1/2" W x 3-1/2" H x 2-1/8" D	10 oz.	42	
<b>RPK53</b>	Rack Mount Kit	BPA60	2" W x 3-1/2" H x 1" D	7 oz.	46	
<b>RPK79</b>	Rack Mount Kit	PM3180	1" W x 5-1/4" H x 3-1/2" D	14 oz.	47	
<b>RPK82</b>	Rack Mount Kit	TPU35B/60B/100B	3" W x 8-3/4" H	14 oz.	43	
<b>RPK84</b>	Rack Mount Kit	PCM2000	7" W x 8" H	2 lb.	35	
<b>RPK86</b>	Rear Rack Support Brackets	M-Class/Black Max Amplifiers	3-3/4" W x 3-1/2" H	7 oz.	44, 45	
<b>RPK87</b>	Rack Mount Kit	V-Series, VMIX	1" W x 3-1/2" H x 3-3/4" D	1 lb.	38, 48	
<b>RPK88</b>	Rack Mount Kit	PCM2000	19" W x 10-1/2" H x 2" D	3 lb.	35	
<b>RPK89</b>	Rack Mount Kit (Single)	UDR800	2 Pieces; 1 Rack Space	6 oz.	58	
<b>RPK90</b>	Rack Mount Kit (Double)	UDR800	3 Pieces; 1 Rack Space	4 oz.	58	
<b>RPK91</b>	Rack Mount Kit	TAMB2/TAMB2PS	2 Pieces; 1 Rack Space	7 oz.	32	
<b>RPK93</b>	Rack Mount Kit	CC-Series	1-1/4" W x 3-1/2" H x 8-1/4" D	2 lb.	37	
<b>RPKUT1</b>	Rack Mount Kit/Security Cover	UT11	19" W x 5-1/4" H x 2-3/8" D	2 lb.	31	
<b>SMTB</b>	Tile Bridge for Easy Install Speakers	ASM1, SM1EZ/SM4T	4-3/8" W x 1-1/4" H x 23-3/4" D	5 lb.*	15, 24	
<b>TB8</b>	Tile Bridge	S86, S810, CS1EZ, ASWG1/DK	23-3/4" W x 3/4" H x 14-1/2" D	17 lb.*	11, 16, 23	
<b>TBCR</b>	Tile Bridge Support Ring	HFCS1/OCS1	17" W x 1-1/8" H x 24" D	2 lb.	2, 6	
<b>TBSF</b>	Tile Bridge	HFSF1, SEC4T	10" W x 1/2" H x 24" D	14 oz.	7, 11	
<b>TCSPT1</b>	Terminal Cover for Conduit	Horn Speakers***	1-3/4" W x 3" H x 1-1/4" D	2 oz.	13, 16, 28	
<b>TMA812</b>	Tilt Mount Adapter	A12 & A8	7" W x 4-3/4" H x 4-1/2" D	2 lb.	5	
<b>WMAD</b>	Door for WV-Series Amps	WV-Series	16-1/4" W x 26-3/4" H x 1" D	9 lb.	40	
<b>WMK1</b>	Wall Mounting Kit	C10/C20/CAM2	14-1/2" W x 16" H x 4" D	10 lb.	42, 50	

\*Weight based on per carton. Check with Bogen for quantity per carton.

\*\*Horn Speakers: AH5A, AH15A, BDT30A, HS15EZ, HS30EZ, IH8A, KFLDS30T, SP158A, SP308A, SPT15A, & SPT30A.

\*\*\*Horn Speakers: AH5A, AH15A, BDT30A, HS15EZ, HS30EZ, KFLDS30T, SP158A, SP308A, SPT15A, & SPT30A.