

SHALLOW DEPTH FLOOR CLOSERS

SINGLE ACTING CENTER HUNG

RIXSON®
ASSA ABLOY

MODEL 50

Application

- Single Acting, Handed
- Interior Doors
- Centering Arm
- Weight to 250 lbs.
- Door Sizes up to 4'0" x 8'0" (1219 x 2438mm)



ANSI/CO6022

Product Description & Features

- Centering arm with adjustment screws in faces of door
- Interchangeable spindle adapters
- Separate and independent valves for closing speed, latch speed and backcheck
- Available non-hold open (NBC) or automatic hold open (ABC) specify 90° or 105°
- Delayed action option – prefix "DA" (non-hold open only). Closers will not have backcheck
- Order spring sizes 3 through 5:

Model	Door Width
5013	36" (914mm)
5014	42" (1067mm)
5015	48" (1219mm)
- Models available to meet ICC/ANSI A117.1 low opening force requirements. Prefix "PH"

Model	Door Width
PH5012	42" (1067mm)
PH5013	48" (1219mm)
- Available with floor plate or threshold installation (floor plate shown)
- Cyclac, rustproof cement case
- Arm reinforcement bracket for wood doors prefix "W"
- Standard top pivot #340 included
- Not allowed for fire rated doors
- Frame stop required at lock edge. If not supplied by frame manufacturer, recommend use of 60131 (see Door Control Accessories, page 8)
- Furnished with wood and machine screws
- Extended spindles available in 1/2" increments up to 2" longer than standard

Technical Information

Frame stop required at lock edge

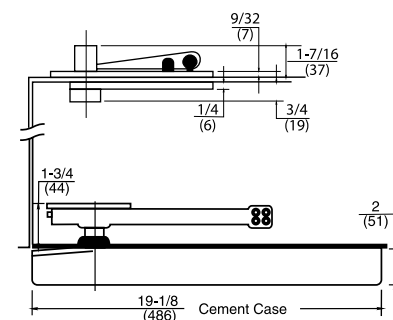
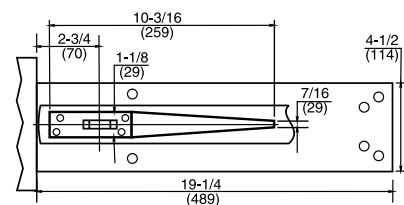

Door edges must be radiused

SHALLOW DEPTH FLOOR CLOSERS

QUICK REFERENCE OF OPTIONS/HOW TO ORDER

REFERENCE

Prefix	Model	Degree if Hold Open	Holding Options	General Options	Handed	Maximum Weight*
DA, PH, F	51	90,105,180	NBC, ABC	Ext Spdl, 1-1/2 OS, -20	Yes	250
	F53		NBC	Extended Spindle	Yes	250
	F531		NBC	Extended Spindle	Yes	250
DA, PH, F	Q/QT51	90,105	NBC, ABC	Ext Spdl, -20	Yes	250
DA, PH, F	HM51	90, 105	NBC, ABC	Extended Spindle	Yes	250
DA, PH	50	90,105	NBC, ABC	Extended Spindle	Yes	250
DA, PH	5040	90,105	NBC, ABC	Extended Spindle	Yes	250
DA, PH	5020	90,105	NBC, ABC	Extended Spindle	No	250

*Offset closer weight are for 3/4" and the use of an intermediate pivot.

HOW TO ORDER

PH Prefix	510 Model	3 Spring Size	NBC Non-Hold Open	x 1/2" Ext Spdl Suffix	x LH Hand	x 626 Finish
DA Delayed Action PH Lighter Spring (ADA) W Vd Dr (center hung) F Fire Rated Doors — not available with PH	510 Offset 501 Center Hung Single Act F530 Independently Hung* Parallel to Frame F531 Independently Hung* Perpendicular to Frame 504 Center Hung Single Act with Patch Fitting 502 Center Hung Double Act Q/QT510 Quick Install HM510 Hollow Metal Door and Frame	2 3 4 5	NBC Non-Hold Open 90ABC Automatic Hold Open 105ABC Automatic Hold Open 180ABC Automatic Hold Open	554 Concealed Arm — Extended Spindles 1-1/2" Offset -20 20 Minute Label LAP Closer Body Only LFP Less Floor Plate LCC Less Cement Case LTP Less Top Pivot — Cover Pan (x depth) SPLO Special Layout #	RH Right LH Left Blank Double Acting	605 Bright Brass 606 Satin Brass 611 Bright Bronze 612 Satin Bronze 613 Dark Bronze 613E Dark Oxidized Satin Bronze - equivalent 618 Bright Nickel 619 Satin Nickel 622 Flat Black 625 Bright Chrome 626 Satin Chrome

*Hanging means must be noted on purchase order.

5040 only available in 605, 629 and 630