

Interchangeable Core

Best Compatible (Small Format)

► 724VR Medical Cart File Cabinet Lock

See also page 43:
720B-DM Medical Cart/
Direct Drive Cam Lock

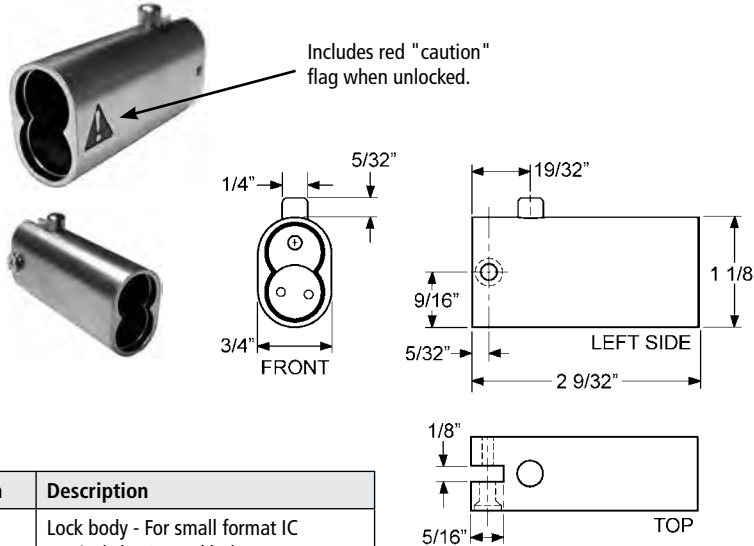

Item	Finish	Description
724VR	26D	Lock body - For small format IC Vertical slot / round bolt
Note: Includes red "caution" flag when unlocked.		

SPECIFICATIONS

Retrofits: Best 2P73

Use: Commonly used as locking device on medical carts (see also our B7 cam lock which is also commonly used on medical carts)

Open indicator: Includes red "caution" flag when unlocked.

Mounting slot: Vertical

Bolt type: Round spring bolt

Material: Zinc die cast

Finish: 26D

Packaged: Packed 10 per box

KEYING INFORMATION

Cores: Not included

Accepts: Best, Arrow, Falcon, KSP, Schlage SFIC or equivalent small format interchangeable cores

Compatible electronic cylinders: Medeco Nexgen XT or VIDEX CyberLock SFIC cylinders

INCLUDED ACCESSORIES

725-1 spacer to fit 6 or 7 pin cores

725-PA plastic thumbturn

OPTIONAL ACCESSORIES

SFIC cores: 206/207 Series (page 53)

► 728MBL Mail Box Lock

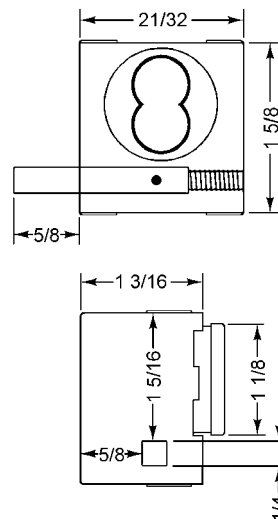

Item	Finish	Size	Description
728MBL	26D	Adjustable	Lock body - For small format IC

SPECIFICATIONS

Retrofits: Best 8L

Handing: RH standard

Installation: Fits most common metal mail box door designs

Material: Zinc die cast cylinder housing, steel body

Size: Adjustable

Finish: 26D

Packaged: Packed 10 per box

KEYING INFORMATION

Cores: Not included

Accepts: Best, Arrow, Falcon, KSP, Schlage SFIC or equivalent small format interchangeable cores

Compatible electronic cylinders: Medeco Nexgen XT or VIDEX CyberLock SFIC cylinders

OPTIONAL ACCESSORIES

SFIC cores: 206/207 Series (page 53)