

STOCK[®] LOCKS

**Through your CompX National distributor
... a program to meet your lock requirements.**

CompX National manufactures a wide variety of locks for residential, commercial and industrial use. We've been solving security problems since the need for metal cabinet locks brought about the founding of our company in 1903.

The locks shown in this catalog are particularly well-suited to serve the replacement market...as well as component manufacturers. They have been proven in use.

Our experience in serving this market has shown us the importance of product quality, competitive pricing, proper packaging and immediate service and delivery. Working through your CompX National distributor, we offer a program that is committed to serving your needs.

A complete selection of locks

- Door and drawer locks for virtually every application, every security requirement.
- Wide variety of mail box locks.
- Locking devices of every description for use in schools, institutional and commercial buildings.
- Key blanks and keying kits to complement each of our locks.

Packaged for your convenience

- All hardware is individually packed in see-thru poly-bags for product protection and easy inspection.
- Poly-bags of like hardware are grouped in popular quantities and placed in handy cases.
- Case designed for convenience in storage and ease in handling.
- Cases are labeled for quick identification.



how cabinet locks are used

DOOR APPLICATION

Bolt or cam at side locks to frame.

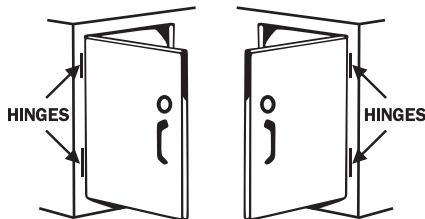

LEFT HAND

RIGHT HAND

At which edge of door hinges are located determines hand of door when facing door.

LID APPLICATION

Lock engages strike mounted on underside of lid.



SLIDING (By-pass) DOOR APPLICATION

Lock engages strike mounted on rear door.

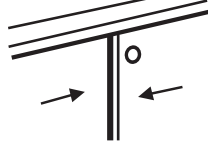

SINGLE DRAWER APPLICATIONS

Drawer mounted lock – Bolt or cam locks on frame.

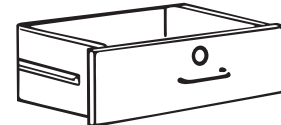

Frame mounted lock – Cam locks on back of drawer front with hook cam engaging strike.

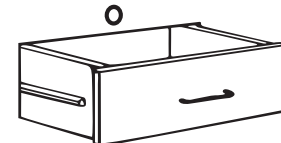

MULTIPLE DRAWER APPLICATIONS (Wood construction)

PEDESTAL/FILE

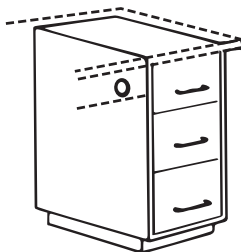

Side mounted gang lock – vertical bar movement locks all drawers simultaneously.

DESK

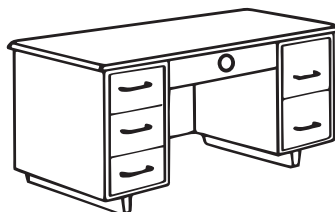

Center drawer mounted lock – Bolt locks on frame or top. Side drawer mechanism(s) actuated by locked center drawer secures drawers.

PEDESTAL/FILE

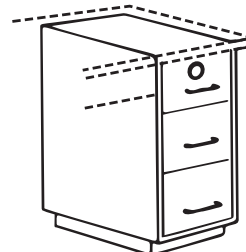

Top drawer mounted lock activates side mechanism securing other drawers.

LATERAL FILE

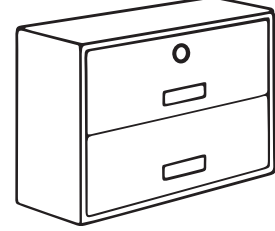

Top drawer mounted lock activates side mechanisms securing other drawer(s); also allows only opening one drawer at a time.

finish codes

Finish code applies to exposed portions of lock and is indicated by part number suffix, i.e.: C8053-3 Bright Brass finish.

2C – Zinc Plated
3 – Bright Brass
4 – Satin Brass

4G – Antique Brass
14A – Bright Nickel
19 – Black

26 – Bright Chrome
26D – Dull Chrome (brushed)

key codes

Key codes stamping may appear with or without zeros preceding other numbers, i.e.: C001A and C1A are the same key code.

disc tumbler drawer locks



C8701

APPLICATION – C8701: for center drawers of metal desks. Fits special piercing of drawer front and selvage (see drawing). C8896 is a specific replacement lock.

OPERATION – Key removable in both locked and unlocked positions.

KEYING – C8701 will key together with all other disc tumbler locks using D8785 key blank. See table for available keying. Master keying to E41A using D8783 key blank.

PACKAGING – Supplied with two keys. C8701 furnished with mounting nut.

Part No.: M503441026X150J – Replacement insertable bolts for C8701.



C8896

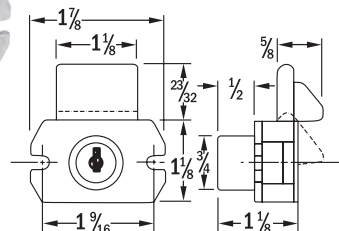

Part No.	Installation	Bolt Type	Cylinder Length	Bolt Travel	KA* Codes	Key Changes		Case Quantity	Reference Number	Key Blank
						KD	MKGD			
C8701-14A	Metal Drawer, 1/4" max. mat'l. thickness	Reinforced Insertable Dead Bolt	19/32"	11/32"	6	200	200	25	M4-0344-001	D8785
C8896-26D	Desk Drawer	Dead	1/2"	5/8"	1	50	—	10	M4-5596-001	D8785

disc tumbler sliding door locks



C8042

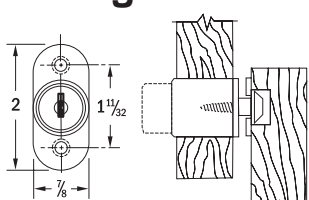

C8043

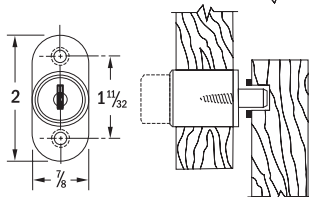

APPLICATION – C8040 for glass sliding by-pass doors up to 1/4" thick. C8042 and C8043 for wood sliding doors - requires a 7/8" diameter hole in front door.

OPERATION – C8040: key removable in locked position only. C8042: push in cylinder, key turn engages bolt behind strike. C8043: pushing in cylinder locks doors. Key removable in both locked and unlocked positions.

KEYING – Will key together with all other disc tumbler locks using D8785 key blank. See table for keying. Master keying to E41A using D8783 key blank.

PACKAGING – C8040 supplied with two keys and felt pad to be applied to back of lock body. C8042 and C8043 supplied with two keys, strike and mounting screws. If trim ring is required, order C2017 separately - see page 22.



C8040
NEW!

Part No.	Installation	Bolt Type	Cylinder Length	Bolt Travel	KA* Codes	Key Changes		Case Quantity	Reference Number	Non MK Key Blank
						KD	MKGD			
NEW! C8040-14A	Sliding Glass Doors	Bolt	N/A	N/A	6	200	200	10	N/A	D8785
C8042-26D	Sliding Doors	90° Turn Hook	7/8"	7/16"	3	200	—	10	M4-0057-001	D8785
C8043-26D	Sliding Doors	Plunger	1"	7/16"	6	200	200	10	M4-0055	D8785
C8043-3	Sliding Doors	Plunger	1"	7/16"	6	200	—	10	M4-0055	D8785
C8043-14A	Sliding Doors	Plunger	1"	7/16"	6	200	—	10	M4-0055	D8785

*Key Codes used: 1 Code – C415A • 3 Codes – C346A, C413A and C415A • 6 Codes – C346A, C390A, C413A, C415A, C420A and C642A.

disc tumbler file cabinet locks



C8047

APPLICATION – Used internally on filing cabinets to gang lock drawers.

OPERATION – Key removable in locked position only.

KEYING – Keyed only to "Pundra" keyway. See table for available keying.

PACKAGING – Supplied with two keys.

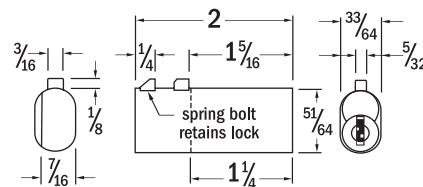

REPLACEMENT FOR
"SHAW WALKER"

Part No.	Installation	Bolt Type	Bolt Travel	KA* Codes	Key Changes		Case Quantity	Key Blank
					KD	MKGD		
C8047-26--	Filing Cabinet	Spring	1/8"	1	200	—	10	D8776

* Key Codes used: 1 Code – P141A.