

# STOCK LOCKS

Through your CompX National distributor . . . a program to meet your lock requirements.

CompX National manufactures a wide variety of locks for residential, commercial and industrial use. We've been solving security problems since the need for metal cabinet locks brought about the founding of our company in 1903.

The locks shown in this catalog are particularly well-suited to serve the replacement market...as well as component manufacturers. They have been proven in use.

Our experience in serving this market has shown us the importance of product quality, competitive pricing, proper packaging and immediate service and delivery. Working through your CompX National distributor, we offer a program that is committed to serving your needs.

## A complete selection of locks

- Door and drawer locks for virtually every application, every security requirement.
- Wide variety of mail box locks.
- Locking devices of every description for use in schools, institutional and commercial buildings.
- Key blanks and keying kits to complement each of our locks.

## Packaged for your convenience

- All hardware is individually packed in see-thru poly-bags for product protection and easy inspection.
- Poly-bags of like hardware are grouped in popular quantities and placed in handy cases.
- Case designed for convenience in storage and ease in handling.
- Cases are labeled for quick identification.



## how cabinet locks are used

### DOOR APPLICATION

Bolt or cam at side locks to frame.

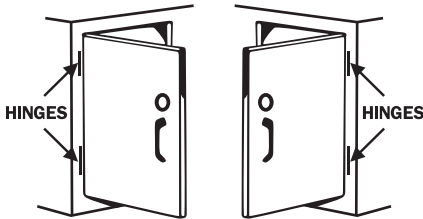

LEFT HAND

RIGHT HAND

At which edge of door hinges are located determines hand of door when facing door.

### LID APPLICATION

Lock engages strike mounted on underside of lid.

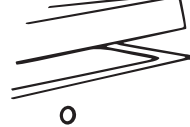

### SLIDING (By-pass) DOOR APPLICATION

Lock engages strike mounted on rear door.

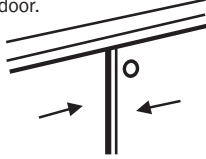

### SINGLE DRAWER APPLICATIONS

Drawer mounted lock – Bolt or cam locks on frame.

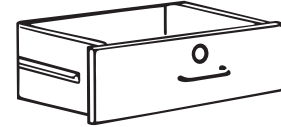

Frame mounted lock – Cam locks on back of drawer front with hook cam engaging strike.

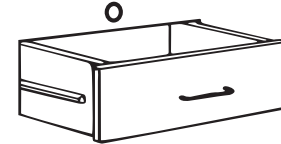

### MULTIPLE DRAWER APPLICATIONS (Wood construction)

#### PEDESTAL/FILE

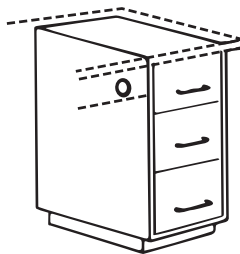

Side mounted gang lock – vertical bar movement locks all drawers simultaneously.

#### DESK

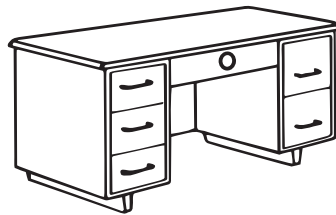

Center drawer mounted lock – Bolt locks on frame or top. Side drawer mechanism(s) actuated by locked center drawer secures drawers.

#### PEDESTAL/FILE

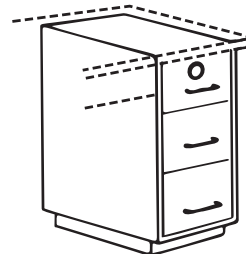

Top drawer mounted lock activates side mechanism securing other drawers.

#### LATERAL FILE

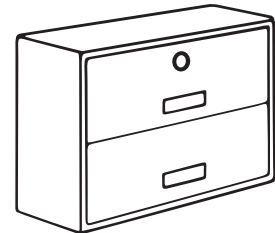

Top drawer mounted lock activates side mechanisms securing other drawer(s); also allows only opening one drawer at a time.

## finish codes

Finish code applies to exposed portions of lock and is indicated by part number suffix, i.e.: C8053-3 Bright Brass finish.

2C – Zinc Plated  
3 – Bright Brass  
4 – Satin Brass

4G – Antique Brass  
14A – Bright Nickel  
19 – Black

26 – Bright Chrome  
26D – Dull Chrome (brushed)

## key codes

Key codes stamping may appear with or without zeros preceding other numbers, i.e.: C001A and C1A are the same key code.

# pin tumbler drawer locks

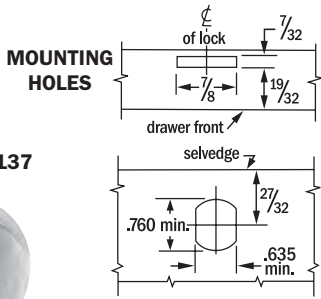

## New – C8137 lock with STAINLESS STEEL bolt!

The stainless steel bolt withstands a higher degree of abuse and is a direct replacement for existing C8137 with die-cast bolts.

**APPLICATION** – For center drawers of metal desks. Fits special piercing of drawer front and selvage (see drawing).

**OPERATION** – Key removable in both locked and unlocked positions.

**KEYING** – Will key together with all other pin tumbler locks using D4291 key blank except locks shown on pages 8 & 9. See table for available keying. Master keying to GM1.

**PACKAGING** – Supplied with two keys, mounting nut and stainless steel insertable bolt.

**Part No.:** C7137 – Stainless steel replacement insertable bolts. Sold in bags of 10.

M337272116X150J – Die-cast replacement insertable bolts.

Part No.	Installation	Bolt Type	Cylinder Length	Bolt Travel	KA* Codes	Key Changes		Case Quantity	Reference Number	Key Blank
						KD	MKKD			
C8137-26D	Metal Drawer, 1/4" Max Mat'l Thickness	Stainless steel Insertable Dead Bolt	19/32"	7/16"	4	850	650	10	M2-3727-001	D4291

\*Key Codes used: 4 Codes – 101, 103, 107 and 915.

# pin tumbler sliding door, file cabinet locks



C8142  
C8143

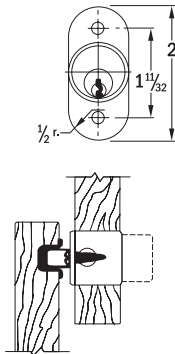

**APPLICATION** – C8140 is for sliding glass doors. C8142 and C8143 are for wood sliding doors and require a 7/8" diameter hole in front door for cylinder. C8150 is used internally on filing cabinets to gang lock drawers.

**OPERATION** – C8140 and C8150: key removable in locked position only. C8142 and C8143: key removable in both locked and unlocked positions.

**KEYING** – Will key together with all other pin tumbler locks using D4291 key blank except locks shown on pages 8 & 9. See table for available keying. Master keying to GM1.

**PACKAGING** – Supplied with two keys. C8142 and C8143 furnished with strike and mounting screws. If trim ring is required, order C2017 separately. See page 22.



C8150

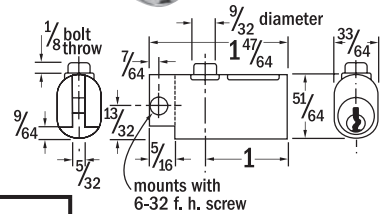

mounts with 6-32 f. h. screw

Part No.	Installation	Bolt Type	Cylinder Length	Bolt Travel	KA* Codes	Key Changes		Case Quantity	Reference Number	Key Blank
						KD	MKKD			
C8140-26D	Plate Glass Sliding Doors	Internal Spring	—	—	4	100	—	10	M2-0225-001	D4291
C8142-26D	Sliding Doors	Plunger	1-1/8"	7/16"	6	100	100	10	M2-3707-157	D4291
C8142-4	Sliding Doors	Plunger	1-1/8"	7/16"	2	100	—	10	M2-3707-157	D4291
C8143-26D	Sliding Doors	Plunger	1-3/8"	7/16"	4	100	—	10	M2-3707-160	D4291
C8143-4	Sliding Doors	Plunger	1-3/8"	7/16"	2	100	—	10	M2-3707-160	D4291
C8150-26D	Filing Cabinet	Spring	—	1/8"	5	850	—	10	M2-4847-001	D4291

\*Key Codes used: 2 Codes – 107 and 915.  
4 Codes – 101, 103, 107 and 915.  
5 Codes – 101, 102, 103, 107 and 915.  
6 Codes – 101, 103, 105, 106, 107 and 915.



C8140

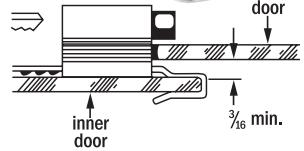

# pin tumbler knob locks

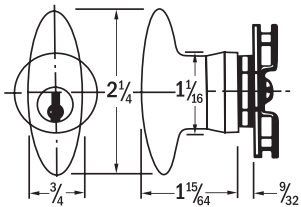

**APPLICATION** – For metal cabinets doors. Reversible for R.H. or L.H. application. Latch plate is used for either in 2\*\* or 3 point latching.

**OPERATION** – 90° turn to open. Choice of key operation, see table.

**KEYING** – Will key together with all other pin tumbler locks using D4291 key blank except locks shown on pages 8 & 9. See table for available keying. Master keying to GM1.

**PACKAGING** – Supplied with two keys, mounting nut and screw for latch plate.

\*\*Install with tongue pointing away from jamb.

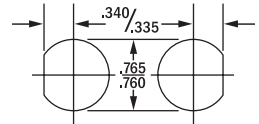

L.H. Door R.H. Door  
MOUNTING HOLES



C8154, C8155

Part No.	Installation	Operation of Key	Maximum Material Thickness	KA* Codes	Key Changes KD	Case Quantity	Reference Number	Key Blank
C8154-26D	Door	Key Removable in Both Locked and Unlocked Positions	1/8"	3	650	10	M2-0721-010 w/M3-6921	D4291
C8155-26D	Door	Key Removable in Locked Position Only	1/8"	1	650	10	M2-0721-060 w/M3-6921	D4291

\*Key Codes used: 1 Code – 915.  
3 Codes – 103, 107 and 915.