



S-3-CPUSE-H-Ni6

Three-way Reactive Power Splitter, 555–2700 MHz

General Specifications

Brand	Andrew®
Device Type	Splitter
Interface	N Female
Color	Silver

Electrical Specifications

Operating Frequency Band	555 – 2700 MHz
3rd Order IMD	-160 dBc
3rd Order IMD Test Method	Two +43 dBm carriers
Average Power, maximum	300 W
Impedance	50 ohm
Insertion Loss at Frequency Band	0.2 dB @ 555–2700 MHz
Peak Power, maximum	3 kW
Power Rating, Splitting	300 W
Reflected Power, maximum	300 W
Return Loss, minimum	20.8 dB
Split Loss	4.8 dB
VSWR	1.2:1

S-3-CPUSE-H-Ni6

Outline Drawing

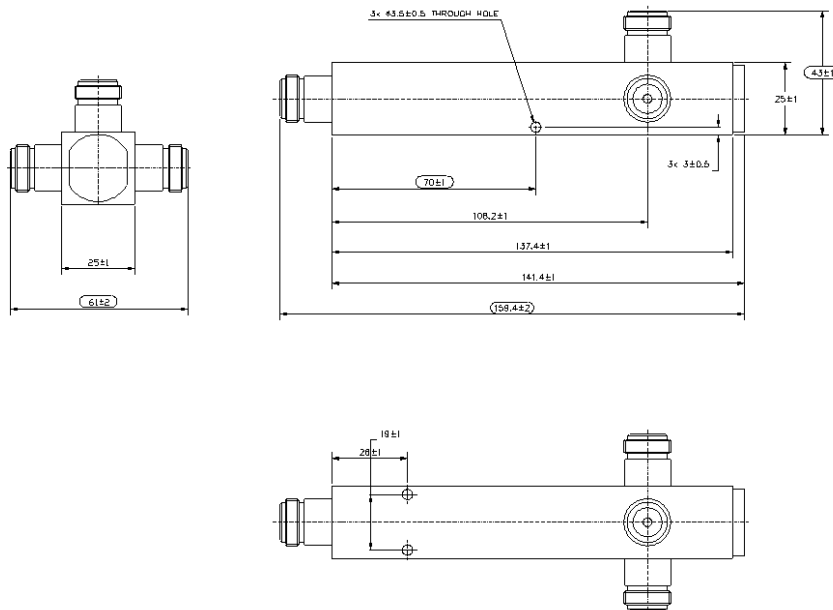

Mechanical Specifications

Coupling Nut Proof Torque	4.50 N-m 3.32 ft lb
Inner Contact Plating	Silver
Outer Contact Plating	Trimetal

Environmental Specifications

Application	Indoor/Outdoor
Ingress Protection Test Method	IEC 60529:2001, IP65
Operating Temperature	-35 °C to +85 °C (-31 °F to +185 °F)
Relative Humidity	Up to 100%

Dimensions

Height	43.00 mm 1.69 in
Length	159.00 mm 6.26 in
Width	61.00 mm 2.40 in
Net Weight	300.00 g 0.66 lb

Packed Dimensions

Height	65.0 mm 2.6 in
Length	170.0 mm 6.7 in
Width	110.0 mm 4.3 in
Shipping Weight	380.00 g 0.84 lb
Volume	1215.5 cc

Regulatory Compliance/Certifications

Product Specifications



S-3-CPUSE-H-Ni6

Agency

ISO 9001:2008

Classification

Designed, manufactured and/or distributed under this quality management system