



H-3-CPUSE-D-Ai6

Air Dielectric Hybrid Coupler, 555–2700 MHz

General Specifications

Brand	Andrew®
Device Type	Hybrid
Interface	7-16 DIN Female
Color	Silver

Electrical Specifications

Operating Frequency Band	555 – 2700 MHz
3rd Order IMD	-160 dBc
3rd Order IMD Test Method	Two +43 dBm carriers
Average Power, maximum	200 W
Coupling	3.1 dB
Coupling Tolerance	±0.6 dB @ 698–2700 MHz ±1.2 dB @ 555–698 MHz
Impedance	50 ohm
Insertion Loss at Frequency Band	0.2 dB @ 555–2700 MHz
Isolation at Frequency Band	26 dB @ 555–2700 MHz
Peak Power, maximum	1 kW
Reflected Power, maximum	200 W
Return Loss, minimum	20.8 dB
VSWR	1.2:1

H-3-CPUSE-D-Ai6

Outline Drawing

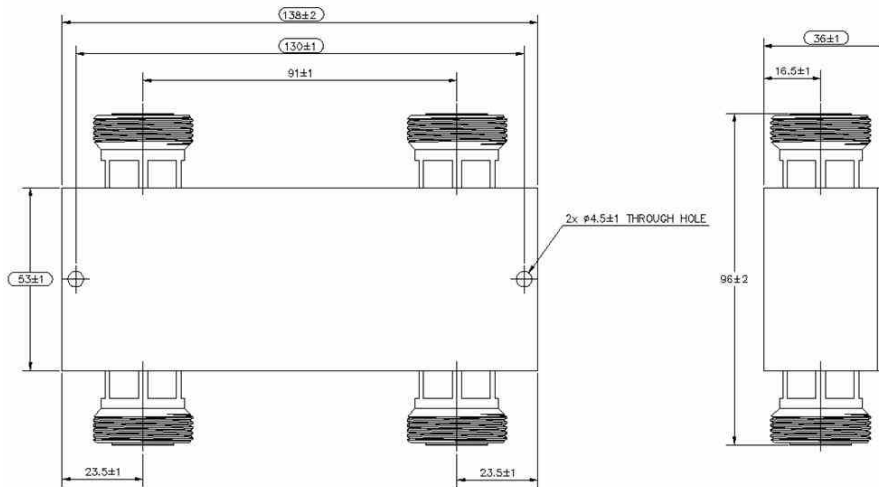

Mechanical Specifications

Coupling Nut Proof Torque	25.00 N-m		18.44 ft lb
Inner Contact Plating	Silver		
Outer Contact Plating	Trimetal		

Environmental Specifications

Application	Indoor/Outdoor
Ingress Protection Test Method	IEC 60529:2001, IP65
Operating Temperature	-35 °C to +85 °C (-31 °F to +185 °F)
Relative Humidity	Up to 100%

Dimensions

Height	36.00 mm		1.42 in
Length	138.00 mm		5.43 in
Width	96.00 mm		3.78 in
Net Weight	0.90 kg		1.98 lb

Packed Dimensions

Height	60.0 mm		2.4 in
Length	170.0 mm		6.7 in
Width	110.0 mm		4.3 in
Shipping Weight	1.00 kg		2.20 lb
Volume	1122.0 cc		

Regulatory Compliance/Certifications

Agency	Classification
ISO 9001:2008	Designed, manufactured and/or distributed under this quality management system