

SW2010

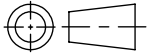

Revision level		Revision Record	Changed	Date	Approved	Date
Drawing	Part					
04	-	SEE ECN# 012399	AAC	06/01/2011	AAC	07/08/2013

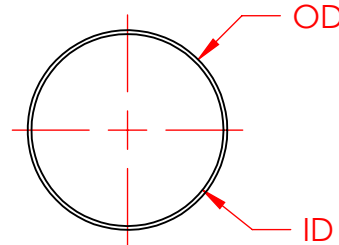
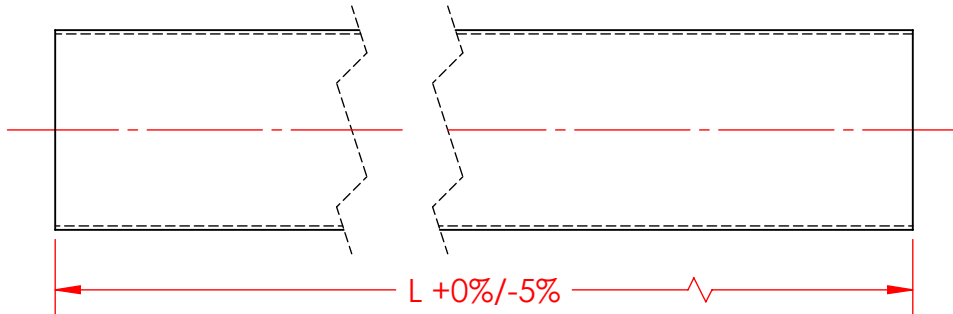
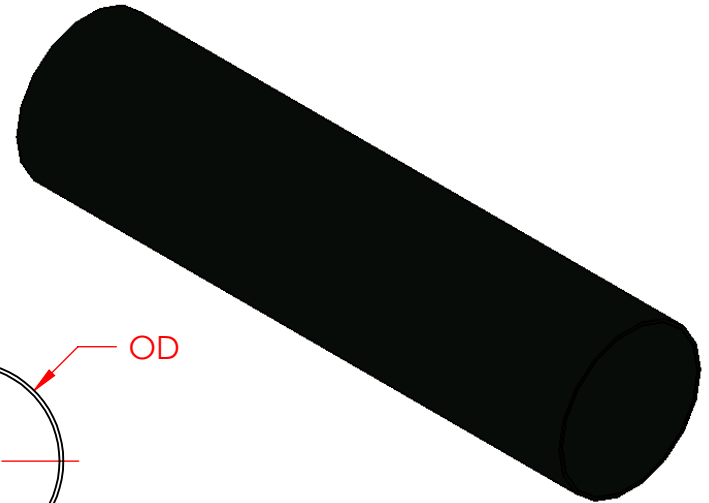

PRODUCT CODE DESCRIPTION

BSP12_

COLOR
(CONSULT FACTORY FOR AVAILABLE COLORS)



NOMINAL SIZE	TYPE	OD	ID	EXPANSION RANGE (FOR REF ONLY)		L (FT)	BULK L (FT)
				MINIMUM	MAXIMUM		
1/8	BSP18_	.175	.125	.0937	.25	225	1000
1/4	BSP14_	.30	.25	.125	.4375	200	1000
1/2	BSP12_	.55	.50	.25	.75	100	500
3/4	BSP34_	.80	.75	.50	1.25	75	250
1	BSP100_	1.05	1.00	.625	1.625	65	250
1-1/4	BSP114_	1.30	1.25	.75	1.75	50	250
1-1/2	BSP112_	1.55	1.50	1.00	2.125	40	-
1-3/4	BSP134_	1.80	1.75	1.25	2.75	-	800
2	BSP200_	2.05	2.00	1.50	3.50	-	200



Material	PET
----------	-----

Units	inches
Dimension without tolerances details to:	.xxxx = ±.0005 .xxx = ±.005 .xx = ±.01 .x = ±.03 None = ±.06 ∠ = ±0.5°

The copyright of this drawing is reserved by HellermannTyton. It is issued on condition that it is not reproduced, copied, or disclosed to a third party, either wholly or in part, without the consent of HellermannTyton.

Drawn	AAC	04/11/2011
Approved	AAC	06/01/2011
HellermannTyton North America Email: corp@htamericas.com Web: www.hellermann.tyton.com		

Article/Type-No	SEE CHART	Scale	1:1	
Title	PET EXPANDABLE BRAIDED SLEEVING		Project Number	PRP11-0337
Drawing-No	11-0337-001-CSU	Production : Phase	Format	AH
			Sheet	1/1