

A technical drawing of a threaded rod. The rod is shown with a break symbol (two parallel diagonal lines) in the middle. The ends of the rod are labeled 'A' with arrows pointing outwards. Below the rod, there is a dimension line with arrows at both ends, labeled 'LENGTH (SEE NOTE 6)'.

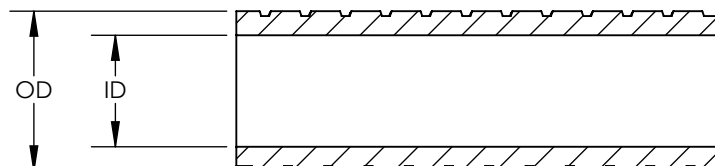
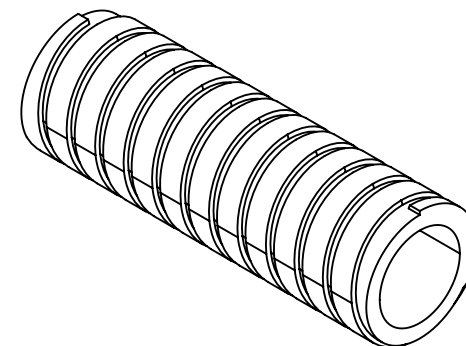
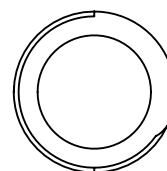

1. LOW FIRE HAZARD COVER RATED UL94 V0
2. HALOGEN FREE
3. OPERATING TEMPERATURE -40° F TO +212° F (-40° C TO +100° C)
4. RoHS
5. USE WITH HELAGUARD FSU METALLIC FITTINGS FOR IP65 PERFORMANCE
6. CONSULT FACTORY OR WEBSITE FOR AVAILABLE LENGTHS

Conduit Nominal Size		HellermannTyton Item Number	Man'f Part Reference	Outside Dimension (OD)		Inside Dimension (ID)		Minimum Bend Radius	
				in	mm	in	mm	in	mm
1/4	10.0	LTP10#-50M	LTP10#	0.46	11.8	0.28	7.0	1.38	35.0
5/16	12.0	LTP12#-50M	LTP12#	0.56	14.2	0.39	10.0	1.57	40.0
3/8	16.0	LTP16#-25M	LTP16#	0.70	17.8	0.50	12.6	1.77	45.0
1/2	20.0	LTP20#-25M	LTP20#	0.83	21.1	0.63	16.0	2.56	65.0
3/4	25.0	LTP25#-25M	LTP25#	1.04	26.4	0.83	21.0	3.94	100.0
1	32.0	LTP32#-25M	LTP32#	1.30	33.1	1.04	26.5	5.31	135.0
1-1/4	40.0	LTP40#-10M	LTP40#	1.65	41.8	1.39	35.4	6.89	175.0
1-1/2	50.0	LTP50#-10M	LTP50#	1.89	47.9	1.59	40.4	9.05	230.0
2	63.0	LTP63#-10M	LTP63#	2.35	59.7	2.03	51.6	11.02	280.0

Material	Units: inches	<p>The copyright of this drawing is reserved by HellermannTyton. It is issued on condition that it is not reproduced, copied, or disclosed to a third party, either wholly or in part, without the consent of HellermannTyton.</p>	Drawn	GRW	11/30/2016	Article/Type-No	FPU SERIES	Scale
GALVANIZED STEEL & POLYURETHANE	Dimension without tolerances details to:		Approved	KAC	11/30/2016	Title	HELAGUARD FLEXIBLE METALLIC GALVANIZED STEEL CONDUIT, POLYURETHANE COVER	Project Number
	.xxxx = ±.0005		 <p>North America Email: corp@htamericas.com Web: www.hellermann.tyton.com</p>			Format		AH
	.xxx = ±.005					Sheet		1/1
	.xx = ±.01					Drawing-No	PRODUCTION : Phase	
	.x = ±.03					16-1650-001-CSU		
	None = ±.06							
	∠ = ±0.5°							
	Dimension Formatted in/[mm]							