

## 6200 Series strikes for mortise or cylindrical devices

### Overview

Von Duprin electric strikes are known for their reliability, durability and security. The 6200 Series is designed to withstand abuse. Its heavy-duty stainless steel construction is fully UL1034 and UL10C Listed and ANSI/BHMA Grade 1, 1500 lb hold force rated.

6200 Series electric strikes are designed for use with a variety of mortise or cylindrical locksets, as well as mortise exit devices. It interfaces with the latch mechanism of the exit device. The 6200 Series movable lip (keeper) allows a door to open, even when the latch bolt is extended. This feature, called remote release provides added benefits such as increased convenience and efficiency. The 6200 Series also provides added security and traffic control.

6200 Series electric strikes can be used for retrofit applications or new construction. To assure the proper selection of an electric strike on new applications, lockset compatibility charts are shown on the next page. When using a lockset not listed or when retrofitting a strike to an existing application, please contact Von Duprin Technical Support for application assistance.

The power failure mode of the 6200 Series can be specified at the time of order. Fail-secure is available for fire rated openings. In a fail-secure application, the door is normally locked. To unlock the door power must be applied. Fail-safe strikes, which are commonly used for life safety applications, are non-fire rated. To unlock a fail-safe strike, power is removed. The 6200 Series comes standard with 24 VDC; 12 VDC and AC operation are optional.

### Features and benefits

- Non handed design provides greater flexibility
- Strike box is adjustable to compensate for misalignment of the door or frame
- Two piece plug connectors are furnished for ease of installation and for removal during strike servicing
- ANSI 156.5 Grade 1, 1500 lb hold-force rated
- UL1034 Burglary-Resistant and UL10C Electric Strike for Fire Door
- Six finishes available to suite with existing hardware
- Durable stainless steel construction
- 24 VDC standard with 12 VDC and AC operation optional
- Meets BHMA A156.31, Grade 1 for endurance and strength
- Static strength 1300 lbs
- Dynamic strength 70 ft-lbs
- Endurance 1,000,000 cycles

Specifications	12V	24V
Resistance in Ohms±10% @ 70°F	21	82
Watt-seated @ 70°F	7.5	8
Amps-seated @ 70°F	0.6	0.33
Amps-inrush @ 70°F	0.6	0.33



### Mortise Lockset Compatibility

6211, 6211AL, 6211WF, 6212, 6213, 6214, 6215, 6221, 6222, 6223, 6224, 6224AL, 6225 & 6226 Strikes

Manufacturer	Model Number
Von Duprin	7500
Adams Rite	4510, 4710
Baldwin	6000
Best	24H, 30H
Corbin	9000
Falcon	M2300, M2500, M2600, M3300, M3500, M3600
Precision	Mortise
Russwin	Mortise
Sargent	7700, 8100, 9000
Schlage	L9000, K30, K40, K50, K60
Yale	7030, 7130, 8600, 8700

### Mortise Lockset Compatibility

6210

Manufacturer	Model Number
Von Duprin	7500
Best	30H (not 45H/47H)
Corbin/Russwin	ML2200, 5000, 9000, CR2200 (not 2000)
Falcon	M100, M200, M300, M400, M500, M600
Sargent	7700, 8100 (not 7800/8200)
Schlage	L9000
Yale	8700 (not 8800)

### Cylindrical Lockset Compatibility<sup>1,3</sup>

6211, 6211AL, 6211WF, 6212, 6213, 6214, 6215, 6221, 6222, 6223, 6224, 6224AL, 6225 & 6226 Strikes

Manufacturer	Model Number
Baldwin	$\frac{1}{2}'' - \frac{3}{4}''$ (13mm - 19mm)
Best	$\frac{3}{8}'' - \frac{3}{4}''$ (10mm - 19mm)
Corbin	$\frac{1}{2}'' - \frac{3}{4}''$ (13mm - 19mm)
Falcon	$\frac{1}{2}'' - \frac{3}{4}''$ (13mm - 19mm)
Russwin	$\frac{1}{2}'' - \frac{3}{4}''$ (13mm - 19mm)
Sargent	$\frac{1}{2}'' - \frac{3}{4}''$ (13mm - 19mm)
Schlage	$\frac{3}{8}'' - \frac{3}{4}''$ (10mm - 19mm)
Yale	$\frac{1}{2}'' - \frac{3}{4}''$ (13mm - 19mm)

1. Von Duprin cannot guarantee compatibility as other manufacturer's designs may change without notice.
2. Signalling may not function when using  $\frac{3}{8}''$  (10mm) throw bolt. Deadlocking cannot be guaranteed with all locks.
3. When using a lockset not listed or when retrofitting a strike to an existing application, please contact Von Duprin Technical Support for assistance.

# 6200 Series strikes for mortise or cylindrical devices

## Wiring

### AC

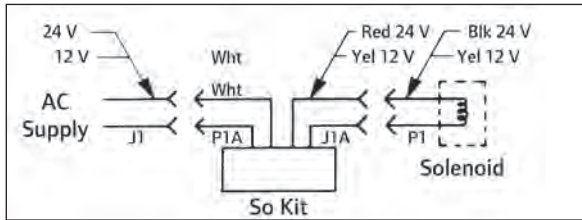

### AC with buzzer

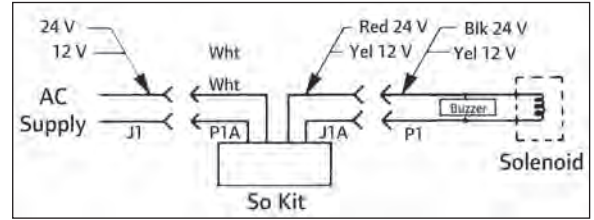

### DC

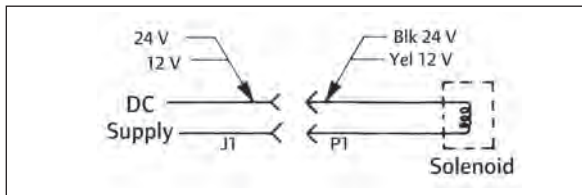



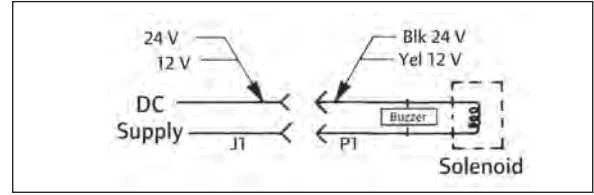

### DC with buzzer

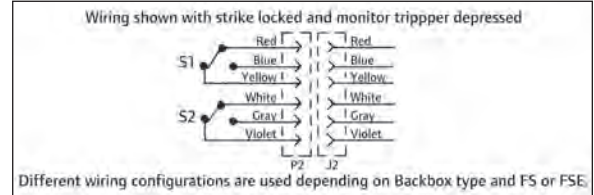

### Optional DS (FSE shown)



## Model Specifications

						
Model #		6210	6211	6211AL	6211WF	6212
Retrofits model		n/a	VD 3140, FA 712	FA 722	FA 732	VD 3146
Latchbolt throw		3/4"	3/4"	3/4"	3/4"	3/4"
Face plate length		4 7/8"	4 7/8"	4 7/8"	4 7/8"	6 3/8"
Backbox depth		1 21/32"	1 21/32"	1 21/32"	4 1/2"	1 21/32"
Lockset	Mortise	•	•	•	•	•
	Cylindrical	---	•	•	•	•
# Doors	Single	•	•	•	•	•
	Pair	---	---	---	---	---
Door & frame type	Hollow metal	•	•	---	---	•
	Aluminum	•	•	•	---	•
	Wood	---	---	---	•	---
Options	DS or DS-LC (dual monitor switches)	•	•	•	•	•
	EB (Entry buzzer - fail secure only)	•	•	•	•	•
	28 VDC AC rectifier kit	•	•	•	•	•
	16 VDC solenoid	•	•	•	•	•
Certifications	UL1034	•	•	•	•	•
	UL10C	•	•	•	•	•
	ANSI/BHMA 156.5 Grade 1 1500lb. Hold force rated	•	•	•	•	•
Application notes	1	2	3	4	5	

### Application notes:

- For use with mortise locks without deadbolt on single door, hollow metal frame applications and using ANSI prep at standard height. Strike pocket inserts are provided to accommodate different manufacturers deadlocking trigger locations.
- For use on new installations with mortise locks without deadbolt or cylindrical locks on single door, hollow metal frame applications. Designed to replace Von Duprin 3140 or Folger Adam 712.
- For use on new installations with mortise locks without deadbolt or cylindrical locks on single door, aluminum frame applications
- For use on new installations with mortise locks without deadbolt or cylindrical locks on single door wood frame applications. Designed to replace Folger Adams 732. Wood frame horizontal solenoid location differs from Folger Adams. Requires additional frame prep when retrofitting.
- For use with mortise locks without deadbolt or cylindrical locks on single door, hollow metal or aluminum frame applications. Fits modified ANSI 115.2 cutout. Designed to replace Von Duprin 3146

# 6200 Series strikes dimensions

## Dimensions

6210

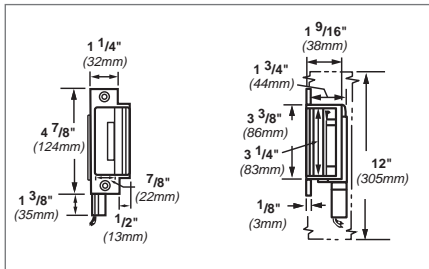

6212

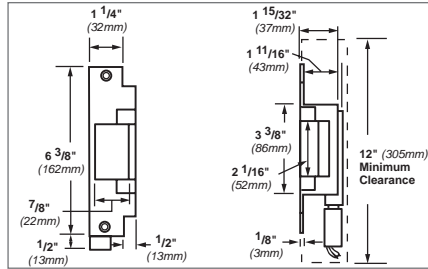

6215

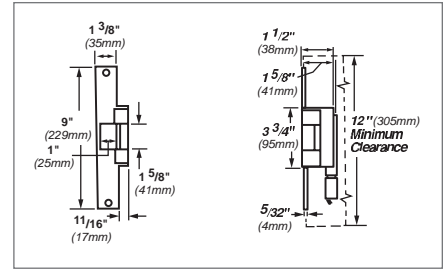

6211

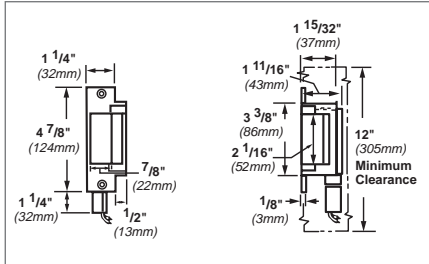

6212WF

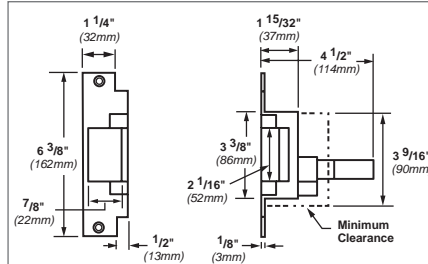

6216

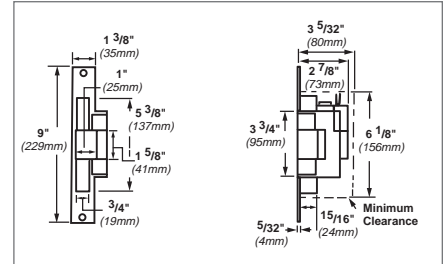

6211AL

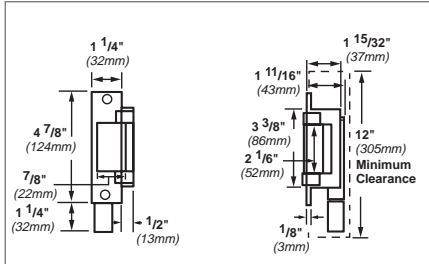

6213

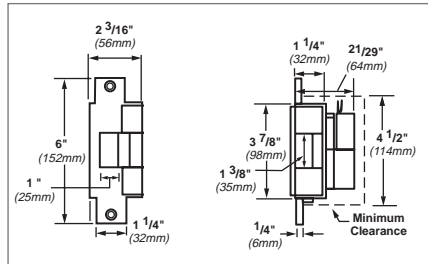

6221

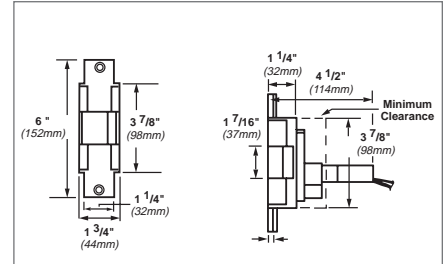

6211WF

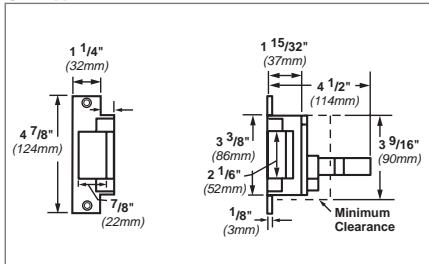

6214

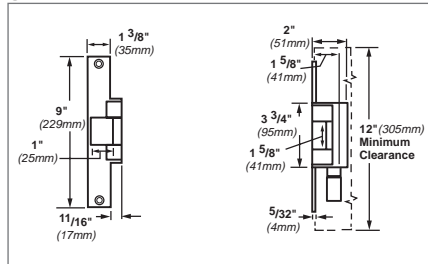

6222

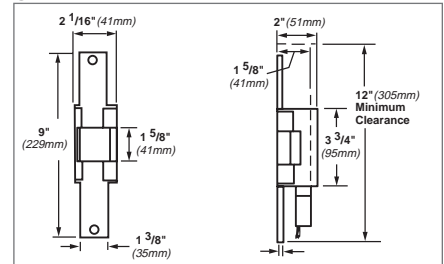

# Electric Strike/Lock information

## Finishes

US number	BHMA number	Description	Von Duprin number
US3	—	Plated polished brass on stainless steel	85
US4	—	Plated dull brass on stainless steel	84
US10	639	Plated dull bronze on stainless steel	06
US10B	640	Plated dark bronze on stainless steel	86
US32	629	Stainless steel, polished	31
US32D	630	Stainless steel, satin	32

## Wire size selection

Current requirement at 24VDC				
Length of wire run (in feet)	0-.5 Amp	.5-1 Amp	1-2 Amp	2-3 Amp
0-100	18	18	18	18
100-200	18	18	18	16
200-300	18	18	16	14
300-450	18	16	14	12
450-600	18	16	12	NR
600-900	16	14	NR	NR
900-1200	14	12	NR	NR

NR – Not recommended

## Cross reference

Name	Strike/Lock mounting	# Doors	Frame material (SGL DR) Door material (BL DR)	Faceplate length	Drop in replaces Von Duprin:	Drop in replaces Folger Adam:
6111	Rim device	Single <sup>1</sup>	All	6"	3031	
6112	Rim device	Single	All	9"		310-44
6113	Rim device	Single	All	6"	3011, 3021	
6114	Rim nightlatch	Single	All	7"		310-55
6121	Rim device	Double-closed back	All	9"		310-4-1005
6210	Mortise	Single	HM/Alu	4 <sup>7</sup> / <sub>8</sub> "		
6211	Mortise or cylindrical	Single	HM/Alu	4 <sup>7</sup> / <sub>8</sub> "	3140	712
6211AL	Mortise or cylindrical	Single	Aluminum	4 <sup>7</sup> / <sub>8</sub> "		722
6211WF	Mortise or cylindrical	Single	Wood	4 <sup>7</sup> / <sub>8</sub> "		7326
6212	Mortise or cylindrical	Single	HM/Alu	6 <sup>3</sup> / <sub>8</sub> "	3146	
6212WF	Mortise or cylindrical	Single	Wood	6 <sup>3</sup> / <sub>8</sub> "		
6213	Mortise or cylindrical	Single	All2	6"	3041, 42, 61, 62	
6214	Mortise or cylindrical	Single	All3	9"		310-2 3/4
6215	Mortise or cylindrical	Single	All3	9"		310-2
6216	Mortise and deadbolt	Single	HM/Alu	9"		310-3-1
6221	Mortise or cylindrical	Double-open back	All	6"	3071, 72	
6222	Mortise or cylindrical	Double-open back	HM/Alu	9"		310-2 3/4 OB
6223	Mortise or cylindrical	Double-closed back	All	6"	3091, 3092	
6224	Mortise or cylindrical	Double-closed back	HM/Alu	9"		310-2 3/4
6224AL	Mortise or cylindrical	Double-closed back	Aluminum	9"		310-2 RF
6225	Mortise or cylindrical	Double-open back	HM/Alu	9"		310-2 OB
6226	Mortise or cylindrical	Double-closed back	HM/Alu	9"		310-2

<sup>1</sup>Includes double door with mullion.

<sup>2</sup>Recommended on wood frames only if drop in replacement is needed for 3041, 42, 61, 62 on wood frames. Otherwise use 6211WF.

<sup>3</sup>Recommended on wood frames only if drop in replacement is needed for 310-2 3/4, 310-2 on wood frames. Otherwise use 6211WF.

<sup>4</sup>Strike lip area cutout is slightly larger than Folger Adam.

<sup>5</sup>Surface applied strike. Mounting hole locations different from Folger Adam.

<sup>6</sup>Wood frame horizontal solenoid location differs from Folger Adam. May require frame prep modification when retrofitting.