

Installation Instructions

Model Number 1044-CCOAP3800-S

Assembly Components:

- Suspended Ceiling Kit Model 1044 assembly – 1 each
- Trim – 1 each
- Firestop Grommet – 1 each
- 1" Conduit Connector – 1 each
- #8-32 x 1/4" Screws - 4 each
- Hanger wire – 4 each

If any of these items are missing, contact your Oberon representative.

Find a flat work surface to assemble the *ceiling kit*, *access point* and *antenna(s)* prior to mounting in ceiling.

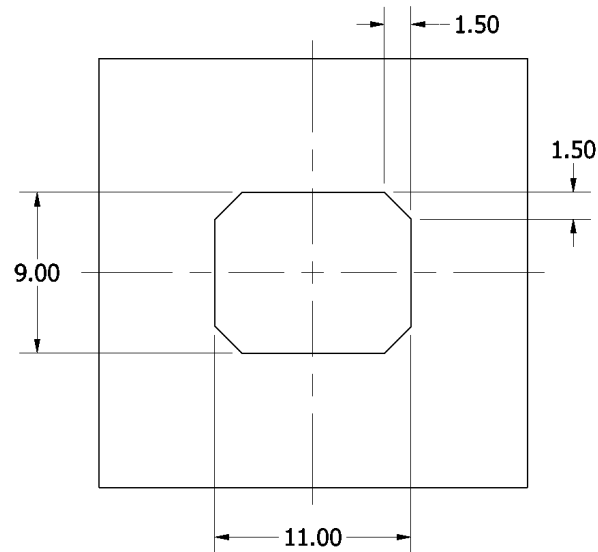

Figure 2 - Ceiling Tile Cutout.

Step 3 – Place the tile back in the ceiling place the tile bridge on top of the tile. When placing the tile bridge above the tile, it should be placed so the spring retainers are visible and aligned with the 11" width of the tile cutout. Attach the hanger wires to the four tabs located on the corners of the tile bridge and then to a permanent structure within the ceiling. Slide the cables through the conduit connector and snap the Firestop Grommet over the cables (Figure 3). Make sure there is enough slack in the cabling to attach to the access point.

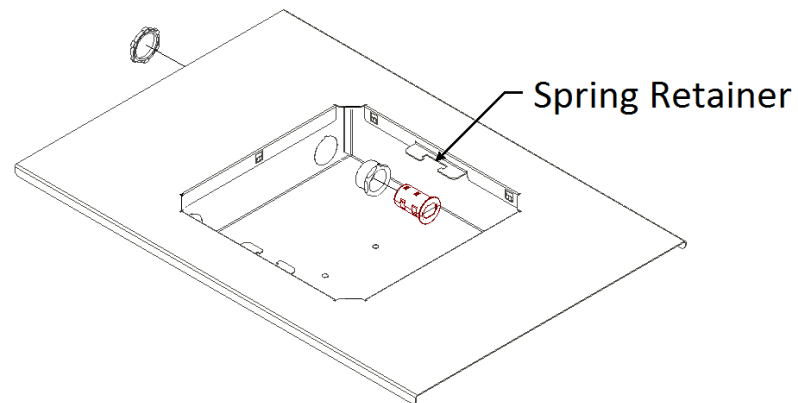

Figure 1 - Conduit Connector Installation.

Step 1 – Remove any knockouts from the tile bridge needed for cable egress. Fasten the conduit connector to the tile bridge through the open knockout (Figure 1).

Step 2 – Remove the ceiling tile and cut a 9" X 11" opening with 1.5" x 1.5" chamfers on all four corners with the cutout centered on both the X and Y axis (Figure 2). For larger projects, Oberon has a router template available to help decrease the time required to cut out ceiling tiles (Oberon P/N 104X-ROUTER-TEMPLATE). Contact your Oberon representative for details.

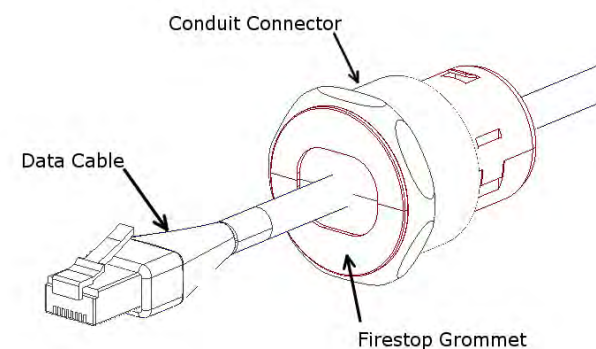

Figure 3 - Firestop Grommet Installation

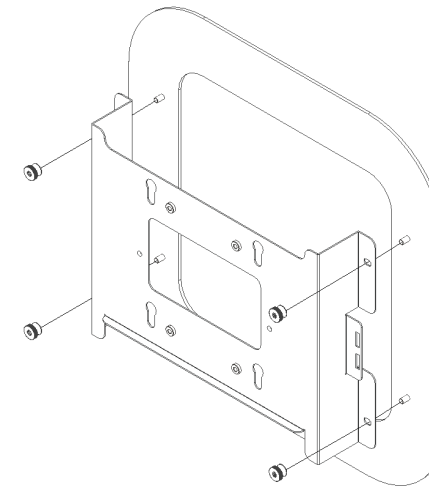

Figure 4 - Remove Mounting Plate

Step 5 - Install the two torsion springs by: **A** pinching the tips together, and **B** inserting the tips into the rectangular openings on each end of the mounting bracket (Figure 5).

NOTE: A surface mount box (or biscuit jack) and equipment cord can be conveniently mounted inside the Model 1044. (Non-plenum rated cables can be used inside a plenum rated enclosure). Use an adhesive backed surface mount box. Consider bend radius of horizontal cable and equipment cord when attaching the surface mount box.

Step 4 – The torsion spring that is used to secure the trim assembly to the tile bridge is shipped separately (to prevent damage) and must be installed prior to the first use. To install torsion springs, first detach the mounting plate from the trim face by removing the two thumb nuts (Figure 4).

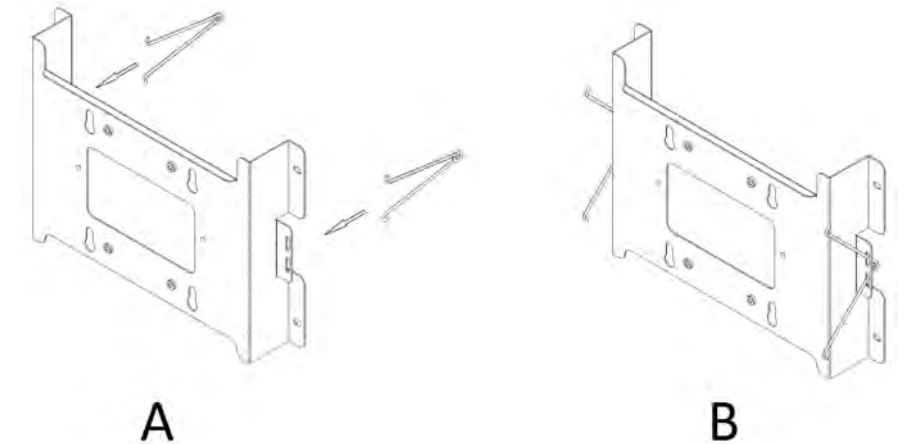

Figure 5 - Installation of Torsion Spring

Step 6 - The Cisco 2700e, 3800e, and 3800i AP's should be aligned with the Oberon mounting plate so that the flange on the bottom of the Oberon mounting plate is opposite the Ethernet ports on the AP, the mounting plate that comes with the Cisco Access point is only required for use with the Cisco 2700i. All other variations get attached directly to the Oberon mounting plate. Attach the Cisco access point to the Oberon mounting plate by inserting the mounting feet on the bottom of the Cisco access point into the keyhole slots and sliding the AP to lock into position, as shown (Figure 6).

For the **2700i ONLY**, first attach the Cisco AIR-BRACKET-1 (supplied with the AP) to the Oberon mounting bracket by using the four (4) supplied #8-32 screws. The Cisco bracket should be aligned with the Oberon mounting plate so that the Ethernet ports are opposite the flange on the bottom of the Oberon mounting plate. Slide the AP onto the Cisco bracket to attach it to the mounting plate.

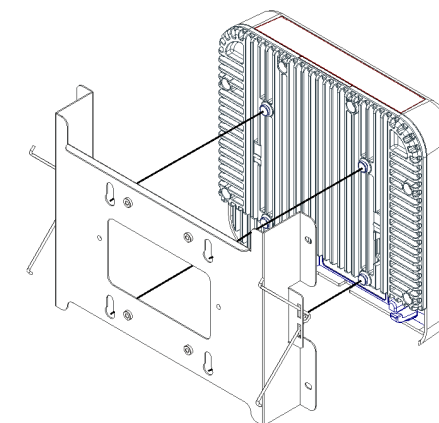

Figure 6 - Reattach Mounting Plate to Trim

Step 7 - Reassemble the trim by attaching the trim piece which was previously removed by inserting the studs into the slotted holes and installing the thumb nuts as shown in Figure 7.

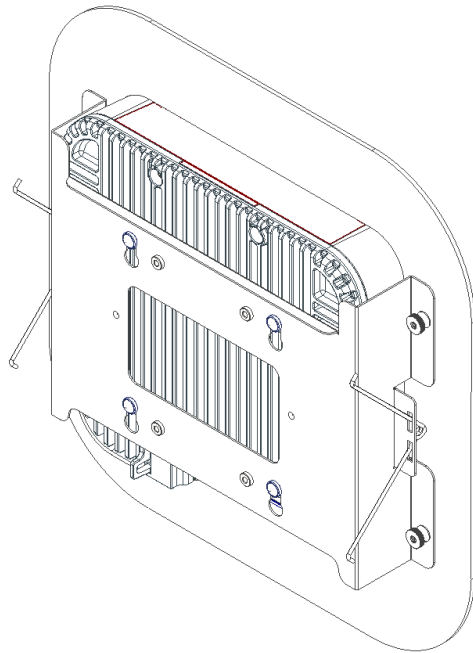

Figure 7 - Install Access Point

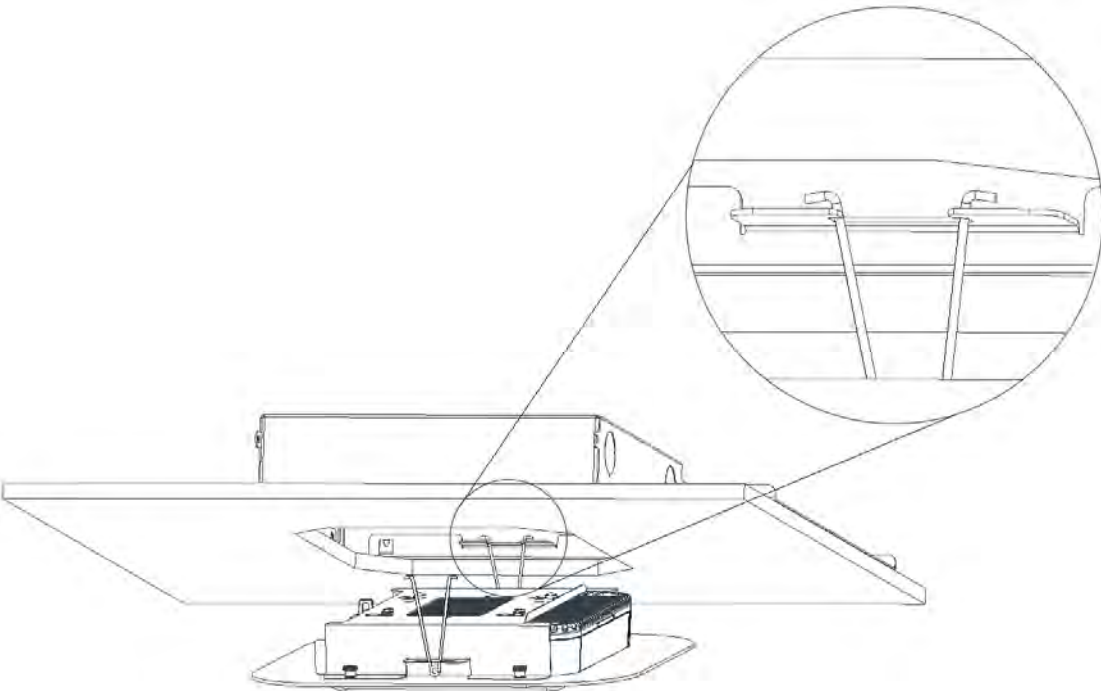
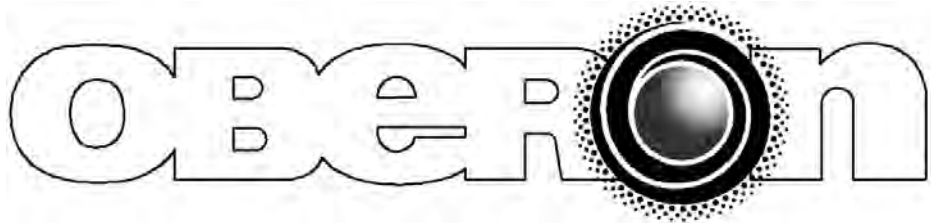

Figure 8 - Assembly of Trim to Backbox

Step 8 - To complete the installation, attach the Ethernet cable to the access point. Then compress the torsion spring on one side of the trim assembly and place it into the opening of the spring retainer on the tile bridge, as shown in Figure 8. Repeat the same procedure for the second torsion spring to the other spring retainer. To complete the assembly push the trim up toward the ceiling tile, the torsion springs will draw the trim up tight against the tile.



MODEL 1044-CCOAP3800-S

Installation Instructions

**** **WARNING** ****

Please thoroughly read the product warning below before installation to provide for a safe work environment.

1. Ceiling mounted products should be installed in accordance with National Electric Code paragraphs 300.10 (Electrical Continuity of Metal Raceways and Enclosures) and 300.11 (Securing and Supporting). Independent support wires or other means must be used for the installation of this product in the ceiling. Acoustical, suspended, false, drop and concealed spline ceiling grid work is not designed to support the weight of this product. Oberon's ceiling mounted products have four support wire tabs on the back box. These tabs shall be used for supporting the product with independent support wires, wire rope, threaded rod, or other secure support means of adequate gauge and fire resistance.
2. When closing the enclosure access door, be sure that the cam lock is completely engaged to prevent the access door from accidentally swinging open.
3. When opening the enclosure door, be sure to support the door to prevent the door from accidentally falling open.
4. This enclosure has a maximum operating ambient of 55° C (131° F), the temperature within the enclosure may not exceed this temperature, depending on power dissipation within enclosure.
5. A minimum air clearance of 1" between the housing of the access point and the enclosure side walls must be maintained for the safe operation of the equipment.
6. This product is intended to be installed by trained personnel.
7. Only Listed ITE products and Listed AC Receptacles shall be installed within the enclosure.
8. This product is to be repaired by personnel trained by the manufacturer or returned to the manufacturer for repair or replacement.
9. Maximum weight to be installed in the unit is 25 lbs.
10. All knockouts, openings, and holes shall be sealed with a plug constructed of metal, or a non-metal material that complies with UL 2043 or UL 1479.
11. All unused mounting holes should be sealed with tape or other material that complies with UL 1479.
12. If AC power is used inside the enclosure, connect the ground wire to the green ground screw located near the knockout in the backbox.