



EASY
SCREEN
POSITIONING

BT7374

TWIN FLAT SCREEN DESK MOUNT WITH DUAL ARTICULATED ARMS

The BT7374 is a dual articulated arm desk mount made from durable aluminium with an anodised polished finish. Suitable for use with screens up to 28", each arm features three swivel points plus 360° screen rotation at the interface, making this desk mount perfect for portrait or landscape mounting. The mount can be easily fixed to the rear or side of a desk or through a grommet hole and the integrated cable management ensures a neat and tidy installation.

SPECIFICATION

| | |
|----------------------------|---------------------|
| Recommended screen size | up to 28" |
| Max load | 9kg (per screen) |
| VESA® compatibility | 75 x 75 & 100 x 100 |
| Tilt | + 65° / -90° |
| Swivel at pole & arm pivot | 360° |
| Swivel at interface | 220° |
| Screen rotation | 360° |
| Max extension | 445mm |
| Colour | Black |

FEATURES

- High-end aesthetic quality with a durable anodised polished finish
- Easy lateral screen positioning
- Height adjustment using tool-less locking collar
- Supplied with a desk / grommet clamp
- Articulated arms can be locked in desired position using the included stoppers
- Integrated cable management
- 360° screen rotation makes it easy to adjust screens from landscape to portrait
- Simple 'hook-on' installation
- All mounting hardware included



VESA
100

28"
71cm

9KG

90°
65°

360°

360°

per screen

screens



Cable management is integrated throughout the mount for a neat and tidy installation



Supplied with a desk clamp that can attach either to the rear / side of a desk or through a grommet hole



Articulated arms can be locked in desired position using the included stoppers



360° screen rotation makes it easy to adjust screens from landscape to portrait

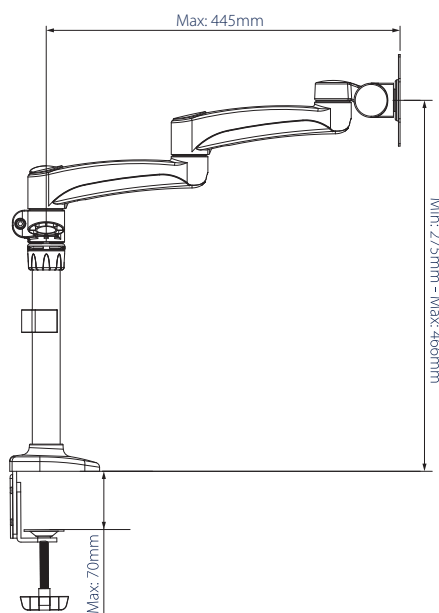

SIDE VIEW

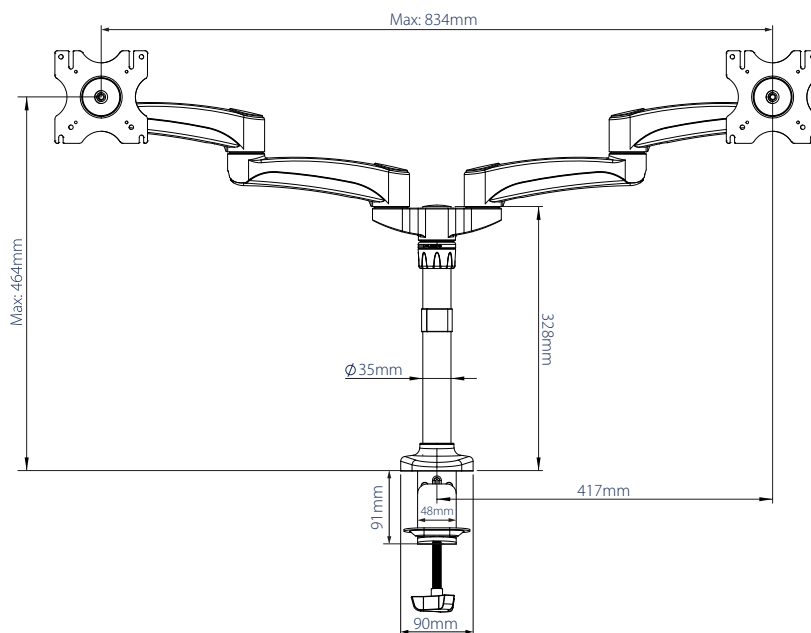

FRONT VIEW

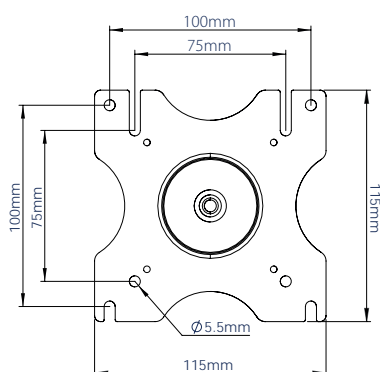

INTERFACE

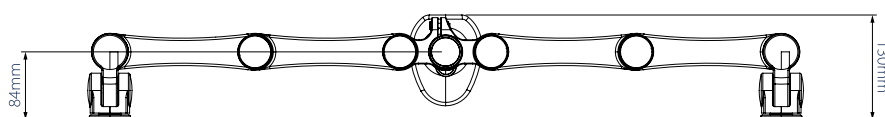

TOP VIEW

PACKING INFORMATION

| COLOUR: | ORDER REF: | EAN CODE: | MASTER CARTON QTY: | INNER CARTON QTY: | MASTER CARTON WEIGHT: | MASTER CARTON CUBE: |
|---------|------------|---------------|--------------------|-------------------|-----------------------|---------------------|
| Black | BT7374/B | 5019318752186 | 2 | 0 | 9.9kg | 0.062cbm |

ACCESSORIES & RELATED PRODUCTS



Twin Screen Full Motion Desk Mount
designed for 2 screens up to 28"



Double Arm Premium Desk Mount
designed for screens up to 28"



Double Arm Full Motion Desk Mount

designed for screens up to 28"



Single Arm Premium Desk Mount
designed for screens up to 28"