

Cable & Bolt Cutters

Klein exceeds the highest of standards to create superior cable and bolt cutters, offering greater cutting power, clean and precise cuts, as well as long life. Klein cable and bolt cutters are a cut above the rest.

For Professionals...
Since 1857™

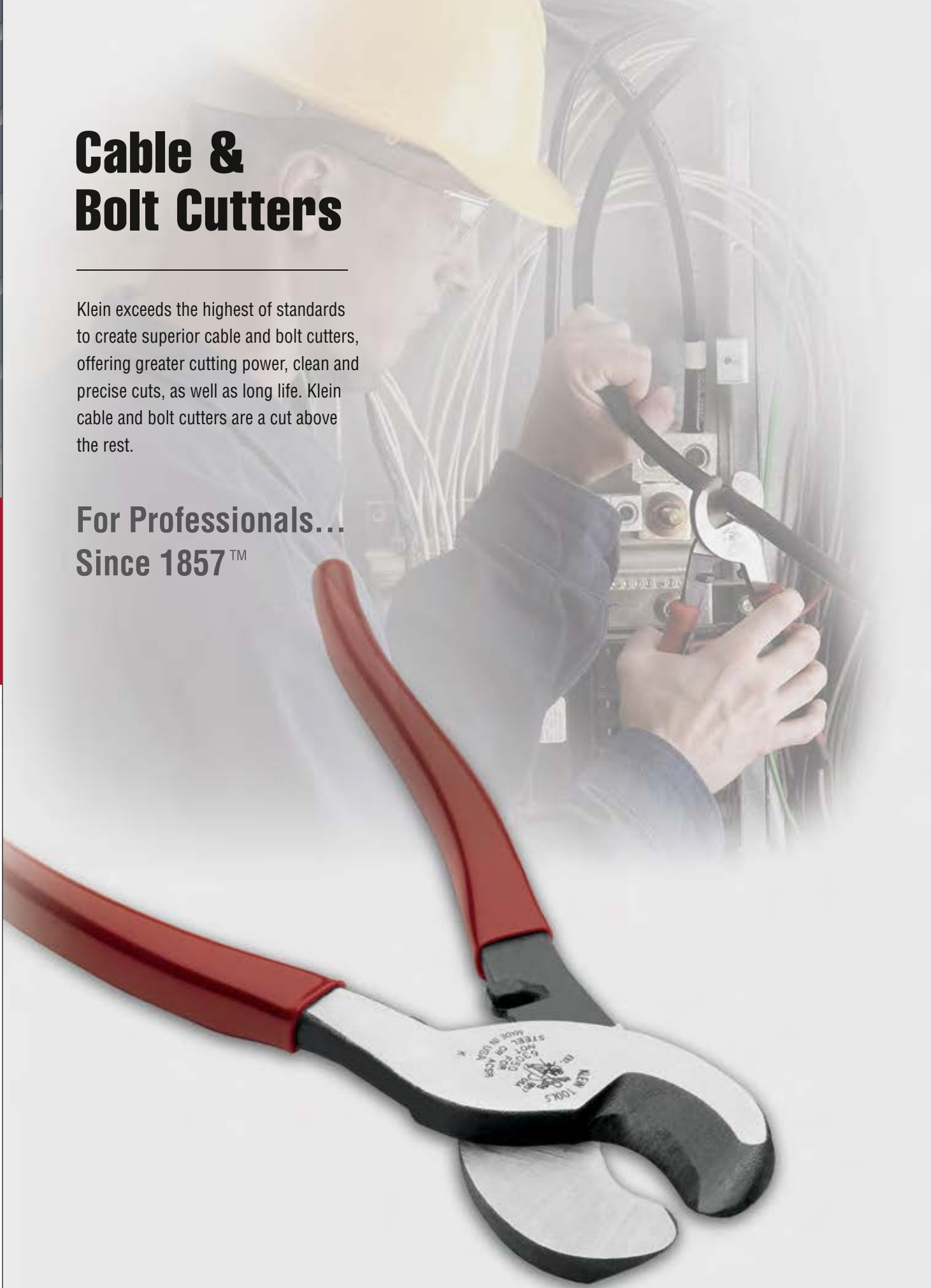
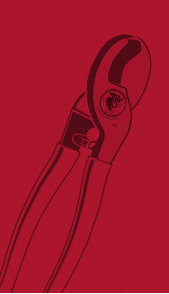

Cable Cutters

Features:

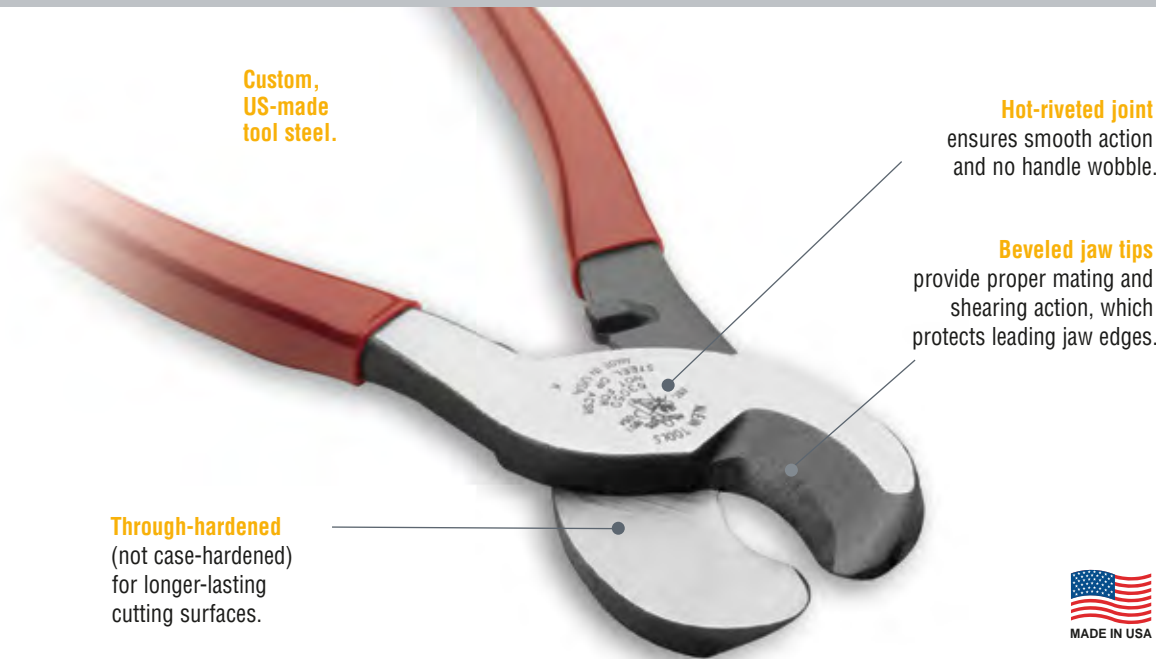

High-Leverage Cable Cutters

Additional Features:

- High-leverage design for exceptional cutting capability.
- Precision, one-hand shearing action.
- Cable-gripping shear-type jaws.
- Perfect for working in confined spaces.
- Can be carried in most tool pouches.



63050

Cat. No.	Maximum Cable Cutting Capacity	Handle Color	Overall Length	Weight
63050	4/0 aluminum, 2/0 soft copper, 100-pair 24 AWG communications cable	red	9-1/2" (241 mm)	.90 lbs.
Journeyman Series – Dual-material handles				
J63050	4/0 aluminum, 2/0 soft copper, 100-pair 24 AWG communications cable	red and black	9-9/16" (243 mm)	.98 lbs.

Multi-Cable Cutter **KLEIN-KURVE™**

- Hardened steel precision-ground cutting blades for long life.
- Copper curved cutter cleanly cuts round copper cable without compression or frayed ends.
- Anvil cutter for solid and stranded copper wire up to 12 AWG and stainless steel up to .032" (.81 mm) diameter.
- Mild steel cutter for conductors up to .080" (2 mm) diameter.
- Curved cutter for solid and stranded copper wire up to 8 AWG, multi-conductor cable up to 1/2" (13 mm) diameter and coaxial cable RG-6 Quad, RG-59, and RG-62.
- Double-dipped grips for comfort.
- Coil spring provides fast self-opening action.
- Holes for looping and bending wire.
- Handy closure lock for convenient storage.



63020

Cat. No.	Screw Shearing	Handle Color	Overall Length	Weight
63020	6-32 & 8-32	red	7" (177 mm)	.44 lbs.

All dimensions are in inches and (millimeters).



WARNING: Do NOT cut steel or ACSR.

www.kleintools.com

See page 296 or additional information on warnings.

Cable Cutters

Cable Cutters — Coaxial

- Cable-gripping jaws quickly score jacket and insulation, and easily cut through copper inner conductor.
- Blades cleanly cut aluminum and copper coaxial cable without compression and frayed ends.
- Forged body with heat-treated and precision-ground steel blade withstands frequent cutting.
- Hot-riveted design requires no adjustment while maintaining a smooth, precise operation.
- Compact, lightweight design fits perfectly in any professional's tool pouch.
- Handles are plastic-coated for maximum comfort and gripping power.
- When cutting drop wire with an inner steel conductor, we recommend our 2000 Series cutting pliers.



63028



63030

⚠ WARNING: Do NOT cut steel or ACSR.

Cat. No.	Soft Cable-Cutting Maximum Capacity	Handle Color	Overall Length	Weight
63028	.75" (19 mm) diameter	yellow	8-1/4" (216 mm)	.80 lbs.
63030	1" (25 mm) diameter	blue	8-1/4" (216 mm)	.83 lbs.

Compact Cable Cutter

- Precise, one-hand shearing action cuts 24 AWG copper, aluminum multi-strand cable and wire, and 100-pair telephone cable.
- Special shear angle cuts cleanly without compression to cable geometry for telecom cable work.
- Heat-treated, high-carbon steel shearing edges for long life.
- Forged body with 3/8" (10 mm) case-hardened rivet.
- Plastic-dipped handles for comfort.



63055

⚠ WARNING: Do NOT cut steel or ACSR.

Cat. No.	Maximum Cable Cutting Capacity	Handle Color	Overall Length	Weight
63055	24 AWG copper, aluminum multi-strand cable and wire, and 100-pair telephone cable	red	8" (203 mm)	.65 lbs.

All-Purpose Shears and BX Cutter

- High-leverage, shear-type design for one-hand operation.
- Lightweight and compact.
- Stripping notch for added convenience.
- Cuts a variety of materials including cable, sheet metal, steel strapping, and bundling wire.
- Handle cavity is designed to restore BX cable to original shape after cutting.
- Plastic-dipped handles for comfort.



1104

⚠ WARNING: Do NOT cut steel or ACSR.

Cat. No.	Length of Cut	Handle Color	Overall Length	Weight
1104	7/8" (22 mm)	red	7-5/8" (194 mm)	.60 lbs.

Heavy-Duty Cable Shears

- Heavy-duty, tempered steel blades.
- Will cut ACSR, steel, and most hardened wire.
- Blades grip cable and cut easily at center of jaws.
- Lock keeps handles closed for easy storage.
- Comfortable, plastic-coated handles for steady grip.
- Hardened steel, precision cutting blades for long service life.
- Unique triangular jaws cleanly cut cable without compression or frayed ends.



63016

Cat. No.	Maximum Cable Cutting Capacity	Handle Color	Overall Length	Weight
63016	up to 1/4" copper and mild steel strands, up to 3/16" aircraft cable, wire rope, aluminum and copper rods, up to 5/32" for steel & iron rods	blue	7-1/2" (191 mm)	.65 lbs.

All dimensions are in inches and (millimeters).



Cable Cutters

Utility Cable and Rope Cutters

- Forged steel with black-oxide finish for long life.
- Shear-type hook jaws grab and hold cable while shear-cutting action makes clean cuts.
- Beveled tips for positive mating.
- Hinge bolt with pin-set nut for proper blade tension.
- Cat. No. 63035SC cuts wire up to 9/32" (7 mm) and Stoffel® container seals.
- Cat. No. 63035 is not designed to cut steel or ACSR.



63035



63035SC

Cat. No.	Maximum Cutting Capacity	Handle Color	Overall Length	Weight
63035	MCM Cable 350 copper, 350 aluminum	red	16-3/4" (425 mm)	1.70 lbs.
63035SC	9/32" (7 mm) wire rope and cables	red	18" (457 mm)	2.00 lbs.

Stoffel® is a registered trademark of Stoffel Seals Corporation.

Standard and Communication Cable Cutters



63041TH

- Lightweight, yet efficient shear-type cable cutters.
- Replaceable hook-jaw blades grab and hold cable while shear-cutting action makes clean cuts.
- Exceptionally strong fiberglass handles with heavy vinyl grips for comfort and slip resistance.
- Heavy-duty pins in head serve as blade-stops.
- Jaws are forged tool steel with black-oxide finish for long life.
- Beveled tips assure positive mating, and hinge on a rugged bolt with a pin-set nut to maintain proper blade tension.
- Makes a clean, even cut for ease in fitting lugs and terminals.
- Cat. No. 63041TH includes rubber sleeves.
- Cat. No. 63047 cuts lead or rubber-covered communications cable.

63047

WARNING: Do NOT cut steel or ACSR.

Cat. No.	Soft Cable-Cutting Maximum Capacity	MCM Cable-Cutting Maximum Capacity	Overall Length	Weight
63041	1-3/8" (35 mm) diameter	500 copper, 750 aluminum	25-1/2" (648 mm)	5.25 lbs.
63041TH	1-3/8" (35 mm) diameter	500 copper, 750 aluminum	25-1/2" (648 mm)	5.25 lbs.
63045	1-3/4" (44 mm) diameter	1000 copper, 1200 aluminum	32" (813 mm)	8.00 lbs.
63047	up to 2-1/4" (57 mm) diameter	900-pair soft copper and aluminum	37" (940 mm)	8.55 lbs.
Replacement Cable Cutter Heads (complete)		Fits Klein Cat. No.		
63081		63041		2.05 lbs.
63090		63045		3.30 lbs.
63110		63047		3.50 lbs.

All dimensions are in inches and (millimeters).



www.kleintools.com

See page 296 or additional information on warnings.



Cable Cutters

Ratcheting Cable Cutters

- High-leverage ratchet mechanism for single-handed cutting of copper and aluminum cables, leaving no burrs or sharp edges.
- Two-step ratchet mechanism requires fewer strokes per cut.
- Open jaw design works in confined spaces (Cat.No. 63711).
- Quick release lever opens blades easily in every cutting position. (Allows removal of the cable before completion of cut).
- Precision ratcheting mechanism holds cable tight and allows rapid, straight cuts with minimum effort.
- Hardened steel cutting blades for lasting strength and sharpness.
- Plastic covered handles with hand guards for comfort and firm grip.
- Locking lever keeps handles closed for easy transport; fits in a toolbox or bag.
- One-year warranty (Cat. No. 63060 & 63750).



63060



63711

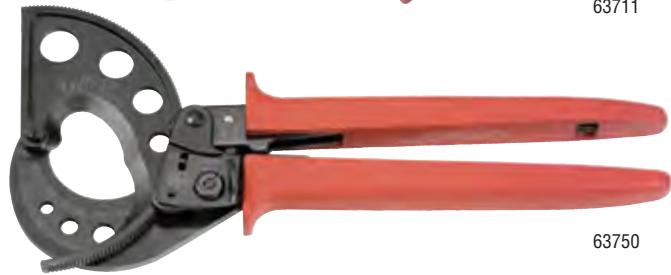

63750

⚠WARNING: Do NOT cut steel or ACSR.

Cat. No.	MCM Maximum Cable Capacity				Overall Length	Handle Color	Weight
	Copper	Aluminum	ACSR	Communication Cable			
63060	400 MCM (185 mm ²)	600 MCM (300 mm ²)	—	1-1/8" (28 mm)	10-1/4" (260 mm)	red	1.32 lbs.
63711	600 MCM (300 mm ²)	750 MCM (400 mm ²)	—	1-1/8" (28 mm)	11-1/2" (292 mm)	red	2.00 lbs.
63750	1000 MCM (500 mm ²) Frequent Use: 750 MCM (400 mm ²)	1000 MCM (500 mm ²) Frequent Use: 750 MCM (400 mm ²)	—	2-1/16" (52 mm)	12-1/8" (308 mm)	red	1.76 lbs.

Replacement parts available (blades, handles, springs, pawl sets and release plates).

ACSR Ratcheting Cable Cutters

- High-leverage ratcheting mechanism for easier cutting.
- Quick-release lever opens blades easily in every cutting position (allows removal of the cable before completion of cut).
- Hardened steel cutting blades for long lasting strength and sharpness.
- Tools can be locked when not in use.
- Cat. No. 63800ACSR features cutting inserts that are easily replaced by simply removing 3 screws per blade.
- Plastic covered handles with hand guards for comfort and firm grip.



63607



63800ACSR

Cat. No.	MCM Maximum Cable Capacity				Handle Color	Overall Length	Weight
	ACSR	Aluminum	Copper	Guy Strand			
63607	336 MCM (170 mm ²)	600 MCM (300 mm ²)	400 MCM (185 mm ²)	—	yellow	10-1/4" (260 mm)	1.50 lbs.
63800ACSR	477 MCM (273 mm ²)	1-1/4" (32 mm)	1" (25 mm)	1/2" (13 mm)	red	13-3/4" (349 mm)	3.20 lbs.

Replacement Cutting Inserts (with set of 6 screws)	Fits Klein Cat. No.
63858	63800ACSR

Replacement parts available (blades, handles, springs, pawl sets and release plates).

All dimensions are in inches and (millimeters).



Cable Cutters

Ratcheting ACSR Cable Cutter – Heavy-Duty

- Ratchet-action design provides maximum leverage with minimum effort for heavy-duty use.
- Blade-advance knob for fast rotation of the blade to engage the cable or other material being cut, plus a quick-release mechanism allows for removal of the cable or rod before completion of the cut, if desired.
- Not designed for cutting EHS guy strand or reinforcement rod.

- Cuts steel and ACSR.
- Forged, heat-treated, shear-type blades, plus 17" (432 mm) long fiberglass handles with heavy duty grips for comfort and slip resistance.

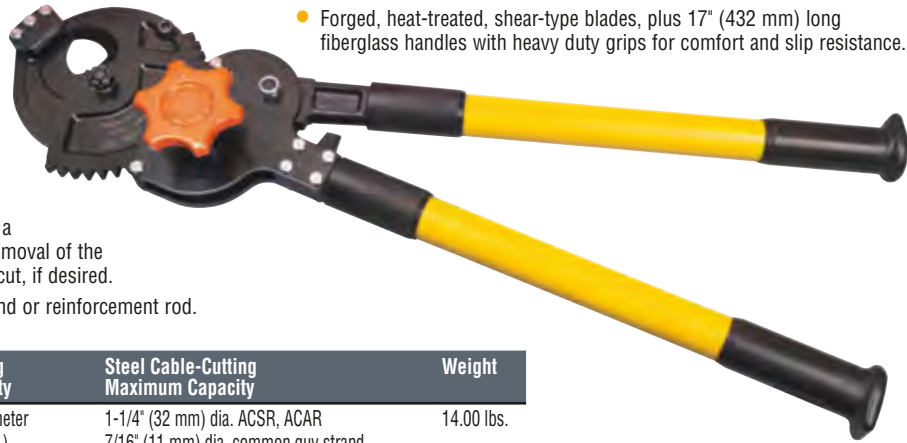

63700

Cat. No.	Overall Length	Soft Cable-Cutting Maximum Capacity	Steel Cable-Cutting Maximum Capacity	Weight
63700	28" (711 mm)	2-1/4" (57 mm) diameter 750 MCM (1-3/8" dia.) (35 mm) copper or aluminum	1-1/4" (32 mm) dia. ACSR, ACAR 7/16" (11 mm) dia. common guy strand 5/8" (16 mm) dia. steel wire rope 1/2" (13 mm) dia. steel rod (C.R.S. SOFT)	14.00 lbs.

Bolt Cutters

Bolt Cutters – Steel and Fiberglass Handle

- All-purpose, center-cut jaws
- Forged, alloy tool steel jaws are precision ground for sure, efficient cutting and long life.
- Lock plate reinforcement prevents jaw bolts from loosening or turning, keeping jaws in correct alignment.
- One adjustment realigns cutting edges.
- 3-point toggle joint multiplies 50 lbs. of hand pressure on handles to 4,000 pounds at cutting jaws.
- NOT for cutting cable.



63314

Cat. No.	Handle Type	Overall Length	Soft & Medium Cutting Max. Capacities*	Hard Material Cutting Max. Capacities**	Weight
Steel Handles					
63314	steel	14" (356 mm)	5/16" (8 mm)	3/16" (5 mm)	3.15 lbs.
63318	steel	18" (457 mm)	3/8" (10 mm)	1/4" (6 mm)	3.55 lbs.
63324	steel	24" (610 mm)	7/16" (11 mm)	5/16" (8 mm)	6.30 lbs.
63330	steel	30" (762 mm)	1/2" (13 mm)	3/8" (10 mm)	10.20 lbs.
63336	steel	36" (914 mm)	9/16" (14 mm)	7/16" (11 mm)	14.25 lbs.
63342	steel	42" (1067 mm)	11/16" (18 mm)	1/2" (13 mm)	19.20 lbs.
Fiberglass Handles					
63118	fiberglass	18-1/4" (464 mm)	3/8" (10 mm)	1/4" (6 mm)	3.65 lbs.
63124	fiberglass	24-1/2" (622 mm)	7/16" (11 mm)	5/16" (8 mm)	6.13 lbs.
63130	fiberglass	30-1/2" (775 mm)	1/2" (13 mm)	3/8" (10 mm)	9.50 lbs.
63136	fiberglass	36-1/2" (927 mm)	9/16" (14 mm)	7/16" (11 mm)	12.95 lbs.

Replacement Blades

Cat. No.	Fits Cat. No.
63224	63124
63814	63314
63818	63318
63824	63324
63831	63330
63836	63336
63842	63342

Replacement Fiberglass Handle Sets

Cat. No.	Fits Cat. No.
63131	63130
63137	63136

* Up to Brinell 300, Rockwell C31.

** Up to Brinell 400, Rockwell C42.

Cable Benders

- Durable forged and one-piece steel construction for exceptional strength.
- Head is angled 22° for ease in bending cable in tight, hard-to-access places.
- Corrosion-resistant, black-oxide finish with heavy-duty double-dipped plastic handle.
- It is recommended that two benders be used for easier bends.



50400

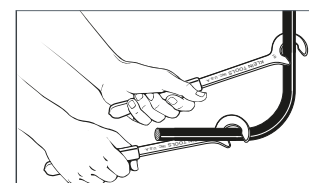

Cat. No.	Overall Length	Tool Opening	Maximum Cable Capacity	Weight
50400	12" (305 mm)	7/8" (22 mm)	350 MCM	.90 lbs.
50402	14-1/2" (367 mm)	1-1/4" (26 mm)	500 MCM	1.55 lbs.

All dimensions are in inches and (millimeters).



www.kleintools.com

See page 296 or additional information on warnings.

