

SOCKETS & DRIVE TOOLS

1" DRIVE

Snap-on INDUSTRIAL BRANDS

WILLIAMS



1" DRIVE DEEP IMPACT SOCKETS, 6 POINT, SAE

Black Industrial Finish

Product Code	Size (Inches)	A OAL (Inches)	B Drive End Diameter (Inches)	C Working End Diameter (Inches)	D Broach Depth (Inches)	E Bolt Clearance Depth (Inches)	F Bolt Clearance Diameter (Inches)	Nose Length (Inches)	Uses RET RING® Number	Use O-Ring / Pin
17-632	1	3	2 1/8	1 19/32	3/4	1 13/16	1 1/16	7/8	7-2XS	7-1B / 7-2D
17-634	1 1/16	3 3/4	2 1/8	1 3/4	1 23/32	2 19/32	3/4	7/8	7-2XS	7-1B / 7-2D
17-636	1 1/8	3 3/4	2 1/8	1 13/16	1 25/32	2 19/32	7/8	7/8	7-2XS	7-1B / 7-2D
17-638	1 1/16	3	2 1/8	1 13/16	3/4	1 13/16	13/16	7/8	7-2XS	7-1B / 7-2D
17-640	1 1/4	3 3/4	2 1/8	1 31/32	1 19/16	2 19/32	7/8	1	7-2XS	7-1B / 7-2D
17-642	1 3/16	4	2 1/8	2 1/16	2 1/32	2 27/32	1	1	7-2XS	7-1B / 7-2D
17-644	1 3/8	4	2 1/8	2 1/16	2 1/16	2 27/32	1	1	7-2XS	7-1B / 7-2D
17-646	1 7/16	4	2 1/8	2 1/4	2 3/16	2 27/32	1	2 1/4	7-2XS	7-1B / 7-2D
17-648	1 1/2	4	2 1/4	2 3/8	2 1/4	2 27/32	1 1/8	2 1/2	7-2XS	7-1B / 7-2D
17-650	1 5/16	3 1/2	2 1/4	2 3/8	1	2 11/32	1 17/32	2 1/2	7-2XS	7-1B / 7-2D
17-652	1 5/8	4 1/4	2 1/4	2 7/16	2 13/32	3 3/32	1 1/8	2 5/8	7-2XS	7-1B / 7-2D
17-654	1 11/16	4 1/4	2 1/4	2 17/32	2 1/2	3 3/32	1 1/4	2 5/8	7-3XS	7-1B / 7-2D
17-656	1 3/4	4 1/4	2 1/4	2 19/32	2 9/16	3 1/32	1 1/4	2 7/8	7-3XS	7-1B / 7-2D
17-658	1 13/16	4 1/2	2 1/4	2 11/16	2 21/32	3 9/32	1 1/4	2 7/8	7-3XS	7-1B / 7-2D
17-660	1 7/8	4 1/2	2 1/4	2 3/4	2 3/4	3 1/4	1 3/8	2 7/8	7-3XS	7-1B / 7-2D
17-662	1 15/16	4 1/2	2 1/4	2 27/32	2 13/16	3 1/4	1 3/8	3 1/8	7-3XS	7-1B / 7-2D
17-664	2	4 1/2	2 1/4	2 29/32	2 7/8	3 7/32	1 3/8	3 1/8	7-3XS	7-1B / 7-2D
17-666	2 1/16	4 3/4	2 1/4	3	2 31/32	3 15/32	1 1/2	3 1/8	7-3XS	7-1B / 7-2D
17-668	2 1/8	4 3/8	2 3/8	3 1/4	1 5/16	3 3/16	1 5/8	3 3/8	7-3XS	7-1B / 7-2D
17-670	2 3/16	4 3/4	2 13/32	3 9/32	3 1/8	3 7/16	1 1/2	3 3/8	7-3XS	7-1B / 7-2D
17-672	2 1/4	4 3/4	2 13/32	3 7/32	3 3/16	3 13/32	1 5/8	3 3/8	7-3XS	7-1B / 7-2D
17-674	2 5/16	5	2 13/32	3 5/16	3 9/32	3 21/32	1 5/8	3 1/2	7-3XS	7-1B / 7-2D
17-676	2 3/8	5	2 13/32	3 3/8	3 3/8	3 5/8	1 3/4	3 1/2	7-3XS	7-1B / 7-2D
17-678	2 7/16	4 1/2	2 3/8	3 1/2	1 1/2	3 7/32	1 3/4	3 1/2	7-3XS	7-1B / 7-2D
17-680	2 1/2	4 1/2	2 3/8	3 1/2	1 5/8	3	2 1/2	3 1/2	7-3XS	7-1B / 7-2D
17-682	2 9/16	4 7/8	2 3/8	3 3/8	1 5/8	3 1/2	2	3 3/8	7-3XS	7-1B / 7-2D
17-684	2 5/8	4 11/16	2 3/8	3 3/4	1 5/8	3 11/32	2	3 11/16	7-3XS	7-1B / 7-2D
17-686	2 11/16	4 11/16	2 3/8	3 3/4	1 13/16	2 1/2	2	3 11/16	7-3XS	7-1B / 7-2D
17-688	2 3/4	5 1/8	2 3/8	3 3/4	1 3/4	3 5/8	2	4 1/8	7-3XS	7-1B / 7-2D
17-690	2 13/16	5 1/8	2 3/8	4	1 13/16	2 27/32	2	4 1/8	7-3XS	7-1B / 7-2D
17-692	2 7/8	4 7/8	2 3/8	4	1 13/16	3 9/16	2	3 7/8	7-3XS	7-1B / 7-2D
17-694	2 15/16	4 7/8	2 3/8	4 1/8	2 1/32	2 11/16	2	3 7/8	7-3XS	7-1B / 7-2D
17-696	3	5 1/8	2 3/8	4 1/4	2 1/32	3 7/8	2 3/8	4 1/8	7-3XS	7-1B / 7-2D
17-6100	3 1/8	5 1/8	2 3/8	4 3/8	2 1/32	3 1/32	2 3/8	4 1/8	7-3XS	7-1B / 7-2D
17-6104	3 1/4	5 3/8	2 3/8	4 1/2	2 1/32	3 1/32	2 3/8	4 3/8	7-3XS	7-1B / 7-2D
17-6108	3 3/8	5 1/2	2 3/8	4 5/8	2 1/4	3 5/16	2 1/2	4 1/2	7-3XS	7-1B / 7-2D
17-6112	3 1/2	5 1/2	2 3/8	4 3/4	2 1/4	4 3/32	2 1/2	4 1/2	7-3XS	7-1B / 7-2D
17-6116	3 5/8	5 1/2	2 3/8	5	2 1/8	4 3/32	2 5/8	4 1/2	7-3XS	7-1B / 7-2D
17-6118	3 11/16	5 17/32	2 3/8	5 5/16	2 7/16	3 7/8	2 3/4	4 17/32	7-3XS	7-1B / 7-2D
17-6120	3 3/4	5 9/16	2 3/8	5 1/4	2 1/4	3 19/32	2 13/16	4 9/16	7-3XS	7-1B / 7-2D
17-6122	3 13/16	5 31/32	2 3/8	5 5/8	2 17/32	4 11/32	2 5/8	4 31/32	7-3XS	7-1B / 7-2D
17-6124	3 7/8	5 9/16	2 3/8	5 1/4	2 9/16	3 5/8	3	4 9/16	7-3XS	7-1B / 7-2D
17-6126	3 15/16	6 1/16	2 3/8	5 1/2	2 13/32	4 13/32	3	5 1/16	7-3XS	7-1B / 7-2D
17-6128	4	6 1/8	2 3/8	5 1/2	2 17/32	4 3/32	2 7/8	5 1/8	7-3XS	7-1B / 7-2D
17-6130	4 1/16	6 1/8	2 3/8	5 1/2	2 15/32	4 1/2	3	5 5/32	7-3XS	7-1B / 7-2D
17-6132	4 1/8	6 1/8	2 3/8	5 17/32	2 17/32	4 5/32	2 7/8	5 1/8	7-3XS	7-1B / 7-2D
17-6134	4 3/16	6 7/32	2 3/8	6	2 1/2	4 9/16	3	5 7/32	7-3XS	7-1B / 7-2D
17-6136	4 1/4	6 3/32	2 3/8	5 3/4	2 5/8	4 9/16	3 1/8	5 3/32	7-3XS	7-1B / 7-2D
17-6138	4 3/8	6 11/32	2 3/8	5 13/16	2 21/32	4 5/8	3 3/8	5 11/32	7-3XS	7-1B / 7-2D
17-6140	4 3/8	6 13/32	2 3/8	5 27/32	2 5/8	4 9/16	3 1/8	5 13/32	7-3XS	7-1B / 7-2D
17-6142	4 7/16	6 13/32	2 3/8	6	2 21/32	4 9/16	2 5/8	5 13/32	7-3XS	7-1B / 7-2D
17-6144	4 1/2	7	2 3/8	6	2 3/4	5	3 1/8	6	7-3XS	7-1B / 7-2D
17-6146	4 9/16	7 1/8	3 1/4	6 1/2	2 3/4	4 19/32	3 3/8	6 1/8	8-1XS	7-1C - 7-2F
17-6148	4 7/8	7 1/8	3 1/4	6 13/16	2 13/16	4 3/32	3 1/2	6 1/8	8-1XS	7-1C - 7-2F
17-6152	4 3/4	6 3/4	3 1/4	6 5/8	2 29/32	4 29/32	3 1/2	5 3/4	8-1XS	7-1C - 7-2F
17-6156	4 7/8	7 1/4	3 1/4	7	3	5 5/32	3 1/2	6 1/4	8-1XS	7-1C - 7-2F
17-6160	5	7 3/4	3 1/4	7	3	5 21/32	3 1/2	6 3/4	8-1XS	7-1C - 7-2F
17-6172	5 3/8	8	3 1/4	7 1/2	3 3/8	5 25/32	3 21/32	7	8-1XS	7-1C - 7-2F
17-6184	5 3/4	8	3 1/4	8 1/4	3 3/16	6 1/32	4	7	8-1XS	7-1C - 7-2F

Fed. Spec: ANSI B107.2

TOOLS@HEIGHT
DROP PREVENTION SYSTEM

Side hole in socket permits use with Snap-on Industrial Brands Tools@Height drive tools such as ratchets, extensions and u-joints



17-660

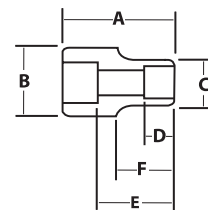

Features

- SUPERTORQUE® lobular openings for greater turning power without deforming the fastener.
- Designed for maximum engagement on 6 point fasteners.
- Suitable for use with pneumatic and electric impact wrenches.
- Specially heat treated for impact use to provide long life, safety, and durability.



WARNING