



Model 1040-AP205 Cloud or Canopy Ceiling WAP Installation Kit-AP205

Category: Suspended Ceiling Mounts



Model 1040 is an economical, easy-to-install cloud or canopy mounting kit for WAPs from most vendors. A cutout is made in the ceiling panel, the panel bridge is placed above the ceiling panel, and the white trim is placed around the WAP. The WAP is attached to a universal mounting T-bar and pressed into the panel bridge. The WAP is now recessed into the ceiling much like a recessed light fixture for unobstructed wireless coverage. WAP trim can be swapped out for alternate WAP brands.

Patent pending

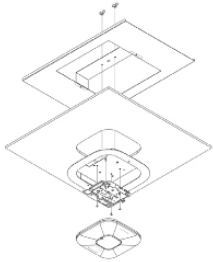

Features & Benefits

- Conveniently and quickly install wireless access points in cloud or canopy ceiling panels
- Access point mounts flush to the ceiling, providing an aesthetic, professionally installed appearance
- 20 ga. galvanized steel panel bridge and adjustable hanger wire prevent ceiling panel sag or cracking

Technical Specifications

- Recessed ceiling mount for cloud or canopy ceiling panels
- Includes adjustable hanger wire to attach to the building structure

Standards for Safety

- UL 2416, Audio/Video, Information and Communication Technology Equipment Cabinet, Enclosure & Rack Systems
- CSA C22.2 NO. 60950-1-07 + Amd. 1 Amd. 2 Information Technology Equipment -- Safety. Part 1, General Requirements

Configurations

AP-specific trim is included with the product; please specify the trim required.

Note: The trim is interchangeable after installation. Please contact your Oberon representative for additional trim options.

Model Number	Description	Retrofit trim P/N
1040-AP205	Small trim for Aruba Networks AP205	37-4X-AP205
1040-AP215	Small trim for Aruba Networks AP215	37-4X-AP215
1040-AP225	Small trim for Aruba Networks AP225	37-4X-AP225
1040-AP325	Small trim for Aruba Networks AP325	37-4X-AP325
1040-CCOAP	Small trim for Cisco Enterprise APs	37-4X-CCOAP
1040-3800CCOAP	Small trim for Cisco 3800 APs	37-4X-3800CCOAP
1040-HLA	Small trim for Cisco AP with hyperlocation antenna	37-4X-HLA

Measurements *(Maximum values):*

- Height: 18 in.
- Width: 23.75 in.
- Depth: 3 in.
- Item Weight: 4 lbs.
- Shipping Weight: N/A

Includes

- (1) 18" x 23.75" galvanized steel ceiling panel bridge
- (1) AP-specific, white powder-coated trim (see Configurations)
- (1) T-bar bracket or mounting bracket
- Adjustable hanger wire
- Installation instructions

Documentation Links

-  [Spec Sheet](http://oberoninc.com/index.php?option=com_content&view=article&id=2319&Itemid=399) - oberoninc.com/index.php?option=com_content&view=article&id=2319&Itemid=399
-  [Installation Instructions](http://oberoninc.com/images/WebDocs/Model1040-AN_Installation_Instructions.pdf) - oberoninc.com/images/WebDocs/Model1040-AN_Installation_Instructions.pdf
-  [Customer Prints](http://oberoninc.com/images/WebDocs/Model1040_XX_CustomerPrint.pdf) - oberoninc.com/images/WebDocs/Model1040_XX_CustomerPrint.pdf
-  [SECTION 27_21_33 DATA COMMUNICATIONS WIRELESS ACCESS POINTS](http://oberoninc.com/images/WebDocs/SECTION_27_21_33_DATA_COMMUNICATIONS_WIRELESS_ACCESS_POINTS.pdf) -
[http://oberoninc.com/images/WebDocs/SECTION 27_21_33 DATA COMMUNICATIONS WIRELESS ACCESS POINTS.pdf](http://oberoninc.com/images/WebDocs/SECTION_27_21_33_DATA_COMMUNICATIONS_WIRELESS_ACCESS_POINTS.pdf)

Images and documents may depict similar models in the product series.

Dimensional Images

