

SURFACE MOUNT TO VESA
OPTION

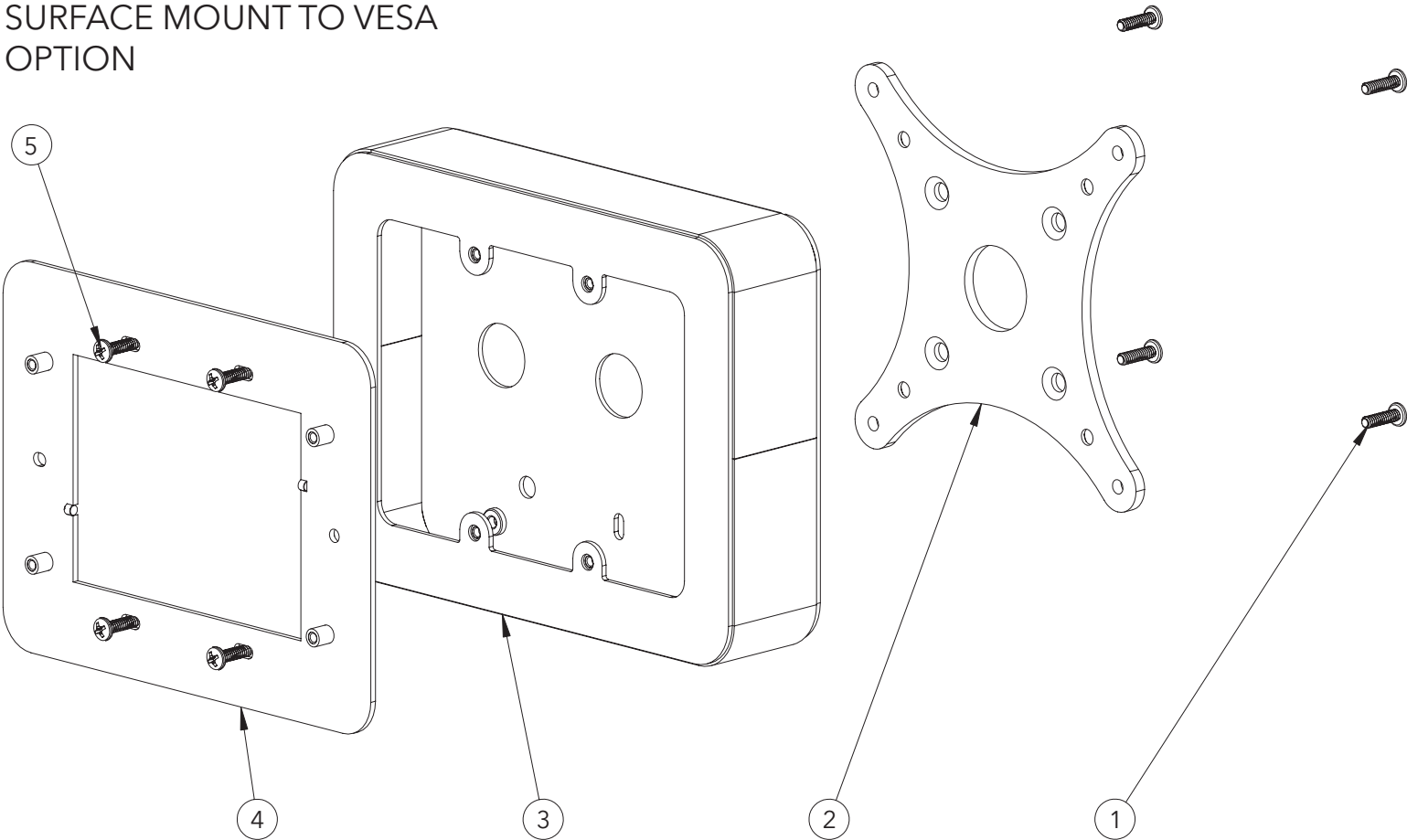

- 1. Install item No.1 (supplied with VESA 1. Mount) and fasten items No.2 and No.3.
- 2. Install Item No.4 to Item No.3 via Item No.5.
- 3. Follow the standard unit install instruction steps from the nano NXT™ Installation Manual.

nano N>XT™
SURFACE MOUNT / VER. 1.0.1

REQUIRED ITEMS

ITEM	DESCRIPTION	INCLUSION	QTY.
1	M4 SCREWS FOR VESA MOUNT	INCLUDED	4
2	VESA MOUNT	NOT INCLUDED	1
3	SURFACE MOUNT BOX	INCLUDED	1
4	WALL MOUNTING PLATE	INCLUDED WITH NANO NXT	1
5	6/32 SCREWS MOUNTING PLATE	INCLUDED WITH NANO NXT	4



For technical assistance contact us at 855-393-5625.
Or visit us at help.eyelock.com.

SURFACE MOUNT TO SINGLE GANG BOX OPTION

- 1. Install Item No.1 to Single Gang Box via Item No.2.
- 2. Install Item No.3 to Item No1 via Item No.4.
- 3. Follow the standard unit install instruction steps from the nano NXT™ Installation Manual.

REQUIRED ITEMS

ITEM	DESCRIPTION	INCLUSION	QTY.
1	SURFACE MOUNT BOX	INCLUDED	1
2	6/32 SCREWS GANG BOX	NOT INCLUDED	2
3	WALL MOUNTING PLATE	INCLUDED WITH NANO NXT	1
4	6/32 SCREWS MOUNTING PLATE	INCLUDED WITH NANO NXT	4

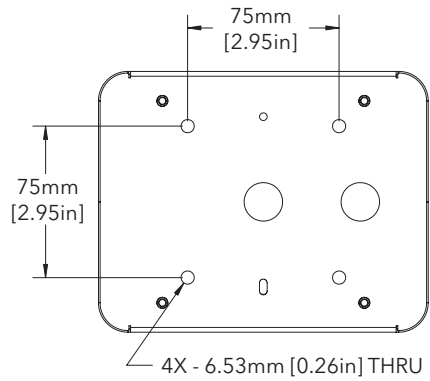
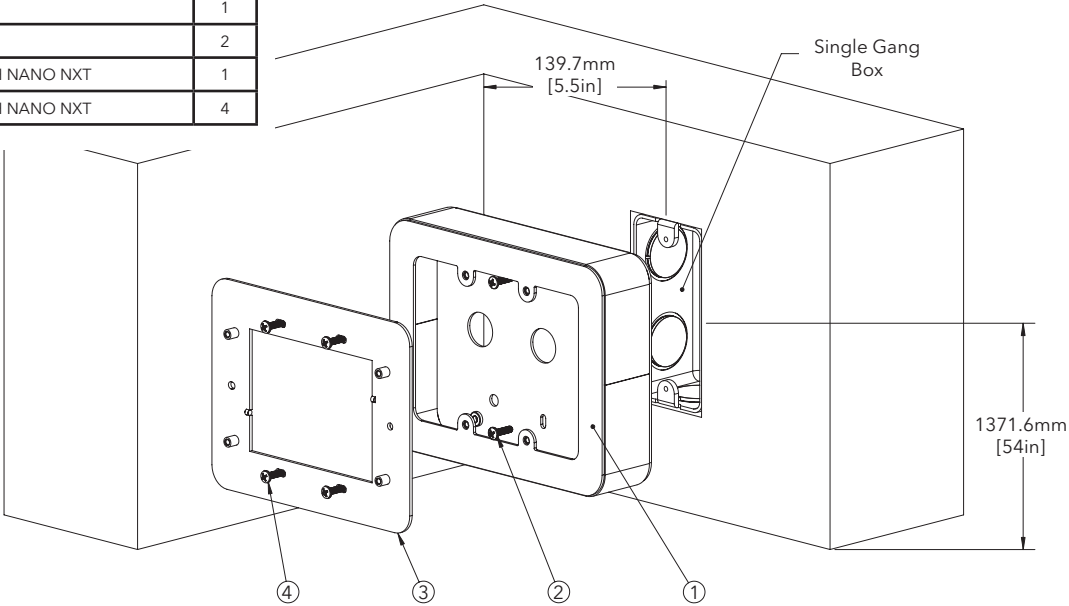
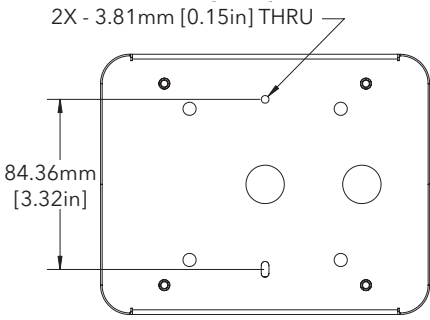

SURFACE MOUNT TO MOUNTING SURFACE OPTION

- 1. Use item No.1 to mark and drill installation holes to mounting substrate.
- 2. Install Item No.1 to wall via Item No.2.
- 3. Follow the standard unit install instruction steps from the nano NXT™ Installation Manual.

REQUIRED ITEMS

ITEM	DESCRIPTION	INCLUSION	QTY.
1	SURFACE MOUNT BOX	INCLUDED	1
2	3/16 TAPCON SCREWS	NOT INCLUDED	4
3	WALL MOUNTING PLATE	INCLUDED WITH NANO NXT	1
4	6/32 SCREWS MOUNTING PLATE	INCLUDED WITH NANO NXT	4

