

THIS COPY IS PROVIDED ON A RESTRICTED BASIS AND IS NOT TO BE USED IN ANY WAY DETRIMENTAL TO THE INTERESTS OF PANDUIT CORP.

NOTES:

1. IDENTIFICATION: VERTICAL, MIXED (24) C-13 & (6) C-19 NETWORKED 230/400V / 32A / THREE-PHASE WYE POU

PART NO.	COLOR
QZ1D2P6BM30P1	BLACK

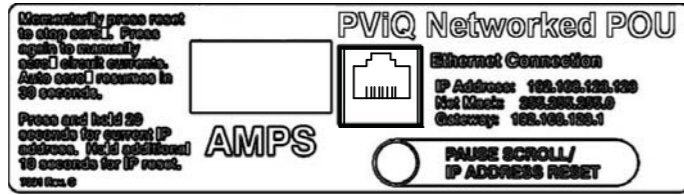

DETAIL A (SCALE 4X)

PANDUIT P/N	WEIGHT
QZ1D2P6BM30P1	17 lb (7.7 kg)

2. ACCESSORY COMPONENTS:  
 (4) #10-32 x 1/2" MOUNTING SCREWS  
 (4) #12-24 x 1/2" MOUNTING SCREWS  
 (2) #10-32 LOCKING COLLAR SCREWS  
 (2) L-BRACKETS

3. DIMENSIONS IN PARENTHESES ARE METRIC (mm).

4. CURRENT METER - RED, 4-DIGIT LED DISPLAY PROVIDES TRUE RMS CURRENT THAT CONTINUOUSLY SCROLLS THROUGH THE THREE DIFFERENT MEASURED CIRCUITS. METER DISPLAYS CIRCUIT NAME FOLLOWED BY THE MEASURED CURRENT (E.G. CR-1 REPRESENTS PHASE 1). BREAKER/PHASE (X,Y,Z) LEVEL MONITORING CAN ALSO BE ACCESSED REMOTELY VIA ETHERNET CONNECTION.

5. UNIT COMPLIES WITH IEC 60950-1, EN55022, EN55024, AND IS CE MARKED.

6. RoHS COMPLIANT.

7. VISIT OUR ON-LINE CATALOG AT WWW.PANDUIT.COM FOR A CURRENT LIST OF PRODUCTS APPLICABLE FOR USE WITH THIS PART.

8. MAXIMUM AVAILABLE POWER = 22.1 KW

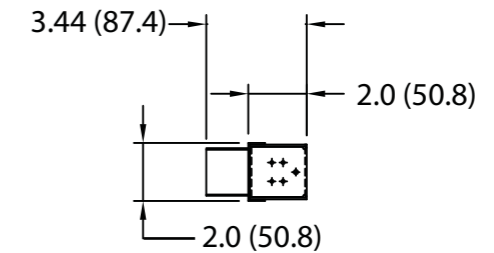
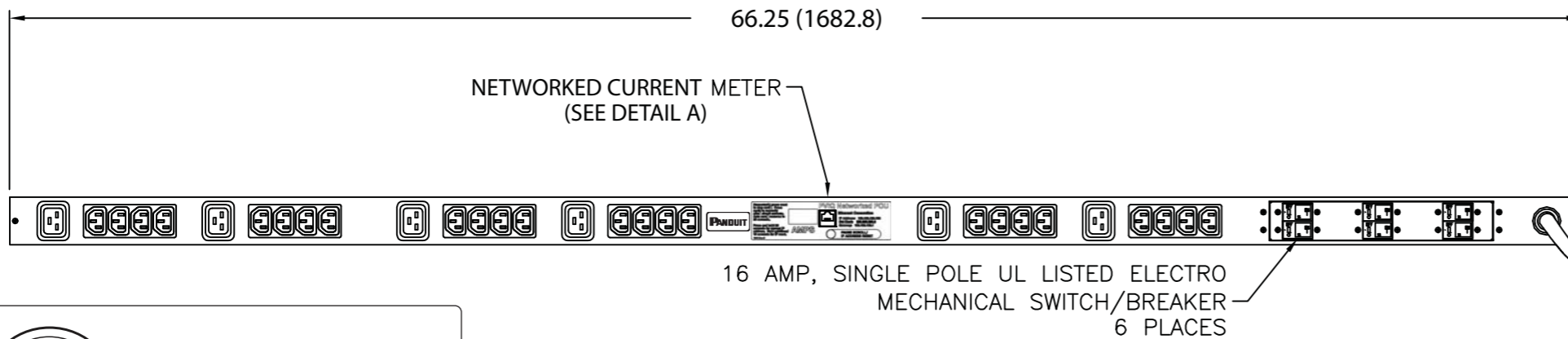
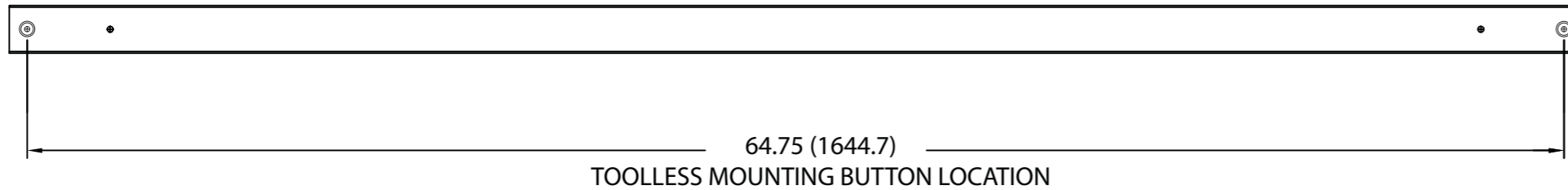

3 METER INLET POWER CORD

- PLUG  
32 AMP, 230/400V x 3~ WYE  
4P/5W  
IEC 60309, SPLASHPROOF
- TWENTY-FOUR (24)  
RECEPTACLES  
15 AMP, 250V  
STRAIGHT BLADE  
IEC 60320/C13
- SIX (6)  
RECEPTACLES  
20 AMP, 250V  
STRAIGHT BLADE  
IEC 60320/C19

MODEL FILENAME	09V098VB/00.PRT
CAD FILENAME/LAYERS	09V098VB_DC/00A.PRT

**PANDUIT** CORP. TINLEY PARK, ILLINOIS

VERTICAL, MIXED (24) C-13 & (6) C-19, NETWORKED POWER OUTLET UNIT (QZ1D2P6BM30P1)  
CUSTOMER DRAWING

UNLESS OTHERWISE SPECIFIED, DIMENSIONAL TOLERANCES ARE:		UNLESS OTHERWISE SPECIFIED, ALL DIMENSIONS ARE GIVEN IN INCHES, THIRD ANGLE PROJECTION	
INCHES	X.XX +/- 0.03	[METRIC - MILLIMETER]	X.XX +/- 0.8
	X.XXX +/- 0.015		X.XX +/- 0.4
	X.XXX +/- 0.005		X.XX +/- 0.13
DRAWN BY	MAV	MAT'L:	
DATE	2-7-11	SCALE	NONE
CHK'D	KRKE	DRAWING NO.	09V098VB
		DWG SIZE	B