

ULISSE MAXI NETCAM

FULL IP PTZ UNIT FOR NETWORK CAMERAS FOR DYNAMIC MONITORING OF LARGE OUTDOOR AREAS

FEATURES

For Network cameras compatible with ONVIF protocol, Profile S, or equipped with RS485 serial port

Direct access to camera web pages via VT Tunneling

Variable speed: 0.02°-20°/s Pan and Tilt

Horizontal continuous rotation, vertical +45°/-20°

Weatherproof housing for large-size lenses

IP66

Optical sensors for absolute positioning feedback

Camera and lens maximum allowed weight is 7.6kg

Integrated wiper

Position accuracy: 0.02°

Operating temperature: -10°C / +60°C (14°F / 140°F)

Up to 250 Presets

Power supply available 230Vac, 24Vac or 120Vac

OPTIONS:

Germanium window for thermal cameras

Perrangement for mounting of two UPTIRN LED illuminators

DESCRIPTION

ULISSE MAXI NETCAM is a powerful Full-IP PTZ for outdoor IP video surveillance, which can manage modern IP SD, HD and Megapixel cameras, with integration in a network system.

This model can contain and manage the largest motorised lenses on the market, with a total weight of up to almost 8 kilos. This way a single unit can provide a 360° coverage of the area to be monitored.

A special feature of ULISSE MAXI NETCAM is the ability to easily control, via the network, all the camera's pan & tilt functions, including wiper, preset and set-up, using the most common VMS on the market.

It is possible to use any ONVIF compatible Profile S camera, or proprietary protocol on RS-485, whilst the entire management of the system only requires an IP address.

The unit is equipped with a wiper for removing rain and dust from the front glass; there is a wide selection of jerry cans with washer pump, different capacities and heads.

To ensure detailed images even during the night hours, versions are available with LED illuminators, with infrared light or white light.

The sturdy mechanical structure and the powerful motors of this PTZ are designed to guarantee maximum resistance to high operating stress, vibrations and temperatures between -10°C to +60°C.

The unit is equipped with optical sensors which ensure the accurate control of the position in any condition of use.

Models are available for vision with a thermal camera.



ULISSE MAXI NETCAM + 2 UPTIRN



ULISSE MAXI + UPTWB TAB

TECHNICAL DATA**GENERAL**

Built in aluminium and ABS
 Epoxypolyester powder painting, RAL9002 colour
 Top mount (OTT)
 Transmission through toothed belt
 Slip-ring
 Electronic limit switches
 Plug installation thanks to connector and easy replacement on-site
 Zero backlash
 Max weight camera+lens: 7.6kg (17lb)
 Encoder for absolute positioning
 Configuration of telemetry protocol parameters through dip-switch for RS485

MECHANICAL

Cable glands: 3xM16
 Horizontal rotation: continuous
 Vertical rotation: from +45° up to -20° -4°F)
 Horizontal speed (variable): from 0.02°/s up to 20°/s
 Tilt speed (variable): from 0.02°/s up to 20°/s
 Internal usable area: See drawings
 Enclosure glass window (WxH): 112x95mm (4.4x3.7in)
 Preset accuracy: 0.02°
 Unit weight: 30kg (66lb)
 ULISSE MAXI NETCAM, for thermal cameras:
 Germanium window

- Diameter: 85mm (3.3in) (external), 70mm (2.8in) (usable diameter)
- Thick: 2mm (0.07in)
- External scratch-resistant treatment: Hard Carbon Coating (DLC)
- Internal antireflection treatment

 Spectral range: from 7.5µm up to 14µm
 Medium transmittance (from 7.5µm up to 11.5µm): 94%
 Medium transmittance (from 11.5µm up to 14µm): 90%

ELECTRICAL

Suitable for use with network cameras
 Power supply/Current consumption:

- 230Vac, 0.4A, 50/60Hz
- 24Vac, 4A (8A with LED illuminators), 50/60Hz
- 120Vac, 0.8A, 50/60Hz

 Power consumption:

- 100W
- 150-190W max with LED illuminators in 24Vac
- 24W, P&T stopped, heating switched off

 Camera power supply: 12Vdc (800mA)
 4 self-powered alarm inputs
 2 dry contacts: 30Vdc max or 30Vac, @ 1A

COMMUNICATIONS

Ethernet connection: IEEE 802.3 100Base-Tx

PROTOCOLS

ONVIF, S profile

ENVIRONMENT

Indoor/Outdoor
 Operating temperature (with heater): -10° (14°F)/+60°C (140°F)
 Surge immunity: up to 2kV line to line, up to 4kV line to earth (Class 4)

CERTIFICATIONS

Electrical safety: EN60950-1
 Photobiological safety of lamps and lamp systems (LED illuminators): EN62471
 Electromagnetic compatibility: , EN55022 (Class A), FCC Part 15 (Class A)
 Immunity: EN50130-4
 Outdoor installation: EN60950-22
 IP protection degree: EN60529 (IP66)
 Resistant to salty fog: EN50130-5, EN60068-2-52
 EAC certification

ACCESSORIES

UPTJBUL	Junction weatherproof box for cables connexion (according UL norm)
UPTIRN108A00	LED illuminator for ULISSE, 10°, 850nm, 24Vac - 12/24Vdc
UPTIRN308A00	LED illuminator for ULISSE, 30°, 850nm, 24Vac - 12/24Vdc
UPTIRN608A00	LED illuminator for ULISSE, 60°, 850nm, 24Vac - 12/24Vdc
UPTIRN109A00	LED illuminator for ULISSE, 10°, 940nm, 24Vac - 12/24Vdc
UPTIRN309A00	LED illuminator for ULISSE, 30°, 940nm, 24Vac - 12/24Vdc
UPTIRN10WA00	LED illuminator for ULISSE, 10°, white light, 24Vac - 12/24Vdc
UPTIRN30WA00	LED illuminator for ULISSE, 30°, white light, 24Vac - 12/24Vdc
UPTIRN60WA00	LED illuminator for ULISSE, 60°, white light, 24Vac - 12/24Vdc
UPTIRPS230N	External power supply for ULISSE series, prearranged for two LED illuminators, and control to synchronize IR illuminators with camera Day/Night switching, IN 230Vac, in weatherproof box. Twilight sensor included.
UPTIRPS100N	External power supply for ULISSE series, prearranged for two LED illuminators, and control to synchronize IR illuminators with camera Day/Night switching, IN 100Vac, in weatherproof box
UPTIRPS120UL	External power supply for ULISSE series, prearranged for two LED illuminators, and control to synchronize IR illuminators with camera Day/Night switching, IN 120Vac, in weatherproof box. Twilight sensor included.
WASPT0V5L5M00	Water tank 5l, pump with delivery up to 5m (16ft), IN 230Vac-24Vac-120Vac
WASPT0V23L5M00	Water tank 23l, pump with delivery up to 5m (16ft), IN 230Vac-24Vac-120Vac
WASPT0V23L11M00	Water tank 23l, pump with delivery up to 11m (36ft), IN 230Vac-24Vac-120Vac
WASPT1V23L30M00	Water tank 23l, pump with delivery up to 30m (98ft) with water floating, IN 230Vac
WASPT3V23L30M00	Water tank 23l, pump with delivery up to 30m (98ft) with water floating, IN 120Vac

BRACKETS AND ADAPTORS

UPTWBA	Wall bracket with internal cable channel
UPTWBTAB	Parapet bracket with internal cable channel

PACKAGE

Model Number	Weight	Dimensions (WxHxL)	Master carton
--------------	--------	--------------------	---------------

ULISSE MAXI NETCAM - CONFIGURATION OPTIONS

	Voltage		Options		Video output	
UPT	1 230Vac	SL	W 230Vac and 120Vac, with wiper	A	N For Network cameras compatible with ONVIF protocol, Profile S, or with built-in telemetry output	00E
	2 24Vac		J 24Vac, with wiper and prearrangement for mounting of two UPTIRN (illuminators not included)			
	3 120Vac		G With germanium front window for thermal cameras applications			

Not all combinations are possible.

TECHNICAL DRAWINGS

Sizes in millimeters.

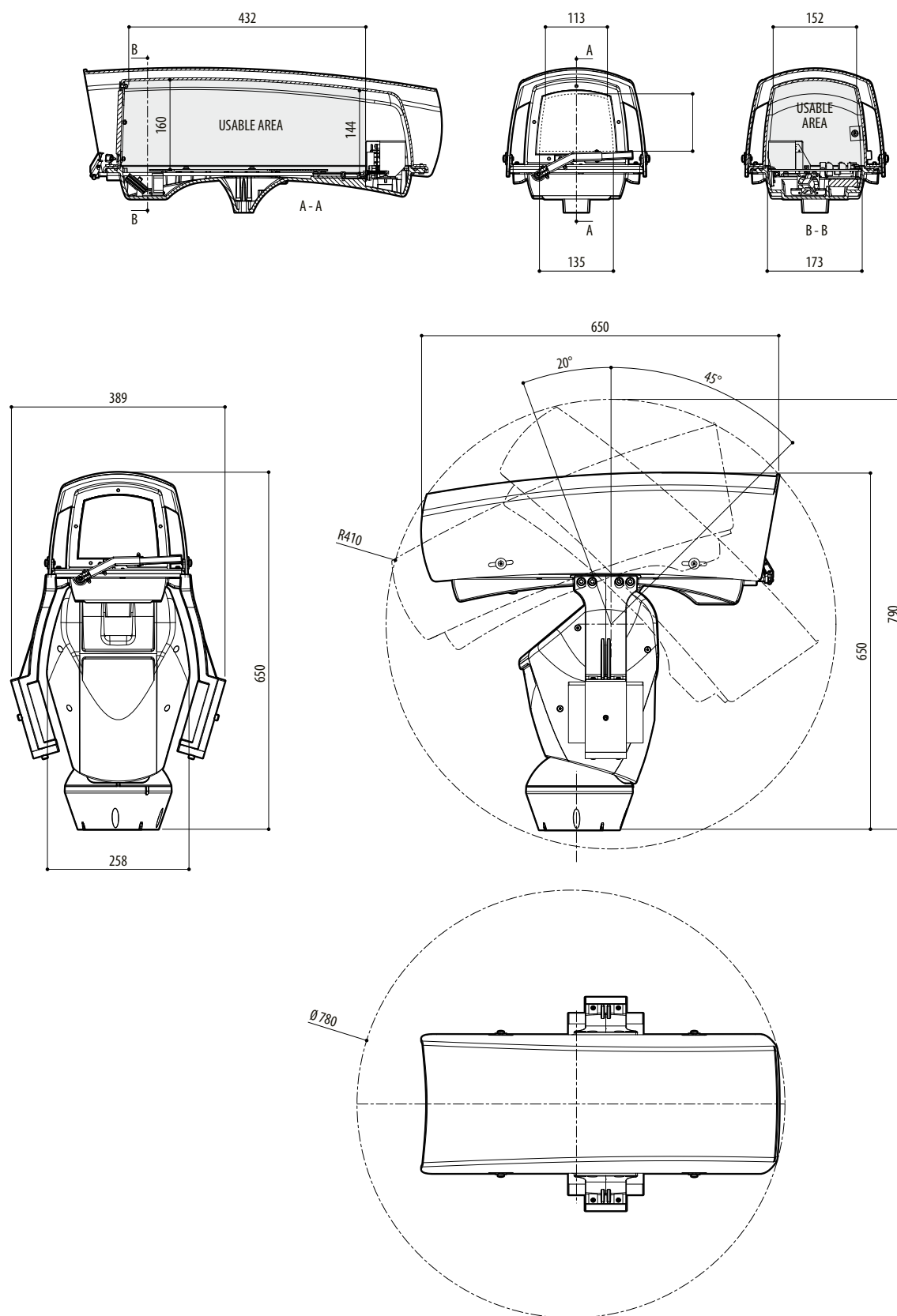

ULISSE MAXI

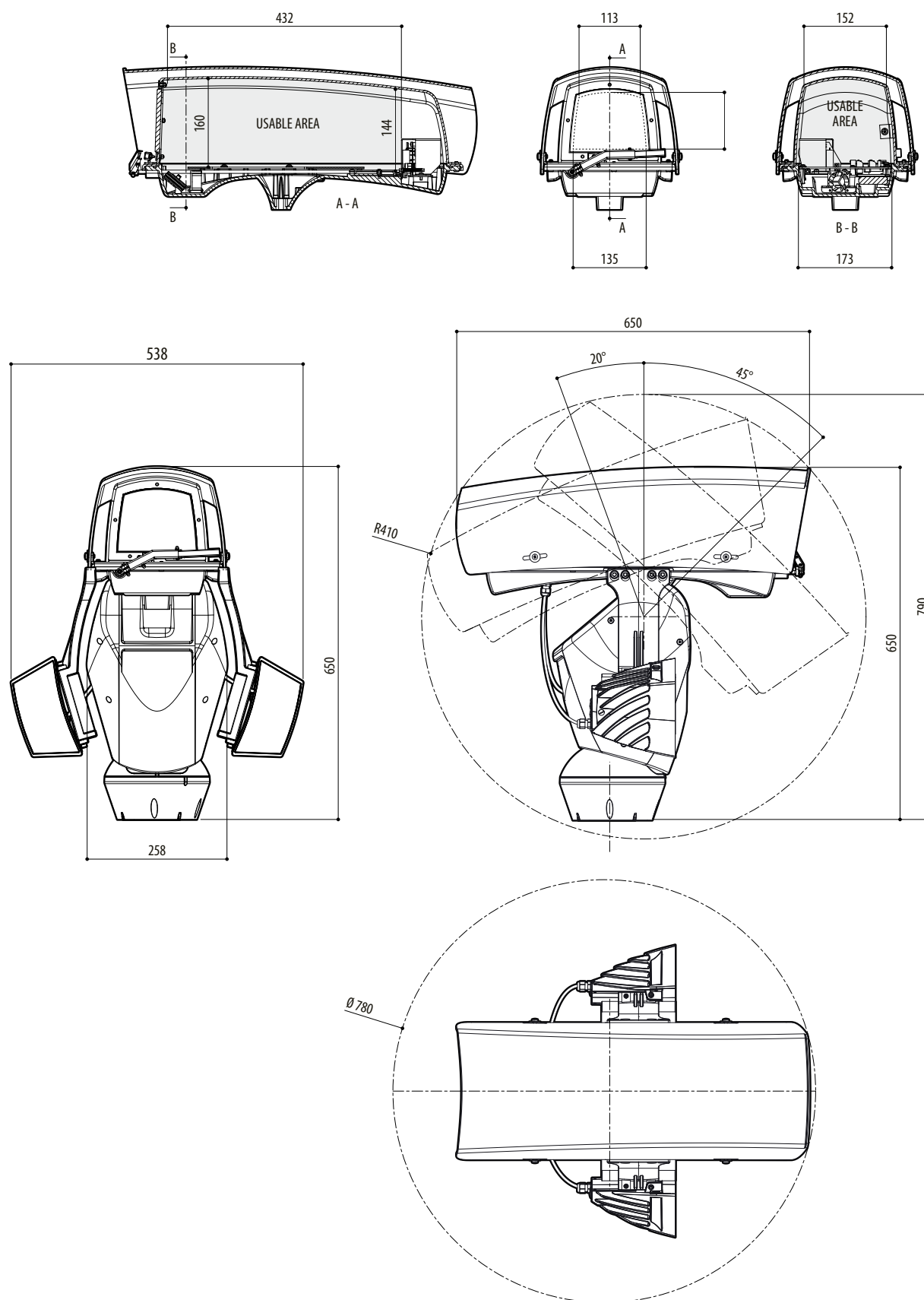

ULISSE MAXI NETCAM, PRE-ARRANGED VERSION FOR TWO LED ILLUMINATORS INSTALLATION

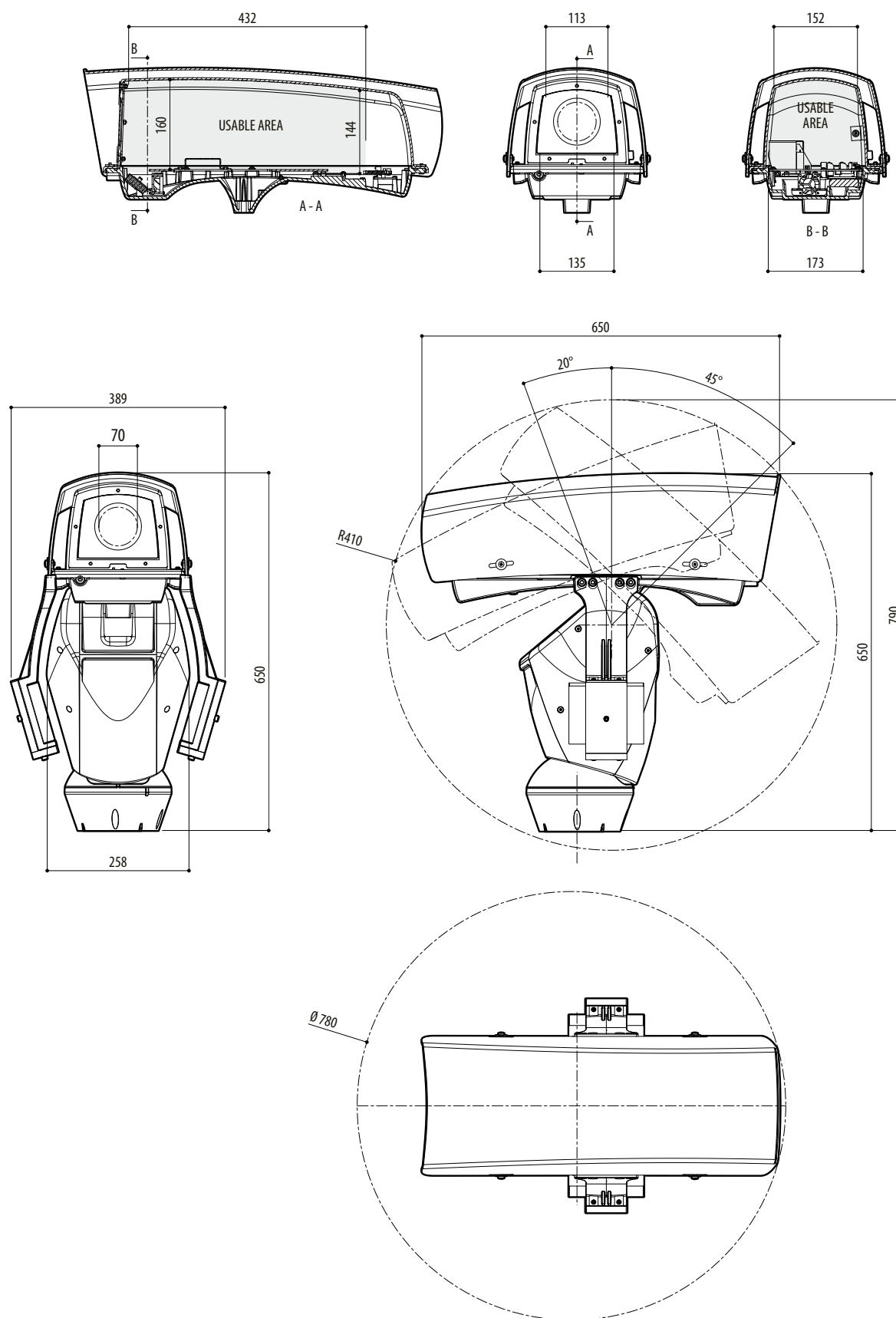

ULISSE MAXI NETCAM, VERSION FOR THERMAL CAMERAS

