

Versatile Four-Port Dual Band Ethernet Converter



WLI-TX4-AG300N

AirStation N300 Dual Band Wireless Ethernet Converter WLI-TX4-AG300N is a versatile wireless client used to wirelessly connect any four wired devices such as gaming consoles, printers, media players, desktop computers, laptops or any other wired device that has an Ethernet port but no native wireless capabilities. Simply connect the WLI-TX4-AG300N to your wireless network and you are ready to go. Once the Nfiniti Wireless-N Ethernet Converter is authenticated on your wireless network, you can plug in up to 4 wired devices and connect them to your wireless network. The Ethernet Converter itself remains completely transparent on your network.

Wirelessly connect to wired devices:



- Gaming Consoles
- Media Players
- Printers
- IP Phones
- Other Devices with an Ethernet Port



One-Time Setup

Can be moved from device to device without reconfiguration



Four Ethernet Ports

Features and Benefits

- Designed to IEEE 802.11n specifications
- Connects to IEEE 802.11n (2.4 GHz/5 GHz), 802.11g/b and 802.11a wireless networks
- Wireless connections with bit rates up to 300 Mbps*
- Push-button setup with AirStation One-Touch Secure System (AOSSTM)
- Four 10/100 ports for up to four simultaneous connections
- Simple Web browser configuration
- Supports multi-level security with WPA2, WPA-PSK (AES, TKIP) and 128/64-bit WEP
- Can be moved from device to device without reconfiguration
- Backward compatible with 802.11g, 802.11a, and 802.11b

Wired to Wireless Ethernet Converter

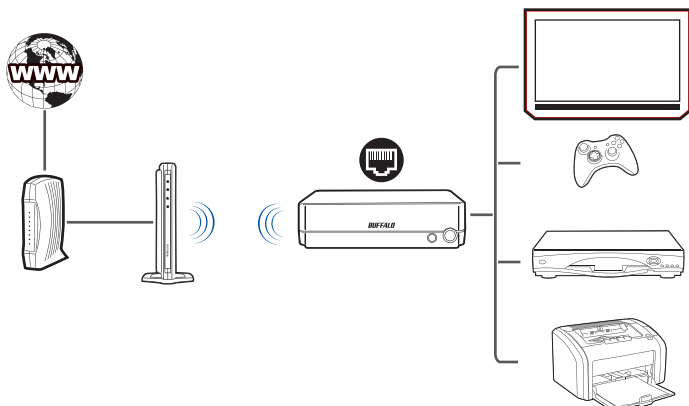

USAGE GUIDE

	COVERAGE	
	N150	N300
	SPEED	
	N150	N300
Internet	●	●
Email	●	●
Music	●	●
Internet Phone	●	●
Video	●	●
Gaming	●	●

WLI-TX4-AG300N



SPECIFICATIONS

Wireless LAN Interface

Standard Compliance	IEEE802.11a, IEEE802.11n, IEEE802.11g, IEEE802.11b
Frequency Range	2.4 GHz / 5 GHz
Security	WPA2-PSK (AES, TKIP), WPA-PSK (AES, TKIP), 128/64-bit WEP
Access Mode	Infrastructure mode, Ad-hoc mode

Wired LAN Interface

Standard Compliance	IEEE802.3u (100 Base-TX), IEEE802.3 (10 Base-T)
Transmission Rate	10/100 Mbps (Auto-Sensing)
LAN Port Connector	RJ-45 (Auto MDIX)
Number of LAN Ports	4

Other

OS Compatibility	Windows Vista® (32bit), Windows® XP, Windows® 2000, Mac OS® X 10.4 - 10.7**
Dimensions (WxHxD in.)	5.5 x 1.5 x 5.5
Weight (oz.)	9.87
Power Consumption	Max 9W
Operating Environment	32-104° F, 10-85% (non-condensing)
Power Supply	AC100-240V, 50/60Hz

*300 Mbps is the maximum wireless signal rate derived from IEEE 802.11n standard specifications. Actual data throughput and range will vary depending upon network conditions and environmental factors, including volume of network traffic, building materials and construction, and network overhead.

**AOSS support requires use of Buffalo Client Manager software which is only compatible with Windows® systems. Some initial setup utilities only work with Windows systems.

About Buffalo

www.buffalotech.com

Buffalo Technology (USA), Inc., based in Austin, Texas, is a leading global provider of award-winning networking, storage and multimedia solutions for the home and small business environments as well as for system builders and integrators. With almost three decades of networking and computer peripheral experience, Buffalo has proven its commitment to delivering innovative solutions that have put the company at the forefront of infrastructure technology.