

**DEEP 22.5-MM PUSHBUTTON ENCLOSURES, TYPE 12**

**INDUSTRY STANDARDS**

 UL 508A Listed; Type 12, 13; File No. E61997  
 cUL Listed per CSA C22.2 No. 94; Type 12, 13; File No. E61997

 NEMA/EEMAC Type 12, 13  
 CSA File Number 42186: Type 12  
 IEC 60529, IP65

**APPLICATION**

Designed for pushbuttons and switches, the extra depth of these enclosures accommodates additional pushbutton contact blocks.

**SPECIFICATIONS**

- 14 gauge steel
- Seams continuously welded and ground smooth
- Captivated cover screws thread into sealed wells
- Grounding nut in body of enclosure
- Bonding provision on cover
- Oil-resistant gasket
- Enclosures with more than one column of pushbutton holes have internal detachable hinge
- External wall-mounting brackets
- Factory stamped 4-way pushbutton holes

**FINISH**

ANSI 61 gray polyester powder paint inside and out

**ACCESSORIES**

 See also *Accessories*.  
 Industrial Corrosion Inhibitors  
 HOL-SEALERS™ Hole Seals  
 Tamper-Resistant Screws

**BULLETIN: PB1**

## Standard Product

Catalog Number	AxBxC in./mm	Number of Holes	Mounting G x H in./mm	Overall L x W in./mm	J in./mm	T in./mm	X in./mm	Y in./mm
E1PBGXM	3.25 x 2.75 x 3.50	1	3.75 x 1.88	4.25 x 2.97	3.09	2.50	1.48	1.73
	83 x 70 x 89		95 x 48	108 x 75	78	64	38	44
E2PBGXM	5.12 x 2.75 x 3.50	2	5.62 x 1.88	6.12 x 2.97	3.09	2.50	1.48	1.55
	130 x 70 x 89		143 x 48	155 x 75	78	64	38	39
E3PBGXM	7.25 x 2.75 x 3.50	3	7.75 x 1.88	8.25 x 2.97	3.09	2.50	1.48	1.48
	184 x 70 x 89		197 x 48	210 x 75	78	64	38	38
E4PBGXM	9.50 x 2.75 x 3.50	4	10.00 x 1.88	10.50 x 2.97	3.09	2.50	1.48	1.48
	241 x 70 x 89		254 x 48	267 x 75	78	64	38	38
E6PBGXM	8.50 x 5.00 x 4.25	6	9.00 x 4.12	9.50 x 5.22	3.84	4.75	1.48	2.11
	216 x 127 x 108		229 x 105	241 x 133	98	121	38	54
E9PBGXM	8.50 x 7.25 x 4.25	9	9.00 x 5.63	9.50 x 7.47	3.84	6.25	1.48	2.11
	216 x 184 x 108		229 x 162	241 x 190	98	159	38	54
E12PBGXM	10.38 x 7.25 x 4.25	12	10.88 x 5.63	11.38 x 7.47	3.84	6.25	1.48	1.92
	264 x 184 x 108		276 x 162	289 x 190	98	159	38	49

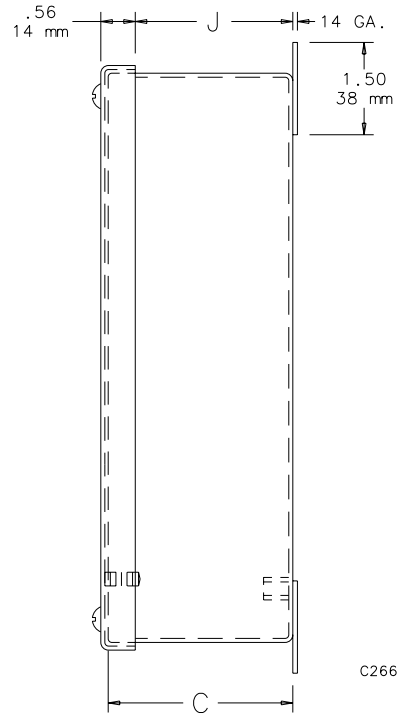
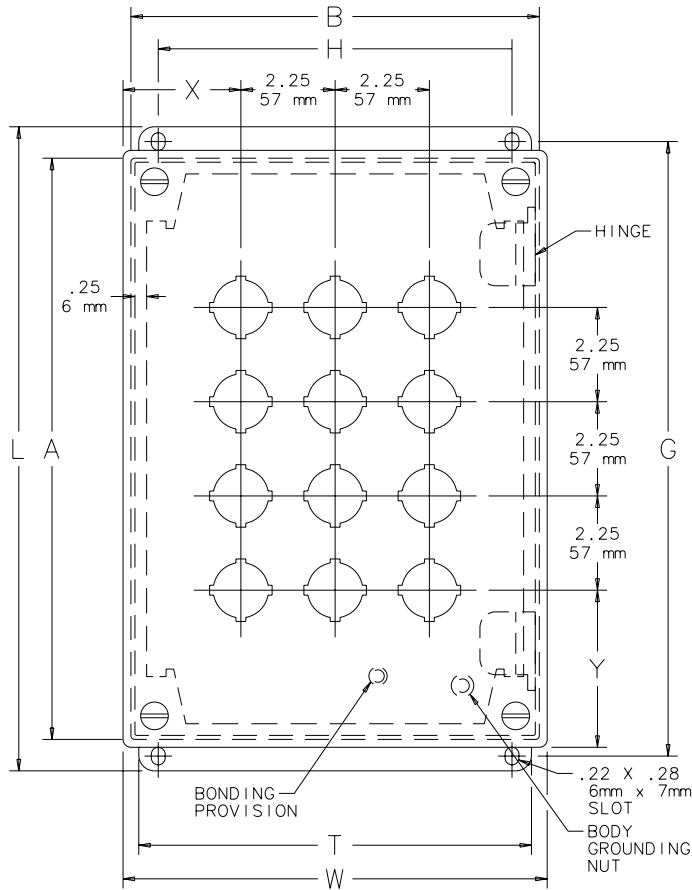

C2667-C

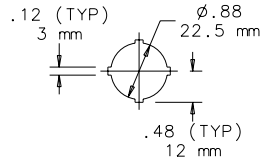

22.5mm 4-way

