

THIS COPY IS PROVIDED ON A RESTRICTED BASIS AND IS NOT TO BE USED IN ANY WAY DETRIMENTAL TO THE INTERESTS OF PANDUIT CORP.

PANDUIT P/N	WEIGHT
VB1B1L2BN30P1	17 lb (7.7 kg)

NOTES:

1. IDENTIFICATION: VERTICAL, (24) C13 & (6) C19, METERED 208V / 30A / SINGLE PHASE POU

PART NO. VB1B1L2BN30P1  
 COLOR BLACK

2. ACCESSORY COMPONENTS:

- (2) #10-32 x 1/2" MOUNTING SCREWS
- (2) #12-24 x 1/2" MOUNTING SCREWS
- (2) 10-32 LOCKING COLLAR SCREWS
- (2) L-BRACKETS

3. HEXAGONS ARE FOR COMMUNICATION PURPOSES.

4. POWER METER - RED, 4-DIGIT LED CONTINUOUSLY SCROLLS THROUGH POWER FACTOR, AMPS, VOLTS (RMS), AND REAL POWER IN WATTS (RMS).

5. UL® & c-UL® LISTED 60950.

6. RoHS COMPLIANT.

7. VISIT OUR ON-LINE CATALOG AT WWW.PANDUIT.COM FOR A CURRENT LIST OF PRODUCTS APPLICABLE FOR USE WITH THIS PART.

8. MAXIMUM AVAILABLE INPUT POWER = 5 KW

9. INSTALLATION SHALL COMPLY WITH ALL APPLICABLE NATIONAL, STATE, AND LOCAL CODES.

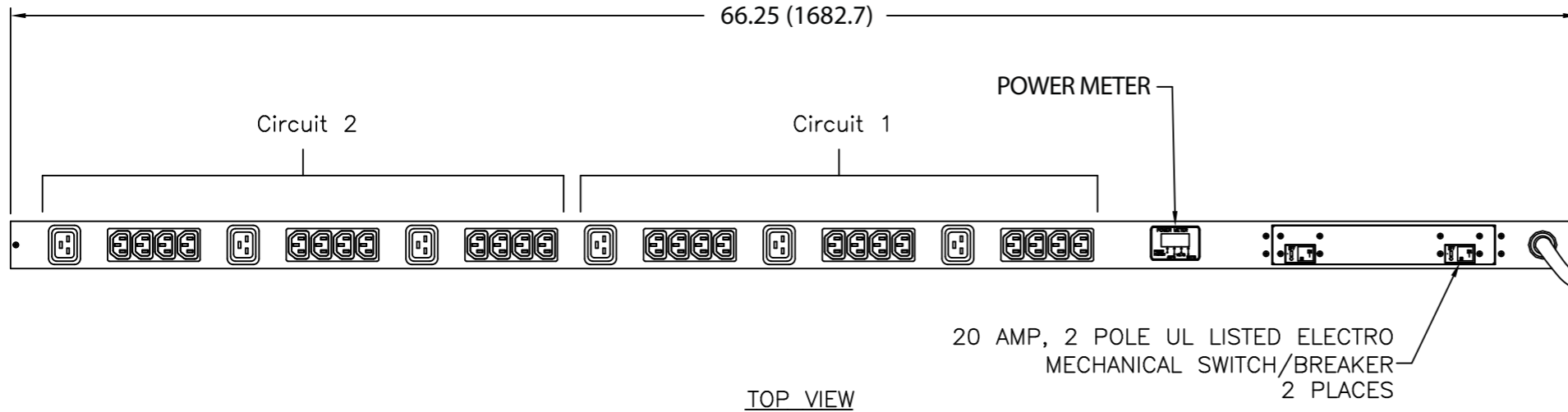

TOP VIEW

20 AMP, 2 POLE UL LISTED ELECTRO MECHANICAL SWITCH/BREAKER 2 PLACES

10 FOOT INLET POWER CORD

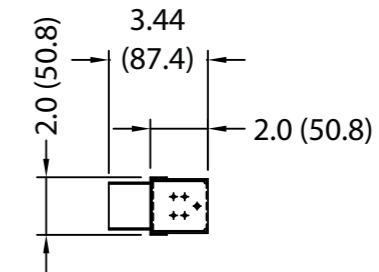

RIGHT SIDE VIEW

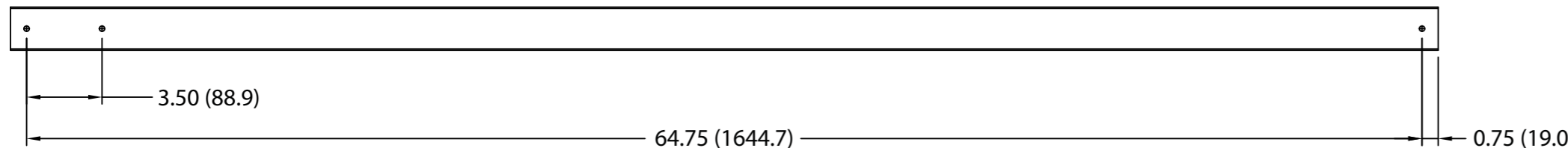

TOOLLESS MOUNTING BUTTON LOCATION

REAR VIEW



PLUG  
 30 AMP, 250V  
 TWIST-LOCK  
 NEMA L6-30P

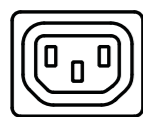

TWENTY-FOUR (24)  
 RECEPTACLES  
 15 AMP, 250V  
 STRAIGHT BLADE  
 IEC 60320/C13

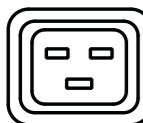

SIX (6)  
 RECEPTACLES  
 20 AMP, 250V  
 STRAIGHT BLADE  
 IEC 60320/C19

REV	DATE	BY	CHK	DESCRIPTION	ECN	R	CUST	SUP	OTH
00A	11-14-11	MRWA	KRKE	RELEASED TO PRODUCTION	09V098YX				

MODEL FILENAME	09V098YX/00.PRT
CAD FILENAME/LAYERS	09V098YX_DC/00A.PRT
<b>PANDUIT</b> CORP TINLEY PARK, ILLINOIS	
VERTICAL, (24) C13 & (6) C19, METERED POWER OUTLET UNIT CUSTOMER DRAWING	
UNLESS OTHERWISE SPECIFIED, DIMENSIONAL TOLERANCES ARE: INCHES X.X +/- 0.03 X.XX +/- 0.015 X.XXX +/- 0.005 [METRIC - MILLIMETER] X.X +/- 0.8 X.XX +/- 0.4 X.XX +/- 0.13 ANGLE +/- 1°	
UNLESS OTHERWISE SPECIFIED, ALL DIMENSIONS ARE GIVEN IN INCHES, THIRD ANGLE PROJECTION	SCALE NONE
DRAWN BY MRWA DATE 11-14-11 CHK'D KRKE	MAT'L: DRAWING NO. 09V098YX DWG SIZE B