



**FO42KMS5**  
**FlexTwist™ Flexible Twist for WR42, 17.7–26.5 GHz, with interface types PBR220 and UBR220, 1200 mm**

## Electrical Specifications

Operating Frequency Band	17.7 – 26.5 GHz
Attenuation	0.80 db/ft   2.62 db/m
Average Power	100 W
Peak Power	39.0 kW
VSWR	1.35

## General Specifications

Component	Flexible Twist
Waveguide Size	WR42   WG20   R220
Interface	PBR220
Interface 2	UBR220
Length	1200 mm   47 in

## Mechanical Specifications

Maximum Twist	510.00 °/m   155.00 °/ft
Minimum Bend Radius, Multiple Bends (E Plane)	38.00 mm   1.50 in
Minimum Bend Radius, Multiple Bends (H Plane)	76.00 mm   3.00 in
Pressurization, maximum	45 psi   310 kPa

Component

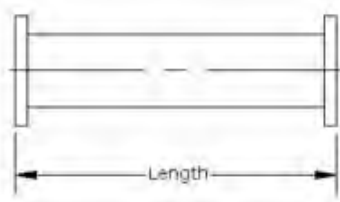

Interface

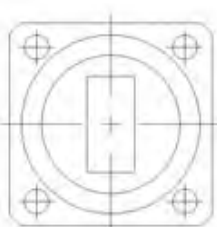

Interface 2

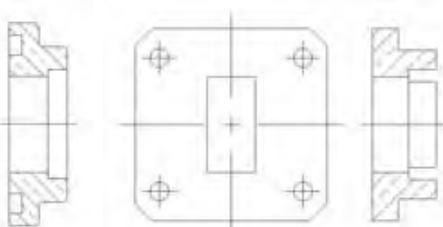

## Regulatory Compliance/Certifications

**Agency**

RoHS 2011/65/EU  
China RoHS SJ/T 11364-2006  
ISO 9001:2008

**Classification**

Compliant by Exemption  
Above Maximum Concentration Value (MCV)  
Designed, manufactured and/or distributed under this quality management system

# Product Specifications

COMMScope®

F042KMS5

POWERED BY

