



EO90MK091L091BN
90° E Plane Swept Bend for WR90, 10.7–11.7 GHz, with interface types PBR100 and UDR100, 91 mm x 91 mm, unpainted

Electrical Specifications

Operating Frequency Band	10.7 – 11.7 GHz
VSWR	1.02

General Specifications

Component	90° E Plane Swept Bend
Waveguide Size	WR90 WG16 R100
Finish	Unpainted
Interface	PBR100
Interface 2	UDR100
Length	91 mm 4 in
Length 2	91 mm 4 in

Component

Interface

Interface 2

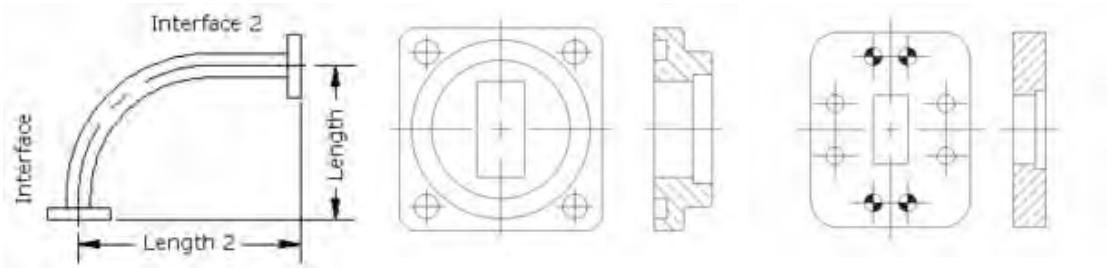

Regulatory Compliance/Certifications

Agency	Classification
ISO 9001:2008	Designed, manufactured and/or distributed under this quality management system