

# SmartZone™ 1RU Inline Meter

## specifications

The SmartZone™ 1RU Inline Meter extends real-time aggregate power monitoring intelligence for up to two individual non-intelligent power distribution units (PDUs) installed in a rack or cabinet enclosure. The inline meter is installed as part of a primary/secondary topology, where all the critical intelligence and monitoring power supply for the inline meter is retained within a connected gateway. The inline meter allows for 1RU mounting options. Data captured from the inline meter will be used to display operational data through connected gateway firmware or through SmartZone™ Software platforms.



## technical information

**Dimensions:** 482.60mm x 44.50mm (19" x 1.7")  
**Mounting:** 1 RU mounting

## key features and benefits

<b>Extended intelligence</b>	Layers intelligent monitoring capabilities for up to two individual non-intelligent PDUs to quickly and cost-effectively integrate DCIM benefits into legacy installations
<b>Multi-device support</b>	Consolidates individual monitoring of two different PDU devices through 1RU, cost-effectively adding monitoring to multiple PDU devices and saving valuable RU space
<b>Primary/secondary network topology</b>	Connects to a SmartZone™ Gateway device that houses the intelligence and monitoring power supply for the SmartZone™ 1RU Inline Meter within the gateway itself to simplify the network architecture and lower overall power consumption
<b>1RU form factor</b>	Offers 19" horizontal rack mountable unit that can be rack or underfloor mounted to optimize space within a cabinet or rack enclosure; front of rack display enables quick and easy access to power consumption data
<b>Vendor neutral</b>	Connects to any PDU to enable aggregate monitoring of any new or existing third-party devices, cost-effectively maximizing resources
<b>RJ45 connection</b>	Utilizes an RJ45 plug to quickly and easily connect SmartZone™ 1RU Inline Meter to a SmartZone™ Gateway port to simplify installation
<b>SmartZone™ Software Suite integration</b>	Captures actionable power and environmental data that can be utilized by SmartZone™ Software to enable data center operational and energy efficiencies, capacity management, and resilience

## applications

SmartZone™ Power Monitoring Devices capture power consumption data of non-intelligent, vendor neutral equipment within IT and facility domains. SmartZone™ Power Monitoring Devices operate using intelligence and monitoring power supplied by SmartZone™ Gateways, connected via RJ45 ports. The gateways collect data captured from the power monitoring devices for display via gateway firmware or for utilization by SmartZone™ Software platforms. Unique form factors simplify installations, allowing IT and Facility teams to quickly and easily retrofit legacy (brownfield) installations with intelligence capabilities in a manner that cost-effectively maximizes current resources.

The Panduit® SmartZone™ 1RU Inline Meter captures aggregate power for up to two separate non-intelligent PDUs by quickly installing between the PDU power plugs and their primary power source, and then easily plugging the 1RU Inline Meter into an RJ45 gateway port. This rack-mounted device installs as a 1RU device and supports monitoring of up to two installed PDUs to save overall space. This makes the SmartZone™ 1RU Inline Meter ideal for existing data centers that want to upgrade or maximize multiple PDUs per rack and gain instant access to power consumption data via front of rack displays. It rapidly initiates power consumption monitoring and measurement of existing installed PDUs without the expense, time, or trouble of installing new PDU equipment.

# SmartZone™ 1RU Inline Meter

## specifications

<b>Connectivity</b>	RS485 Interface
<b>Rated Voltage</b>	120V – 208V AC Single and Three Phase
<b>Rated Current</b>	Up to 30A, Single and Three Phase (model specific, see below)
<b>Rated Frequency</b>	50 Hz to 60 Hz
<b>Operating Temperature</b>	32°F to 104°F (0°C to 40°C)
<b>Measuring Accuracy</b>	+/- 2% (Single Phase), +/- 1% (Three Phase)
<b>Local Display</b>	LCD of Amps, Voltage and kWhr, KVA, power factor, frequency
<b>Display Resolution</b>	1 Volt, 0.01 Amp, 0.1 kWhr
<b>Cable Length/Input Plug</b>	3 meters cable length (Input plug model specific, see below)
<b>Output Plug/Cable length</b>	IEC 60309, (Commando), NEMA, 3 meter cable length (model specific, see below)
<b>Material</b>	Metal, Zintec, Black RAL-9005
<b>Safety Standards</b>	EN 60950-1/A12:2011, CAN/CSA C22.2 No. 60950-1/A1:2011 and UL 60950-1/R:2011-12, EN 55022, EN 55024

## part numbers

1RU Inline Meter (NA)	
GM-A0936BL	20A 120V-208V Single Phase, Commando Plugs and Sockets, 3 meter cable (dimensions: 19.0 in. x 1.73 in. [482mm x 44mm])
GM-A0937BL	20A 120V-208V Three Phase Delta, Commando Plugs and Sockets, 3 meter cable (dimensions: 19.0 in. x 3.0 [483mm x 76mm])
GM-A0939BL	30A 120V-208V Single Phase, Commando Plugs and Sockets, 3 meter cable (dimensions: 19.0 in. x 1.73 in. [482mm x 44mm])
GM-A0940BL	30A 208V Three Phase Delta, Commando Plugs and Sockets, 3 meter cable (dimensions: 19.0 in. x 3.0 [483mm x 76mm])
GM-A0945BL	20A 120V Single Phase NEMA L5-20P, L5-20R Plugs and Sockets, 3 meter cable (dimensions: 19.0 in. x 1.73 in. [482mm x 44mm])
GM-A0947BL	30A 120V Single Phase NEMA L5-30P, L5-30R Plugs and Sockets, 3 meter cable (dimensions: 19.0 in. x 1.73 in. [482mm x 44mm])
GM-A0948BL	20A 208V Single Phase NEMA L6-20P, L6-20R Plugs and Sockets, 3 meter cable (dimensions: 19.0 in. x 1.73 in. [482mm x 44mm])
GM-A0949BL	30A 208V Single Phase NEMA L6-30P, L6-30R Plugs and Sockets, 3 meter cable (dimensions: 19.0 in. x 1.73 in. [482mm x 44mm])
GM-A0946BL	20A 120V Single Phase NEMA 5-20P, 5-20R Plugs and Sockets, 3 meter cable (dimensions: 19.0 in. x 1.73 in. [482mm x 44mm])
Included in SmartZone™ Rack Energy Kits	
RMSL2T1POB09	(1) 1 RU Inline Meter (20A 120/208V Single Phase, Commando Plugs and Sockets) (1) Gateway, (2) Temperature Sensors and Rack Monitoring Software
RMSL2T1POB10	(1) 1 RU Inline Meter (20A 208V Three Phase Delta, Commando Plugs and Sockets) (1) Gateway, (2) Temperature Sensors and Rack Monitoring Software
RMSL2T1POB11	(1) 1 RU Inline Meter (30A 120/208V Single Phase, Commando Plugs and Sockets) (1) Gateway, (2) Temperature Sensors and Rack Monitoring Software
RMSL2T1POB12	(1) 1 RU Inline Meter (30A 208V Three Phase Delta, Commando Plugs and Sockets) (1) Gateway, (2) Temperature Sensors and Rack Monitoring Software
RMSL2T1POB13	(1) 1 RU Inline Meter (20A 120V Single Phase, NEMA L5-20P, L5-20R) (1) Gateway, (2) Temperature Sensors and Rack Monitoring Software
RMSL2T1POB14	(1) 1 RU Inline Meter (30A 120V Single Phase, NEMA L5-30P, L5-30R) (1) Gateway, (2) Temperature Sensors and Rack Monitoring Software
RMSL2T1POB15	(1) 1 RU Inline Meter (20A 208V Single Phase, NEMA L6-20P, L6-20R) (1) Gateway, (2) Temperature Sensors and Rack Monitoring Software
RMSL2T1POB16	(1) 1 RU Inline Meter (30A 208V Single Phase, NEMA L6-30P, L6-30R) (1) Gateway, (2) Temperature Sensors and Rack Monitoring Software
RMSL2T1POB25	(1) 1 RU Inline Meter (20A 120V Single Phase, NEMA 5-20P, 5-20R) (1) Gateway, (2) Temperature Sensors and Rack Monitoring Software

# SmartZone™ 1RU Inline Meter

## part numbers (continued)

SmartZone™ Gateway Devices	
ZARKMS-01-NA	SmartZone™ Gateway EP042 with IEC – NEMA 5-15 power cable
ZARKMS-01-UNI	SmartZone™ Gateway EP042 with IEC – IEC power cable
ZARKMS-01-99	SmartZone™ Gateway EP042 (no power cable)
ZAH13-01-NA	SmartZone™ Gateway EPA064 with IEC – NEMA 5-15 power cable
ZAH13-01-UNI	SmartZone™ Gateway EPA064 with IEC – IEC power cable
ZAH13-01-99	SmartZone™ Gateway EPA064 (no power cable)
ZAEI-01-NA	SmartZone™ Gateway EPA126 with IEC – NEMA 5-15 power cable
ZAEI-01-UNI	SmartZone™ Gateway EPA126 with IEC – IEC power cable
ZAEI-01-99	SmartZone™ Gateway EPA126 (no power cable)
ZAEIPEXP-01-NA	SmartZone™ Gateway Expansion Unit EPAX18 with IEC – NEMA 5-15 power cable
ZAEIPEXP-01-UNI	SmartZone™ Gateway Expansion Unit EPAX18 with EC power leads
ZAEIPEXP-01-99	SmartZone™ Gateway Expansion Unit EPAX18 (no power cable)

## nema plug

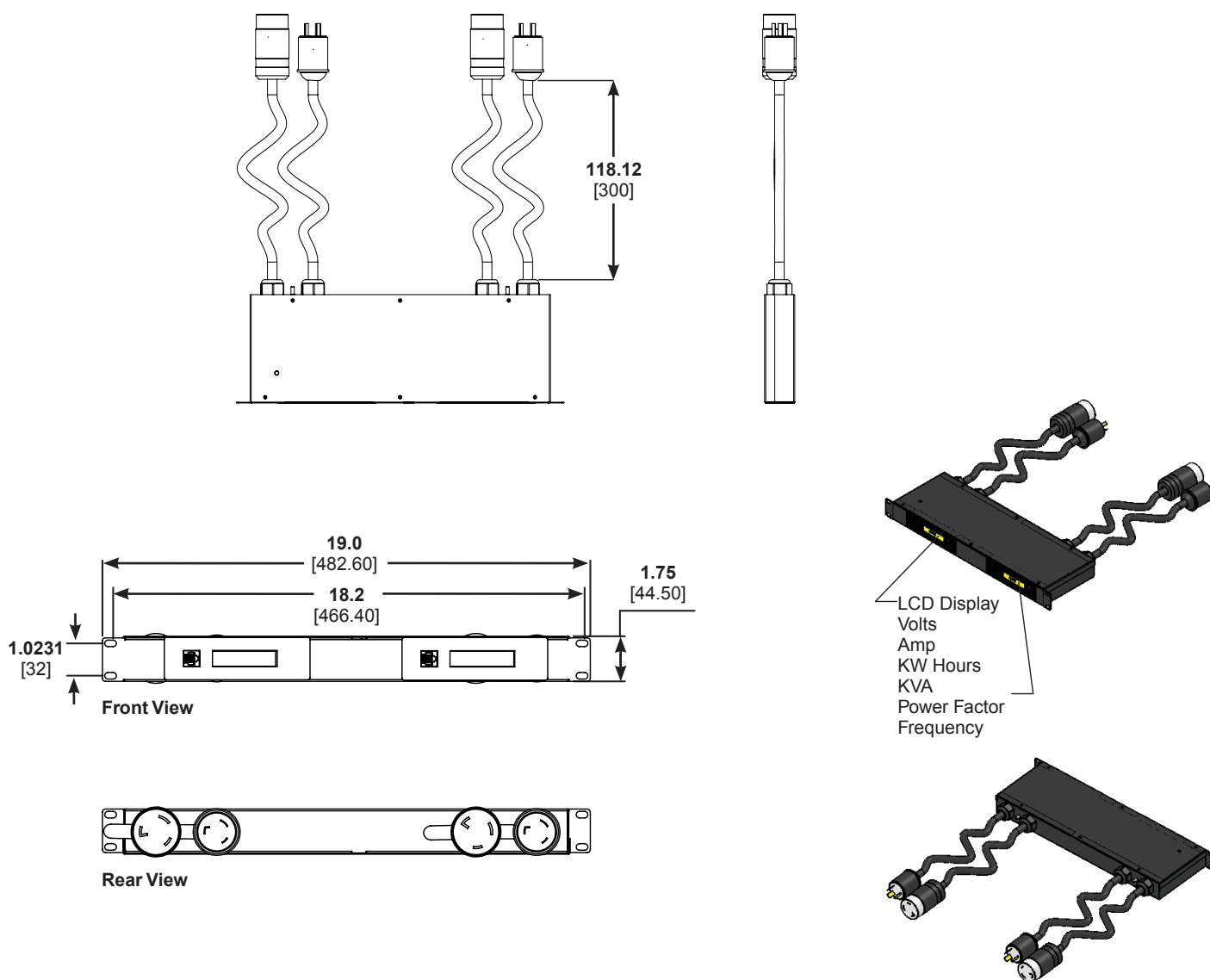

Dimensions are in inches. [Dimensions in brackets are metric].

# SmartZone™ 1RU Inline Meter

## commando plug

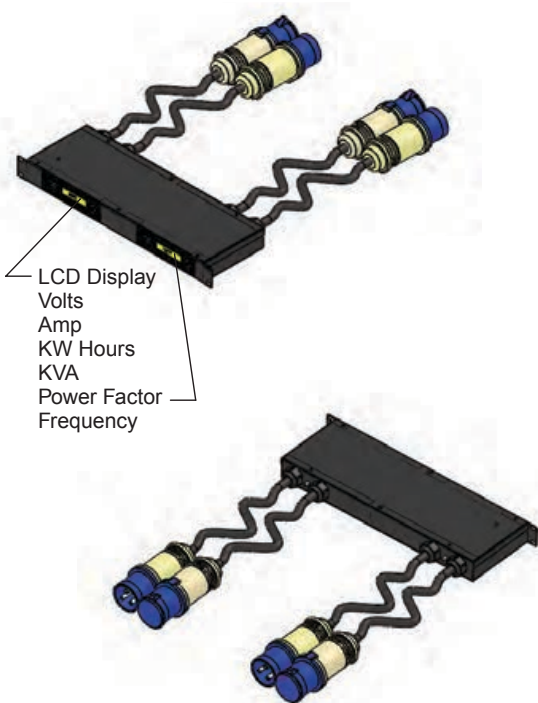
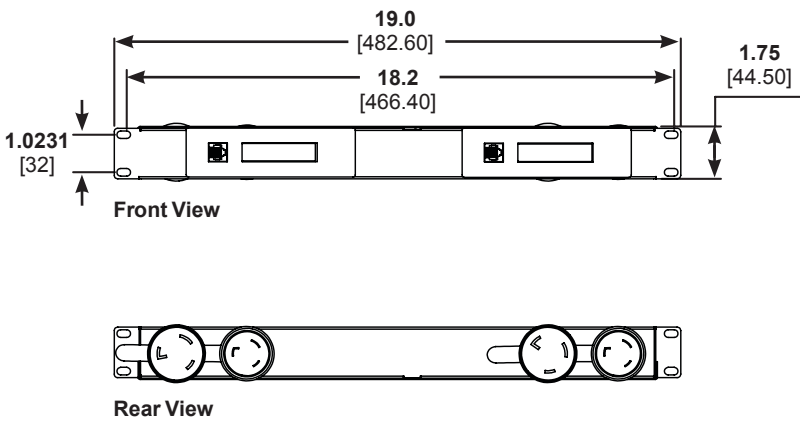
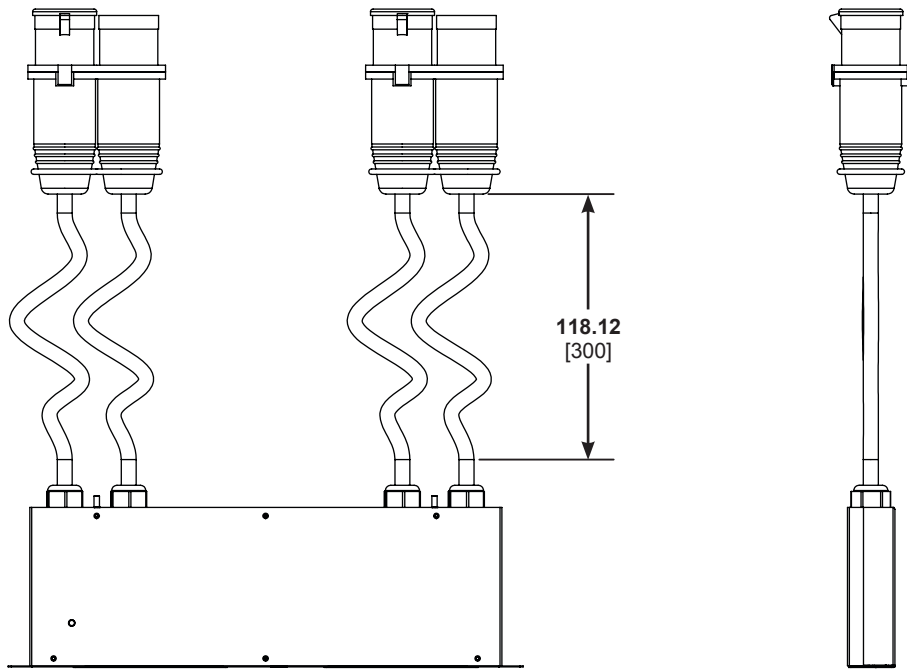

Dimensions are in inches. [Dimensions in brackets are metric].

World Wide sUBsidi Aries AND sAlEs OFFiCes

PANdUit CANAdA  
Markham, Ontario  
cs-cdn@panduit.com  
Phone: 800.777.3300

PANdUit eUr OPe l t d .  
l ondon, UK  
cs-emea@panduit.com  
Phone: 44.20.8601.7200

PANdUit si NgAPOre Pte . l t d .  
r epublic of singapore  
cs-ap@panduit.com  
Phone: 65.6305.7575

PANdUit JAPAN  
tokyo, Japan  
cs-japan@panduit.com  
Phone: 81.3.6863.6000

PANdUit l Ati N AMeri CA  
guadalajara, Mexico  
cs-la@panduit.com  
Phone: 52.33.3777.6000

PANdUit AUstr Ali A Pt Y. l t d .  
victoria, Australia  
cs-aus@panduit.com  
Phone: 61.3.9794.9020

For a copy of Panduit product warranties, log on to [www.panduit.com/warranty](http://www.panduit.com/warranty)

f or more information

Visit us at [www.panduit.com](http://www.panduit.com)

contact customer Service by email: [cs@panduit.com](mailto:cs@panduit.com)  
or by phone: 800.777.3300

**PANDUIT®**

©2014 Panduit Corp.  
All rights reserved.  
pVSp97--WW-enG  
9/2014