

Legacy® Series Integrated Positioning System

MEDIUM DUTY, INDOOR/OUTDOOR, COAXITRON® COMPATIBLE

Product Features

- Indoor/Outdoor Operation
- RediLINK® Quick-Connect Feature
- Delrin® Worm Gear Drives
- Optional Preset Positioning and 360° Pan Rotation
- Gold-Plated Pin Connectors Ensure Reliable Contact
- Prewired, Internal Feedthrough
- Easily Removed Clamshell Covers
- Bottom-Opening Wall Mount Houses Integral Receiver
- Receiver Offers Adjustable Lens Voltages, Selectable Camera Voltages NTSC or PAL Video, Transient Suppression Circuit Protection, and Auto/Random Scan as Standard Features



LEGACY PT780 PAN/TILT
AND EH4718L ENCLOSURE

The **Legacy® Series** is an innovative system of “building block” components designed to simplify installation and system design. System components include an enclosure, pan/tilt, receiver, and wall mount.

The mechanical and electrical components of the **Legacy Series** feature RediLINK® quick-connectors making assembly fast and effortless. It's so easy, the basic system can be assembled in a matter of minutes.

Select the **Legacy** model pan/tilt and enclosure to create the basic system. Then, select an appropriate receiver and mount to complete the system package. Models are available with optional heater, defroster, blower, thermal insulation, and sun shroud.

The **Legacy Series** pan/tilt is capable of handling loads up to 52 pounds (23.6 kilograms) and features gold-plated electrical pin connectors to ensure reliable contact and smooth operation. The pan/tilt also features a Delrin® worm gear that requires no lubrication, is corrosion resistant, and ensures long life. Limit stops are internally adjustable. Available in fixed or variable speed models, options for the pan/tilt include preset positioning, heater blanket, and 360-degree pan positioning. The pan/tilt is prewired for internal feedthrough for all enclosure and camera functions.

The **Legacy** enclosure features a rear-opening, front-hinged lid with gas strut, adjustable camera sled, tilt table, blower, and heater. Enclosure options include defroster, thermal insulation, and sun shroud.

The receivers in the **Legacy Series** have a simple three-wire power connection with on/off switch that supplies power to the entire system. Choose from fixed or variable speed models, with or without presets, for 120/24/230 VAC applications. All models are compatible with Coaxitron® control systems and Pelco RS-422 control systems utilizing Pelco D or Pelco P protocols.

The **Legacy** wall mount is constructed from aluminum and meets NEMA Type 4 standards. The mount opens from the bottom for easy access and installation of the **Legacy Series** receiver. The mount can also be used for pole, corner, and parapet applications when used with the appropriate adapter.

An optional infrared illuminator is available for nighttime viewing. Pan rotation of the pan/tilt, however, will be limited by the amount of slack in the power cord for the illuminator.



by **Schneider Electric**

International Standards
Organization Registered Firm;
ISO 9001 Quality System



C342 / REVISED 3-24-11

TECHNICAL SPECIFICATIONS

Pan/Tilt

MECHANICAL

Pan Rotation	Movement in horizontal plane
SL Models Only	0 to 360°
All Others	0 to 355°
Pan Speed	
VS Models Only	1 to 17°/sec ±1° (maximum load condition)
All Others	9°/sec ±1°
Tilt Rotation	90° down from horizontal; 60° up from horizontal
Tilt Speed	
VS Models Only	1 to 4°/sec ±0.5° (maximum load condition)
All Others	3°/sec ±0.5°
Torque Output	
VS Models Only	18.3 ft-lb (24.8 N-m) at rated voltage and 75°F (23°C)
All Others	23.8 ft-lb (32.3 N-m) at rated voltage and 75°F (23°C)
Maximum Load	
VS Models Only	40 lb (18.14 kg) at specified torque
All Others	52 lb (23.55 kg) at specified torque
Pan/Tilt Drive System	Delrin® worm gear; ground and polished stainless steel worm
Pan/Tilt Bearings	Roller thrust bearings and bronze Oilite bushings
Lubricants	
Bearings	NLGI #2; lithium complex grease fortified with molybdenum
Chain	Teflon chain lubricant, such as Tri-Flow®
Braking	Friction

ELECTRICAL

Input Voltage	120 VAC or 24 VAC, 50/60 Hz
	12 VDC (VS models)
VA Required	(At specified input voltage)
	<u>120 VAC</u> <u>24 VAC</u> <u>12 VDC</u>
Pan	19.2 VA 21.6 VA 17.04 VA
	(0.16 A) (0.9 A) (1.42 A)
Tilt	32.4 VA 24 VA 12.48 VA
	(0.27 A) (1 A) (1.04 A)
Total	51.6 VA 45.6 VA 29.52 VA
	(0.43 A) (1.9 A) (2.46 A)
Maximum Current	2 A per conductor (SL models only)
Connectors	Amp CPC type, mate supplied (37 pins)
Motor Type	
VS Models Only	12 VDC continuous duty; DC permanent magnet
All Others	Single phase, instantaneous reversing, induction type; 120 VAC or 24 VAC, 50/60 Hz, impedance protected; 50% duty cycle; 30 minute rating
Limit Switches	5 A, 250 VAC maximum; internal adjustment
Pan/Tilt Conductor Requirements	
Standard Model	20 unshielded, plus video and camera sync coaxial*
Standard with /PP	27 unshielded, plus video and camera sync coaxial*
Standard with /SL	14 unshielded, plus video and camera sync coaxial*
Standard with SL/PP	20 unshielded, plus video and camera sync coaxial*

Note: Two additional conductors may be required with /HB option.

Cable Distances†

PT780P Series	<u>6 Conductors</u>	<u>7 Conductors‡</u>
20 AWG (0.5 mm²)	1,370 ft (417 m)	2,745 ft (836 m)
18 AWG (1.0 mm²)	2,180 ft (664 m)	4,370 ft (1,331 m)
16 AWG (1.5 mm²)	3,470 ft (1,057 m)	6,940 ft (2,115 m)
PT780-24P Series		
20 AWG (0.5 mm²)	59 ft (17.98 m)	118 ft (35.96 m)
18 AWG (1.0 mm²)	94 ft (28.65 m)	188 ft (57.30 m)
16 AWG (1.5 mm²)	149 ft (45.41 m)	298 ft (90.83 m)
PT780-VS Series	<u>5 Conductors</u>	
20 AWG (0.5 mm²)	24 ft (7.3 m)	
18 AWG (1.0 mm²)	38 ft (11.58 m)	
16 AWG (1.5 mm²)	60 ft (18.28 m)	

GENERAL

Construction	Aluminum exterior; painted steel and aluminum interior parts
Pan/Tilt	Delrin, premium performance acetal
	Ground and polished stainless steel
Worm Gear	Indoor/outdoor
Worm	–10°F to 140°F (–23°C to 60°C)
Environment	21.5 lb (9.7 kg) approximate
Ambient Temperature	25.0 lb (11.3 kg) approximate
Weight	
Shipping Weight	

CERTIFICATIONS/RATINGS (Pan/Tilt Only)

- CE, Class B
- Meets NEMA Type 3R and IP54 standards

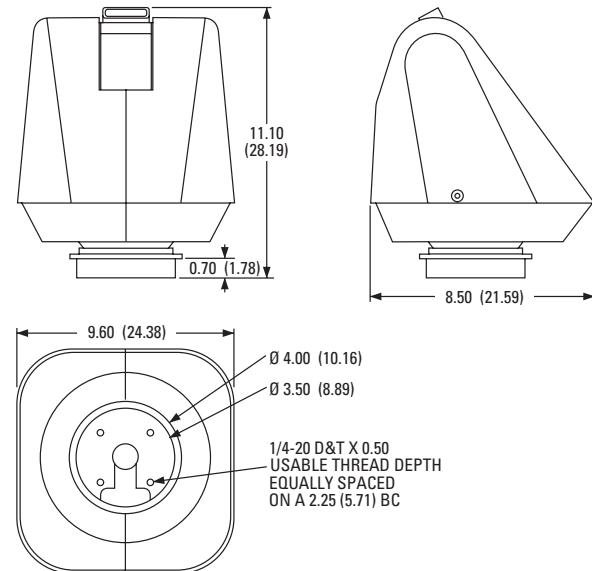

NOTE: VALUES IN PARENTHESES ARE CENTIMETERS; ALL OTHERS ARE INCHES.

LEGACY PT780 SERIES PAN/TILT

*Including safety ground

† Cable distances are based on:

- 26.4 V AC output voltage from controller (24 VAC models) or 132 V AC output voltage from controller (120 VAC models) or 12 VDC output voltage from controller (12 VDC models), and
- 10% cable loss with both motors (pan/tilt) running simultaneously.

‡ Using 2-wire motor common

TECHNICAL SPECIFICATIONS

Enclosure

MECHANICAL

Camera Mounting

Removable camera sled. Can be inverted to accommodate various cameras and lenses.

Latches

Link-lock No. 3, stainless steel. EH4700L Series (1); EH5723L Series (2). Latches can be secured with padlock of suitable size (not supplied).

ELECTRICAL

Input Voltage

24, 120, or 230 VAC, 50/60Hz

Electrical

Connection

Connectors for input power, camera, lens and accessories;
BNC for video;
BNC for camera synchronization;
26-pin RediLINK D-type connector (links enclosure to pan/tilt)

Power Consumption

Heater (-1 models)
Heater (-2 models)
Heater (-3 models)
Defroster
Blower (-1 models)
Blower (-2 models)
Blower (-3 models)

	EH4700L	EH5723L
Heater (-1 models)	60 W	90 W
Heater (-2 models)	50 W	50 W
Heater (-3 models)	55 W	70 W
Defroster	15 W	30 W
Blower (-1 models)	8 W	15 W
Blower (-2 models)	8 W	10 W
Blower (-3 models)	8 W	15 W

Heater/defroster activates on at 42° to 58°F (6° to 14°C) and off at 72 to 88°F (22° to 31°C); blower activates on at 77° to 93°F (25° to 34°C) and off at 62° to 78°F (17° to 26°C)

GENERAL

Maximum Camera and Lens Size

EH4718L-1/-2/-3

EH4722L-2

EH5723L-1/-2/-3

Accepts camera and lens combinations* (including BNC connector) up to:
13.00" L x 4.75" W x 4.25" H
(33.02 x 12.07 x 10.80 cm)
17.00" L x 4.75" W x 4.25" H
(43.18 x 12.07 x 10.80 cm)
15.50" L x 6.25" W x 5.50" H
(39.37 x 15.88 x 13.97 cm)

Viewing Window

Glass, 0.25-inch (6.35 mm) thick

Viewing Window Area

EH4700L Series

EH5723L

3.50" H x 4.00" W (8.89 x 10.16 cm)
4.25" H x 5.25" W (10.79 x 13.34 cm)

Construction

Die-cast, extruded, and sheet aluminum

Finish

Gray polyester powder coat

Environment

Indoor/outdoor (-10° to 120°F)

Weight

Unit Shipping

EH4718L-1/-2/-3

8.50 lb (3.8 kg) 12.00 lb (5.4 kg)

EH4722L-2

9.75 lb (4.4 kg) 13.00 lb (5.9 kg)

EH5723L-1,-2,-3

14.00 lb (6.4 kg) 16.00 lb (7.3 kg)

*Assumes lens is fully extended.

LEGACY® SERIES ENCLOSURE

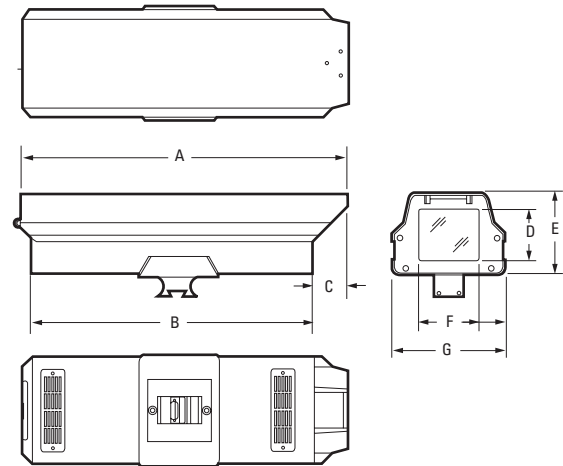

	EH4718L	EH4722L	EH5723L
A	21.20 (53.84)	25.20 (64.00)	26.50 (67.31)
B	18.30 (46.48)	22.30 (56.64)	23.00 (58.42)
C	2.25 (5.72)	2.25 (5.72)	3.06 (9.15)
D	3.50 (8.89)	3.50 (8.89)	4.25 (10.79)
E	6.70 (17.02)	6.70 (17.02)	8.09 (20.54)
F	4.00 (10.16)	4.00 (10.16)	5.25 (13.34)
G	7.25 (18.42)	7.25 (18.42)	8.98 (22.80)

NOTE: VALUES IN PARENTHESES ARE CENTIMETERS; ALL OTHERS ARE INCHES.

CERTIFICATIONS/RATINGS (Enclosure Only)

- CE, Class B (EH4718L-2, EH4718L-3, EH4722L-2, EH5723L-2 and EH5723L-3)
- C-Tick
- Meets NEMA Type 3R and IP54 standards

MODEL NUMBERS

MODELS

ENCLOSURES

EH4718L-1	Legacy environmental enclosure, 18-inch (45.72 cm) lower body length, 120 VAC heater and blower
EH4718L-2	Same as EH4718L-1 except supplied with 24 VAC heater and blower
EH4718L-3	Same as EH4718L-1 except supplied with 230 VAC heater and blower
EH4722L-2	Legacy environmental enclosure, 22-inch (55.88 cm) lower body length, 24 VAC heater and blower
EH5723L-1	Legacy environmental enclosure, 23-inch (58.42 cm) lower body length, 120 VAC heater and blower
EH5723L-2	Same as EH5723L-1 except 24 VAC heater and blower
EH5723L-3	Same as EH5723L-1 except 230 VAC heater and blower

PAN/TILTS

PT780P/PP	Medium duty, indoor/outdoor pan/tilt with RediLINK connector and preset positioning option, 120 VAC
PT780-VS/PP	Medium duty, indoor/outdoor variable speed pan/tilt with preset positioning option, 12 VDC
PT780-VSSL	Medium duty, indoor/outdoor variable speed pan/tilt with 360° pan rotation, 12 VDC
PT780-VSSL/PP	Same as PT780-VSSL except with preset positioning option
PT780-24P	Medium duty, indoor/outdoor pan/tilt with RediLINK connector, 24 VAC
PT780-24P/PP	Same as PT780-24P except with preset positioning option
PT780-24SL	Same as PT780-24P except unit is capable of 360° pan rotation
PT780-24SL/PP	Same as PT780-24SL except with preset positioning option

Note: Legacy systems (enclosure, pan/tilt, receiver, mount, camera and lens) are available. Consult the factory for available configurations.

OPTIONAL ACCESSORIES

ENCLOSURE

O/I-LPP	Preset position lens wiring harness
O/I-OUTLET	120 VAC electrical outlet
SS4718	Sun shroud for EH4718L Series
SS4722	Sun shroud for EH4722L Series
SS5723	Sun shroud for EH5723L Series
TI47	Thermal insulation for EH4700L Series
TI57	Thermal insulation for EH5723L Series
WD47-1	Window defroster for EH4700L Series, 120 VAC, 15 W
WD47-2	Window defroster for EH4700L Series, 24 VAC, 15 W
WD47-3	Window defroster for EH4700L Series, 230 VAC, 15 W
WD57-1	Window defroster for EH5723L Series, 120 VAC, 30 W
WD57-2	Window defroster for EH5723L Series, 24 VAC, 30 W
WD57-3	Window defroster for EH5723L Series, 230 VAC, 30 W

PAN/TILT

HB1*	Heater blanket, 120 VAC, 40 W (0.33 A) Allows operation to -50°F (-45°C) Thermostatically controlled; activates on at 40°F (4°C) and off at 60°F (15°C)
HB2*	Same as HB1 except 24 VAC, 40 W (1.7 A)
HB3*	Same as HB1 except 230 VAC, 40 W (0.17 A)

*Factory installed options only. Please consult factory.

LEGACY RECEIVERS

LRD41A11-1	Fixed speed, Coaxitron receiver for use with LWM41 wall mount; 120 VAC
LRD41C21 Series	Fixed speed, Coaxitron/RS-422 receiver with presets for use with LWM41 wall mount; 120/24/230 VAC
LRD41C22 Series	Variable speed, Coaxitron/RS-422 receiver with presets for use with LWM41 wall mount; 120/24/230 VAC
LRD41C-CONNKIT	Connector kit for LRD41C21/LRD41C22 Series receiver; required to enable the Aux/Alarm capabilities of the receiver
LRD41TLC	Receiver plug-in testing module

RECOMMENDED MOUNTS

LWM41	Wall mount; use with/without optional integral Legacy receiver
PM2000, PM2010	Ceiling/pedestal mount
CM400	Corner adapter for LWM41 wall mount
PA2000	Pan/tilt adapter for PM2000/PM2010 mounts
PA402	Pole adapter for LWM41 wall mount
PP400	Parapet adapter (wall) for LWM41 wall mount
PP4348	Parapet adapter (rooftop) for LWM41 wall mount

MISCELLANEOUS ACCESSORIES

LL27 Series	Infrared illuminator (power cord restricts pan rotation of pan/tilt)
LL27LM	Mounting bracket for LL27 Series illuminator

Pelco by Schneider Electric

3500 Pelco Way, Clovis, California 93612-5699 United States

USA & Canada Tel (800) 289-9100 Fax (800) 289-9150

International Tel +1 (559) 292-1981 Fax +1 (559) 348-1120

www.pelco.com

Pelco, the Pelco logo, and other trademarks associated with Pelco products referred to in this publication are trademarks of Pelco, Inc. or its affiliates. All other product names and services are the property of their respective companies. Product specifications and availability are subject to change without notice.

©Copyright 2011, Pelco, Inc. All rights reserved.